



40 Birchwood Road, Scunthorpe, DN16 3HS

£210,000

This three bed semi detached house is in a popular location, has a great open plan kitchen diner and is ready for moving straight in to! The ground floor of the property compromises of an entrance hall, a lounge and downstairs W.C., whilst upstairs there are two double bedrooms, a single bedroom and a four piece family bathroom. Outside has off road parking for a couple of cars, a secure rear garden and a detached garage. Vacant and ready for viewings immediately, please contact us to book yours!



Entrance hall



Bedroom two 11'0" x 11'4" (3.37 x 3.46)



Kitchen diner 18'11" x 17'6" (5.78 x 5.34)



Bedroom three 8'8" x 6'10" (2.66 x 2.10)



Lounge 12'2" x 12'2" (3.73 x 3.71)



Downstairs W.C.

First Floor Landing

Bedroom one 11'11" x 11'3" (3.64 x 3.45)



Bathroom 14'0" x 9'3" max (4.28 x 2.84 max)



Garage

Outside



Ground Floor

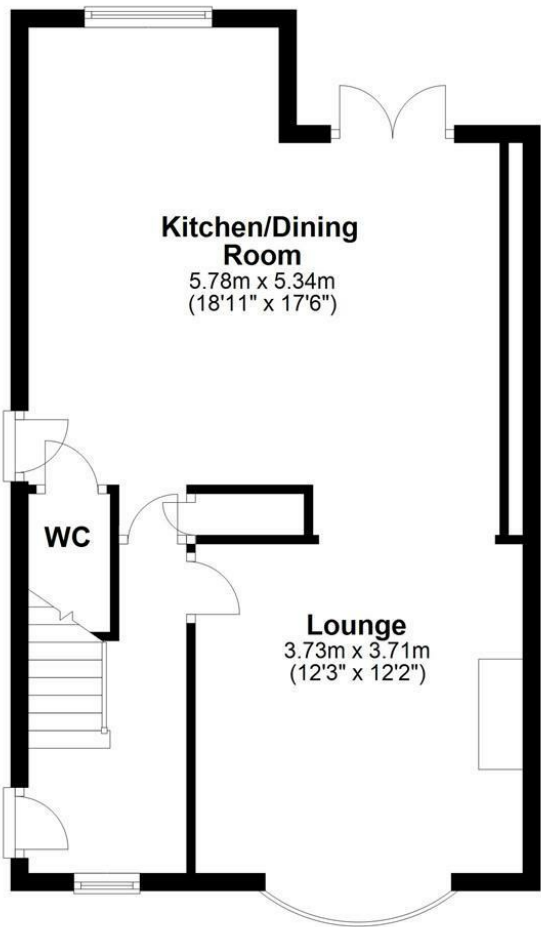

Total area: approx. 97.9 sq. metres (1053.8 sq. feet)

Area Map

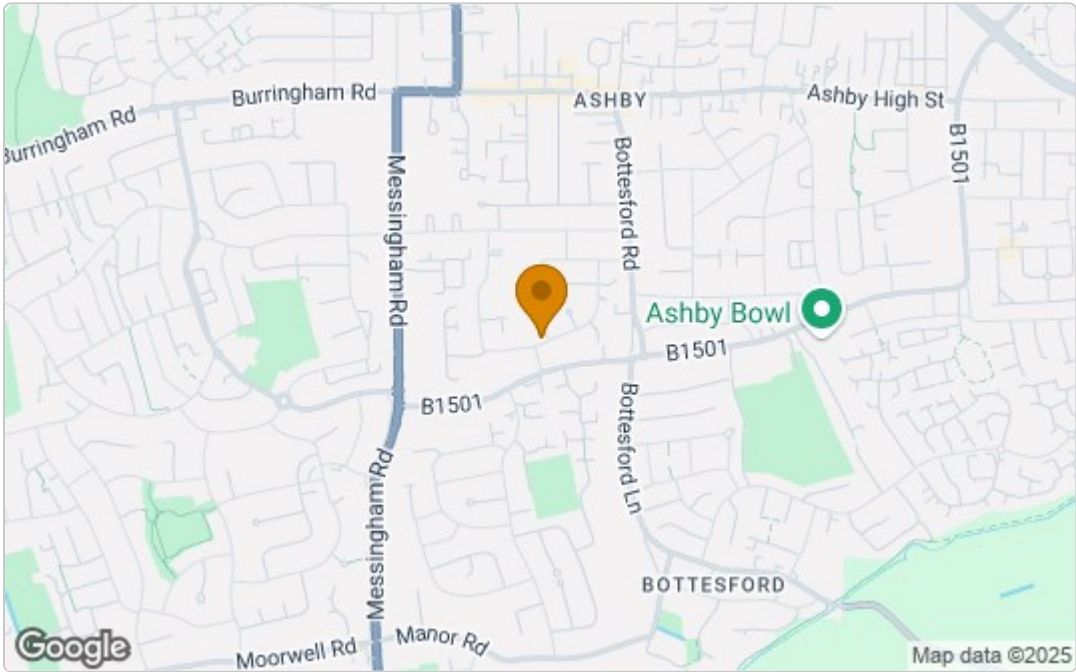

Energy Efficiency Graph

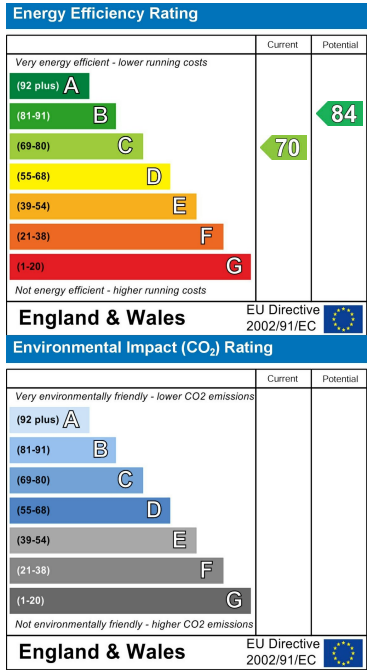

These particulars, whilst believed to be accurate are set out as a general outline only for guidance and do not constitute any part of an offer or contract. Intending purchasers should not rely on them as statements of representation of fact, but must satisfy themselves by inspection or otherwise as to their accuracy. No person in this firms employment has the authority to make or give any representation or warranty in respect of the property.