

54 Cornfield Way, Scunthorpe, DN15 9FG

£136,000

Really lovely three bed semi detached house in the popular Meadow Croft estate in Winterton. The property has modern decor throughout and is ready for moving straight in to. It is a part of the Discount Market Sale Scheme, which means it's available at a discounted price (80% of market value). This property is a great opportunity to get your foot on the housing ladder and viewings are available now, so to book in please give us a call!

The ground floor comprises of an entrance hall, good size lounge that overlooks the rear garden, contemporary kitchen diner and a downstairs W.C., whilst upstairs there are two double bedrooms, a further single bedroom and a neutral family bathroom. Outside the property there is an off road parking space and a secure rear lawned garden.

\*The discount market scheme means you will own 100% of the house with no rent to pay or any other hidden fees. There's certain criteria that you need to meet to be eligible for the scheme, for further information on this please get in touch.

Entrance hall

Kitchen diner 16'2" x 10'2" (4.95 x 3.12)



Lounge 10'10" x 13'7" (3.31 x 4.15)



Downstairs W.C.

First Floor Landing

Bedroom one 8'3" x 13'7" (2.52 x 4.15)



Bedroom two 12'5" x 7'2" (3.81 x 2.20)



Bedroom three 9'0" x 6'0" (2.76 x 1.85)



Bathroom 6'0" x 7'2" (1.84 x 2.20)



Outside





Ground Floor

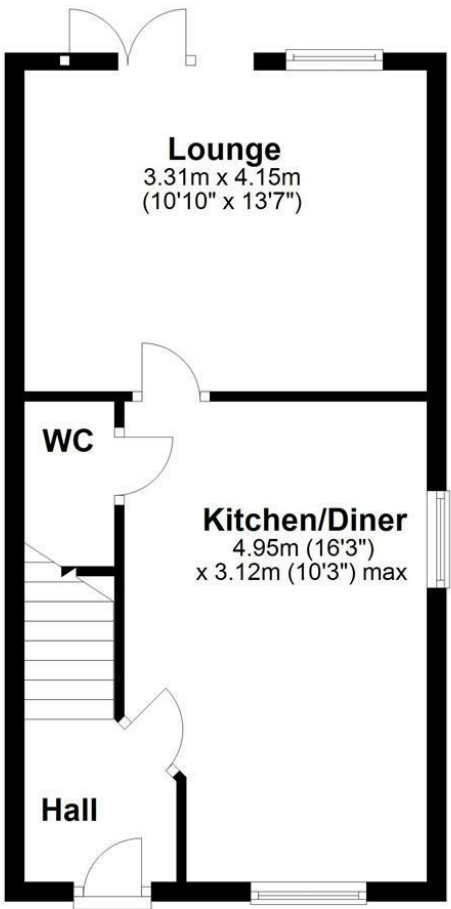

Total area: approx. 69.5 sq. metres (747.9 sq. feet)

Area Map



Energy Efficiency Graph

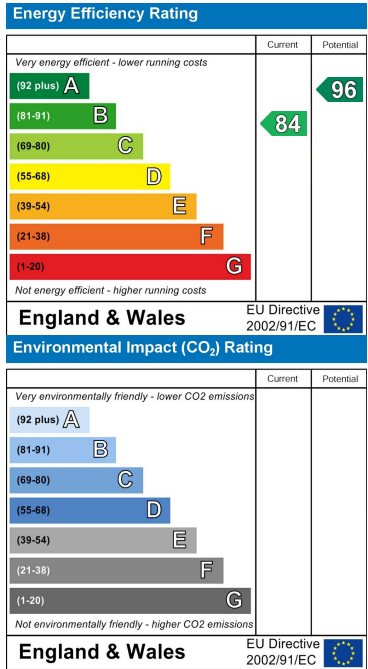

These particulars, whilst believed to be accurate are set out as a general outline only for guidance and do not constitute any part of an offer or contract. Intending purchasers should not rely on them as statements of representation of fact, but must satisfy themselves by inspection or otherwise as to their accuracy. No person in this firms employment has the authority to make or give any representation or warranty in respect of the property.