



111 Shipton Road, Scunthorpe, DN16 3HJ

£160,000

A two bed detached bungalow in Ashby sat on a great corner plot, offered with no onward chain. This one is close to local amenities and comprises of an entrance, neutral kitchen leading onto the conservatory, good size lounge, two double bedrooms and a bathroom. The property would be ideal for single individuals and people looking to retire/downsize. Outside there is a lawned garden to the side of the property and to the rear is a patio area, there is also off road parking for a couple of cars and a garage. Available for viewings now, please call the office to book your appointment.

Entrance



Bedroom one 12'11" x 8'11" (3.94 x 2.74)



Lounge 15'0" x 10'11" (4.59 x 3.34)



Bedroom two 9'11" x 8'9" (3.04 x 2.69)



Kitchen 11'1" x 9'11" (3.39 x 3.04)



Bathroom 6'11" x 5'6" (2.12 x 1.69)



Conservatory 11'5" x 6'10" (3.50 x 2.09)



Garage 21'6" x 8'2" (6.56 x 2.50)

Outside



Floor Plan

GROUND FLOOR
838 sq.ft. (77.9 sq.m.) approx.

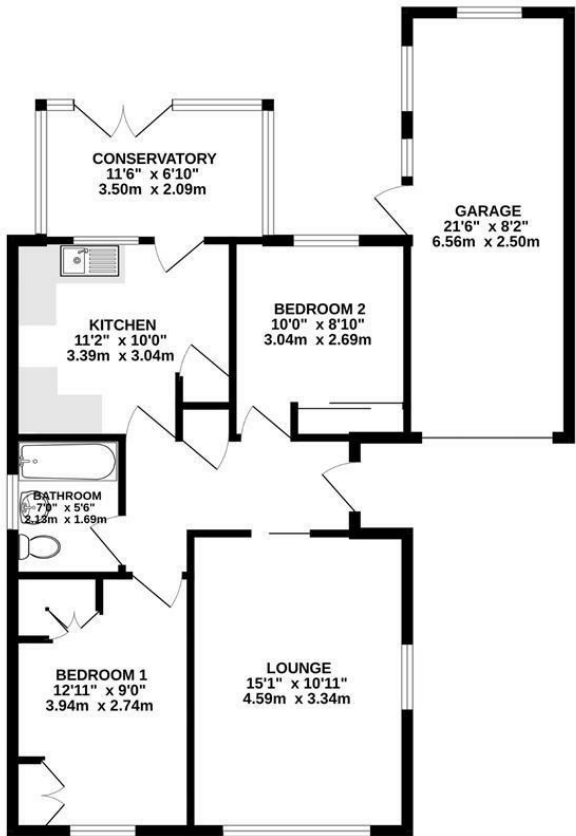

TOTAL FLOOR AREA: 838 sq.ft. (77.9 sq.m.) approx.
Whilst every attempt has been made to ensure the accuracy of the floorplan contained here, measurements of doors, windows, rooms and any other items are approximate and no responsibility is taken for any error, omission or mis-statement. This plan is for illustrative purposes only and should be used as such by any prospective purchaser. The services, systems and appliances shown have not been tested and no guarantee as to their operability or efficiency can be given.
Made with Metropix ©2025



Area Map

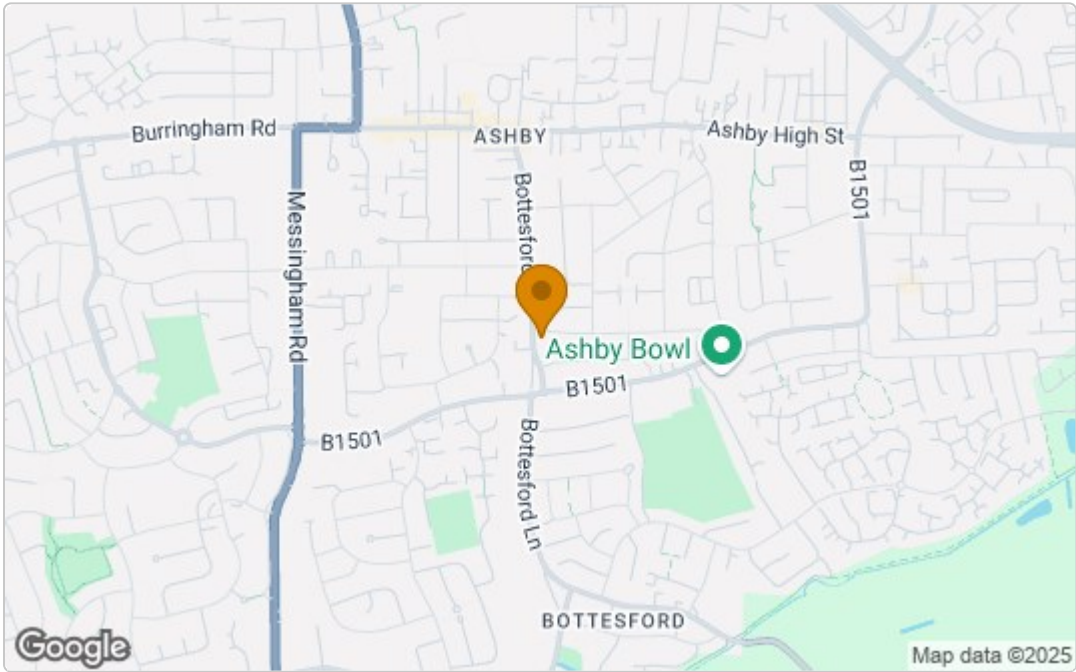

Energy Efficiency Graph

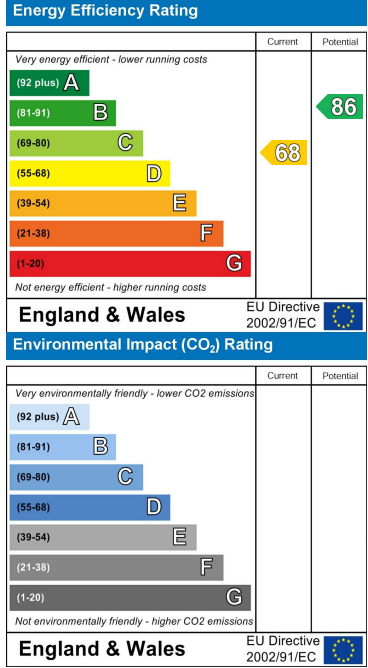

These particulars, whilst believed to be accurate are set out as a general outline only for guidance and do not constitute any part of an offer or contract. Intending purchasers should not rely on them as statements of representation of fact, but must satisfy themselves by inspection or otherwise as to their accuracy. No person in this firms employment has the authority to make or give any representation or warranty in respect of the property.