



41 Cambridge Avenue, Scunthorpe, DN16 3PH

£169,950

Immaculately presented, two bed semi detached bungalow in the popular area of Bottesford. Close to local amenities and bus routes, the property would be ideal for single individuals and people looking to retire/downsize. The property comprises of an entrance, neutral kitchen, good size lounge with fireplace, two double bedrooms and a modern shower room. Outside there is a low maintenance rear garden mainly laid with turf, off road parking and a garage. Available for viewings now, please call the office to book your appointment.



Kitchen 13'5" x 15'1" (4.09 x 4.60)



Bedroom two 8'9" x 9'0" (2.68 x 2.76)



Lounge 17'10" x 11'9" (5.45 x 3.60)



Garage 15'8" x 7'10" (4.80 x 2.41)

Outside



Shower room 5'9" x 5'4" (1.76 x 1.65)



Bedroom one 11'8" x 10'1" (3.58 x 3.09)



Floor Plan

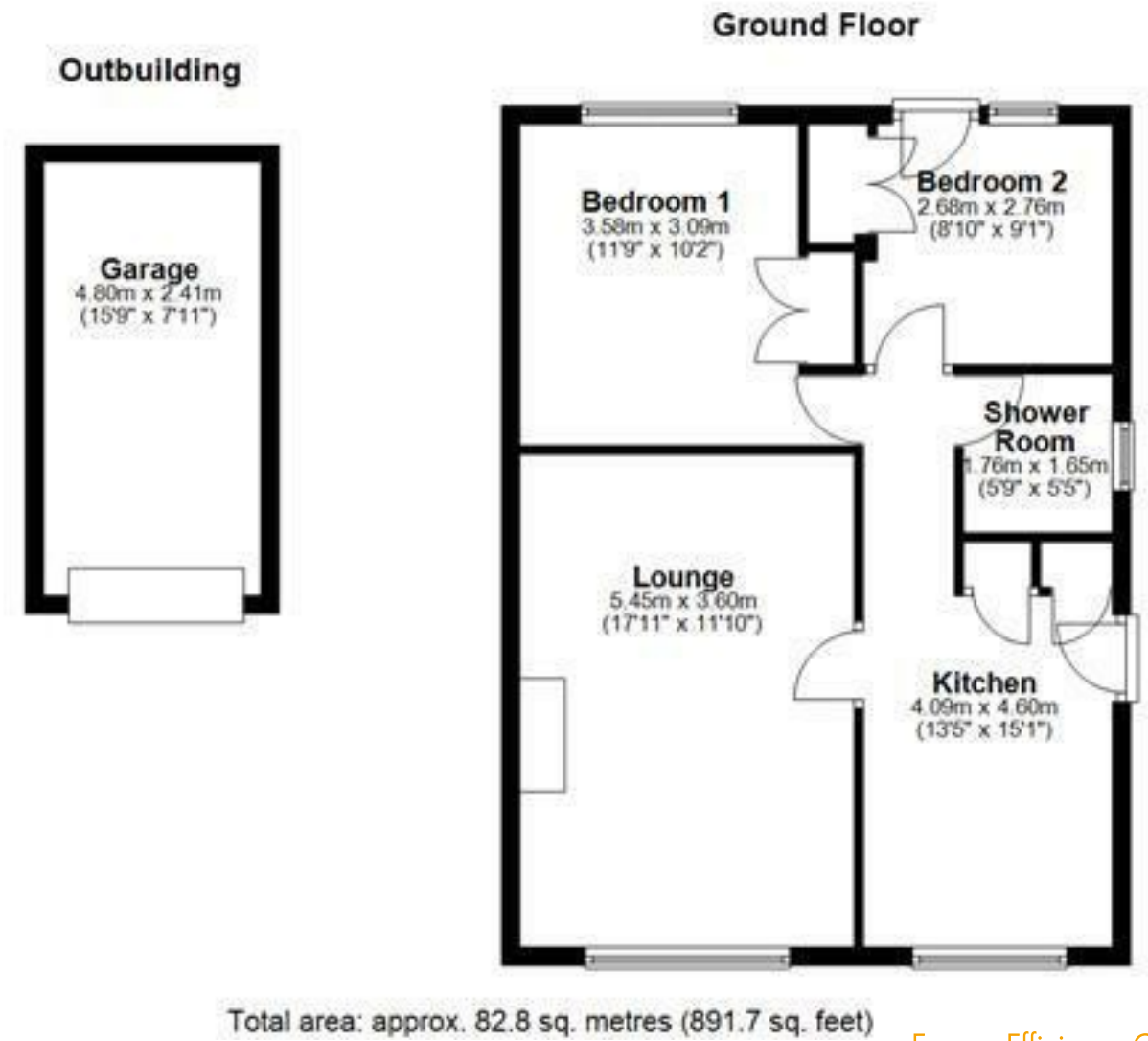

Area Map

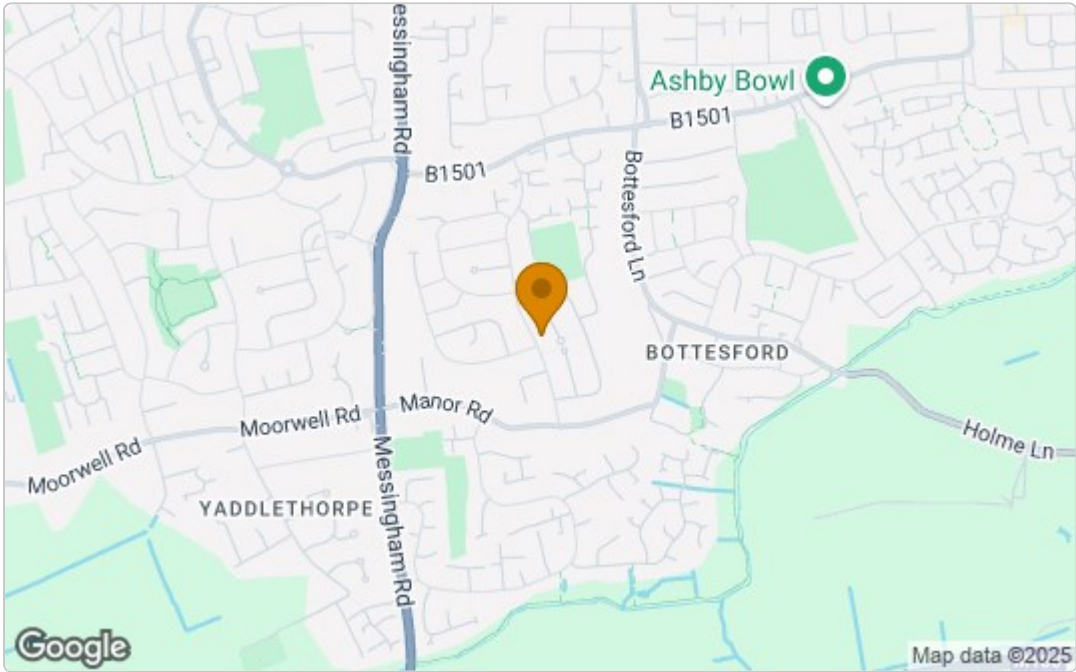

Energy Efficiency Graph

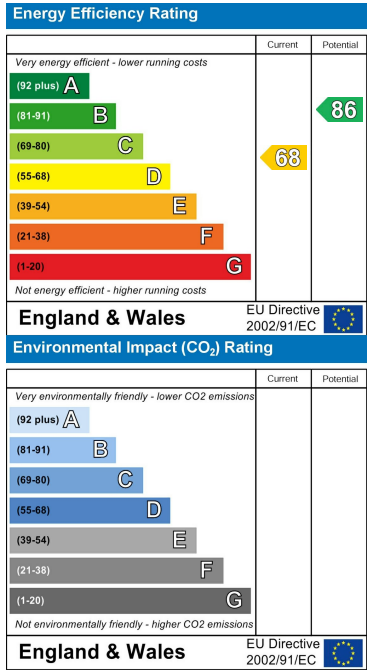

These particulars, whilst believed to be accurate are set out as a general outline only for guidance and do not constitute any part of an offer or contract. Intending purchasers should not rely on them as statements of representation of fact, but must satisfy themselves by inspection or otherwise as to their accuracy. No person in this firms employment has the authority to make or give any representation or warranty in respect of the property.