



1 Alpina Close, Scunthorpe, DN16 3FU

£325,000

An immaculate home on the sought after Burdock Gardens estate, perfect for families and sat in great school catchments. Built by Keigar homes this home downstairs consists of a lounge, kitchen diner which leads onto the sun room, separate utility room and W.C. Upstairs there are four good size bedrooms, the master having an en suite and a family bathroom.

Outside there is a rear garden with turf and a patio area. To the front of the property there is blocked paved off road parking for a couple of cars and access to the integral garage. Viewings are available by appointment, please contact us to book yours!



Entrance hall 13'0" x 5'9" (3.98 x 1.76)



Sun room 9'11" x 11'1" (3.03 x 3.38)



Lounge 15'5" x 11'0" (4.72 x 3.36)



Garage 15'8" x 9'1" (4.78 x 2.78)

Bedroom one 13'1" x 11'0" (4.01 x 3.36)



Open plan kitchen diner



Utility 8'2" x 5'3" (2.51 x 1.62)



Bedroom two 11'0" x 9'6" (3.36 x 2.91)



W.C.

Bedroom three 9'10" x 6'6" (3.01 x 2.00)

Bedroom four



Bathroom 6'4" x 8'3" (1.95 x 2.54)



En suite 7'3" x 5'9" (2.22 x 1.77)



Outside



Floor Plan

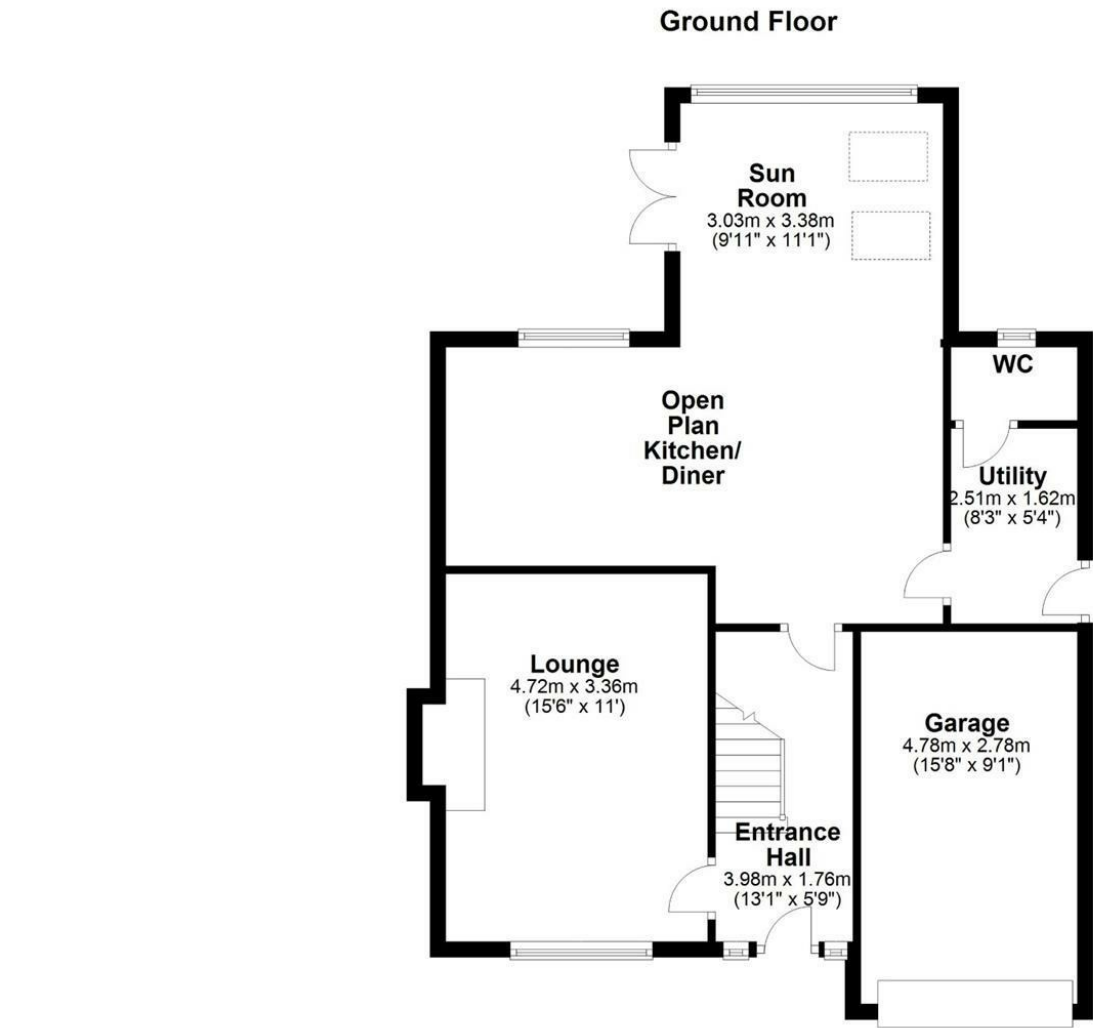

Total area: approx. 133.6 sq. metres (1438.5 sq. feet)

Area Map

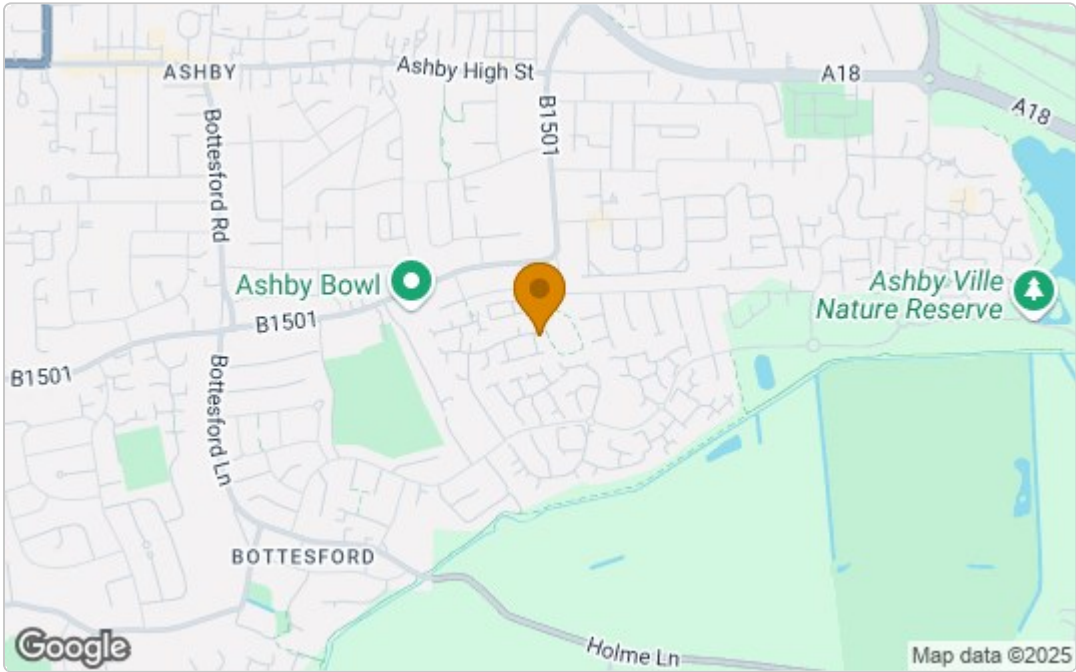

Energy Efficiency Graph

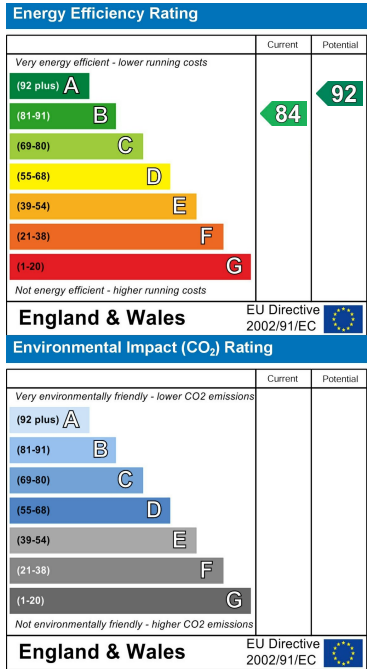

These particulars, whilst believed to be accurate are set out as a general outline only for guidance and do not constitute any part of an offer or contract. Intending purchasers should not rely on them as statements of representation of fact, but must satisfy themselves by inspection or otherwise as to their accuracy. No person in this firm's employment has the authority to make or give any representation or warranty in respect of the property.