



2 Western Green, Scunthorpe, DN15 9NX

£325,000

Sat on a generous corner plot this spacious three bedroom detached property is located in the popular village of Winteringham that has no onward chain. With great room sizes throughout and some lovely characterful features this property is made up of downstairs a lounge with multi-fuel burner, dining room, a great size kitchen with separate pantry, utility and W.C. Upstairs there are three great size bedrooms and a four piece family bathroom. Outside there is a lovely walled garden with turf and block paved drive that goes behind the property for parking for multiple vehicles. Available for viewings now please call the office to book your appointment!

Entrance

Dining room 14'3" x 12'1" (4.36 x 3.69)



Bedroom three 10'9" x 8'9" (3.30 x 2.67)



Bathroom



Kitchen 16'1" x 17'3" (4.92 x 5.26)



Pantry

Utility 6'6" x 6'9" (1.99 x 2.06)

W.C.

Lounge 14'3" x 13'3" (4.36 x 4.06)



Outside



Landing

Bedroom one 14'2" x 13'8" (4.34 x 4.17)



Bedroom two 10'11" x 12'1" (3.35 x 3.70)



Ground Floor

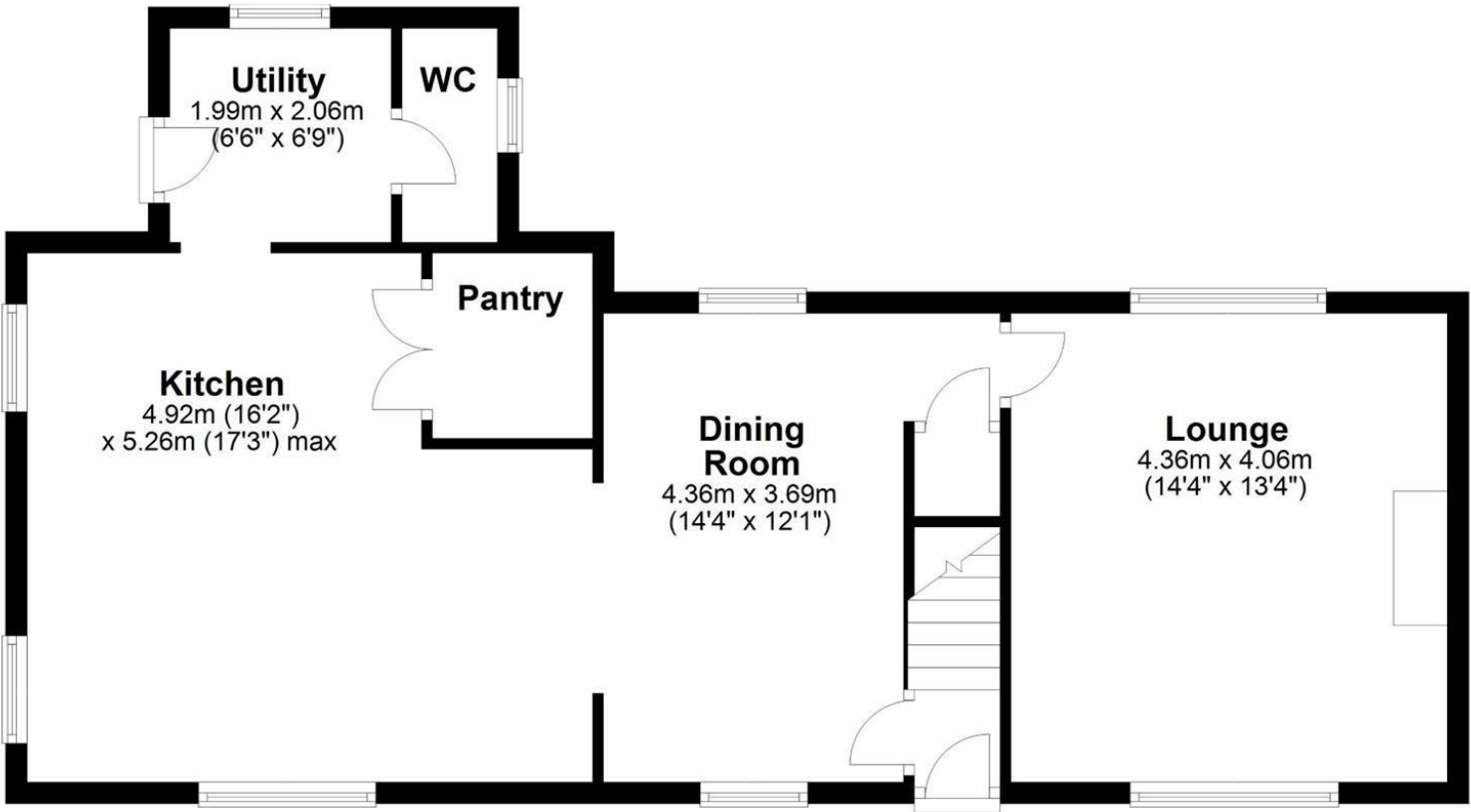

Total area: approx. 126.0 sq. metres (1356.3 sq. feet)

Area Map



Energy Efficiency Graph

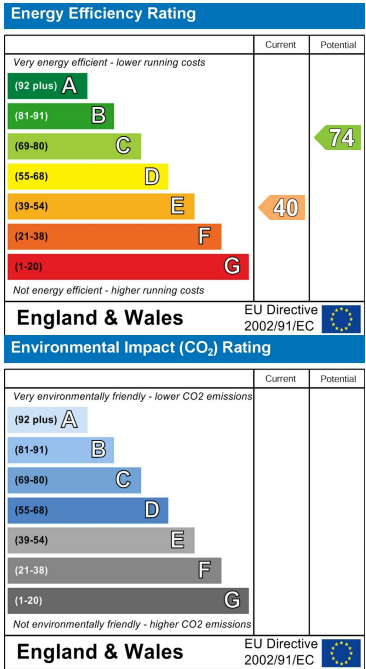

These particulars, whilst believed to be accurate are set out as a general outline only for guidance and do not constitute any part of an offer or contract. Intending purchasers should not rely on them as statements of representation of fact, but must satisfy themselves by inspection or otherwise as to their accuracy. No person in this firm's employment has the authority to make or give any representation or warranty in respect of the property.