



17 Headingley Avenue, Scunthorpe, DN17 2GL

£199,950

Available with no onward chain this three bed detached house is situated on a quiet Cul de sac in the Yaddletorpe area of Bottesford and has stylish modern decor throughout. The property comprises of an open plan kitchen diner, a downstairs W.C. and a good size lounge with floating log burner and double doors that lead in to the conservatory. Upstairs there is a principle bedroom with En suite, two further bedrooms and a stylish family bathroom. Outside the property is a rear tiered lawned garden with patio area and to the front off road parking on a block paved drive with space for two cars. The house also benefits from a new boiler fitted in November 2024. Available to view now!



Entrance

Kitchen 6'6" x 9'9" (2.00 x 2.98)



Dining area 16'9" x 7'10" (5.11 x 2.40)

Downstairs W.C.

Lounge 11'4" x 18'6" (3.47 x 5.65)



Sun room 9'1" x 9'3" (2.77 x 2.83)



First Floor Landing

Bedroom One 9'8" x 12'4" (2.97 x 3.76)



En Suite 5'3" x 5'11" (1.62 x 1.82)



Bedroom Two 11'8" x 8'11" (3.58 x 2.73)



Bedroom Three 8'7" x 9'4" (2.63 x 2.87)



Bathroom 7'4" x 5'11" (2.25 x 1.82)



Outside



Ground Floor

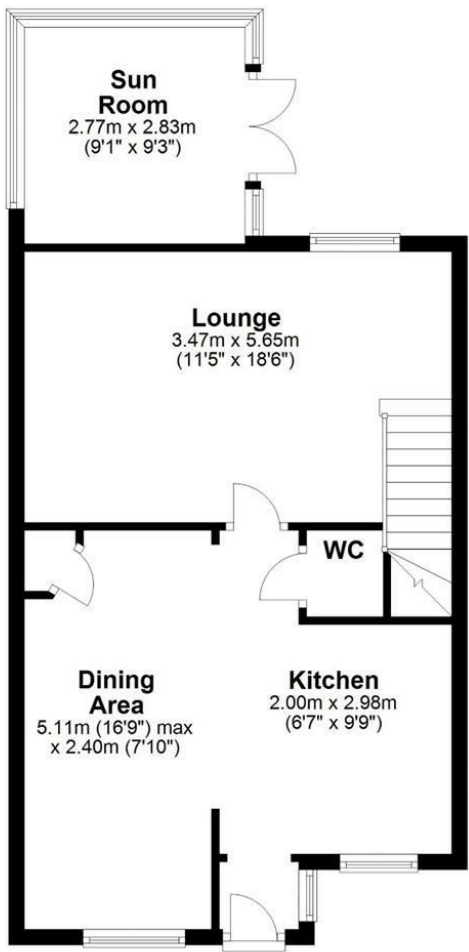

Total area: approx. 99.3 sq. metres (1068.9 sq. feet)

Area Map

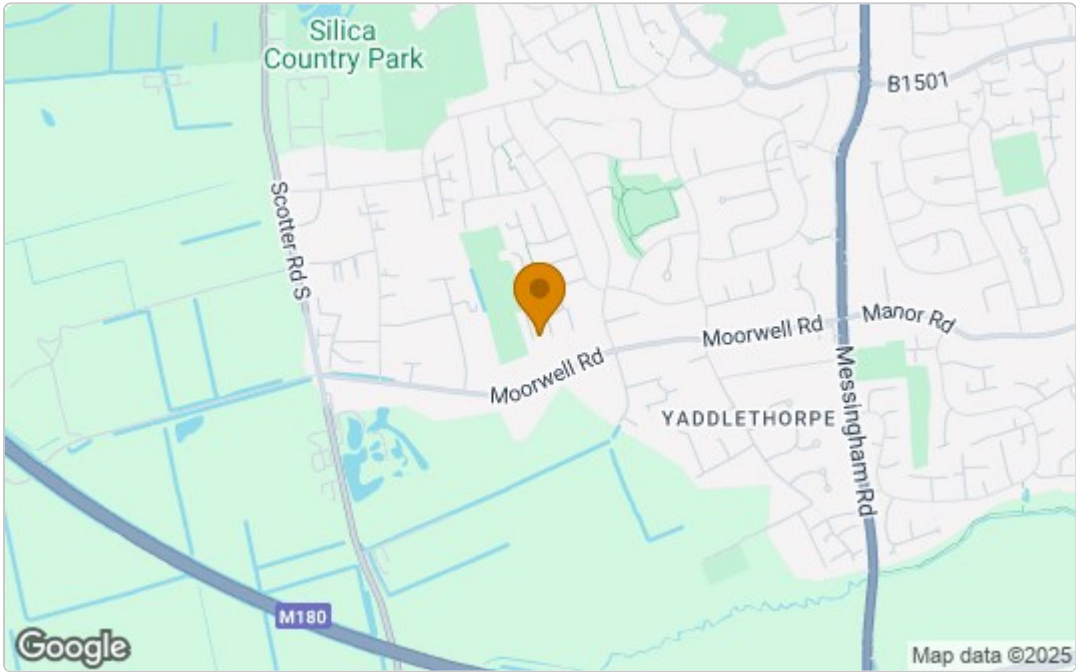

Energy Efficiency Graph

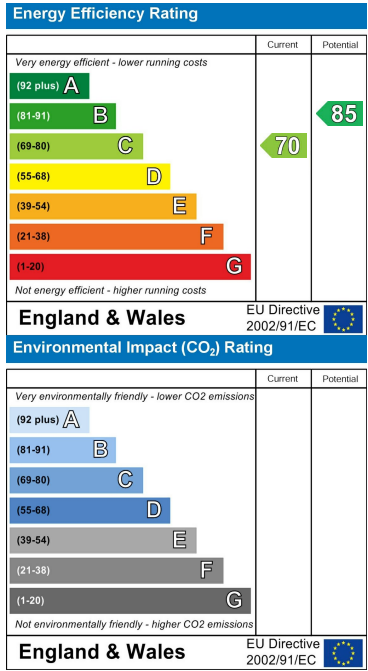

These particulars, whilst believed to be accurate are set out as a general outline only for guidance and do not constitute any part of an offer or contract. Intending purchasers should not rely on them as statements of representation of fact, but must satisfy themselves by inspection or otherwise as to their accuracy. No person in this firms employment has the authority to make or give any representation or warranty in respect of the property.