



EA
BEN
CADE



190 Warley Road, Scunthorpe, DN16 1PP

£65,000

Great little two bedroom first floor flat that is offered with no onward chain and a fantastic investment opportunity. The flat has had a new kitchen fitted, new flooring throughout and a boiler fitted in 2021. The flat consists of an entrance hall, kitchen, lounge, two double bedrooms and a shower room. Available for viewings now please call to book your appointment.

Entrance

Kitchen 8'1" x 8'5" (2.47 x 2.59)



Shower room 8'0" x 5'11" (2.46 x 1.81)

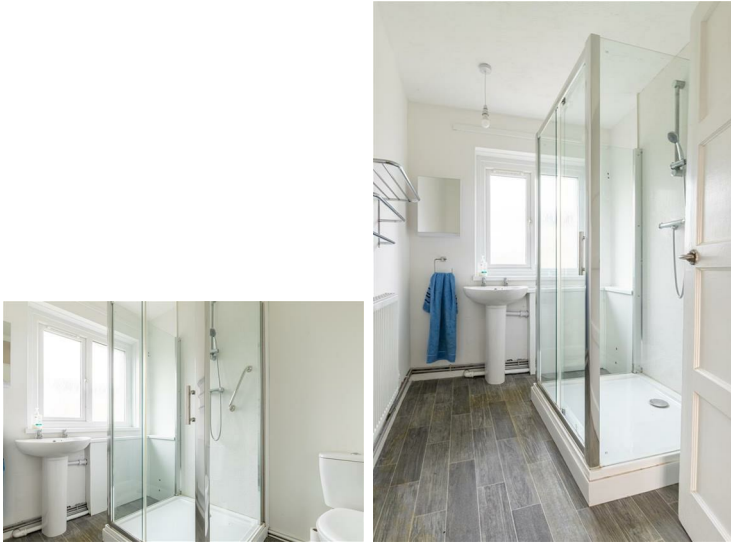

Lounge 12'8" x 15'6" (3.88 x 4.73)



Bedroom One 9'8" x 13'6" (2.95 x 4.14)



Bedroom Two 11'2" x 8'11" (3.42 x 2.72)



Balcony

First Floor

Approx. 61.3 sq. metres (659.6 sq. feet)

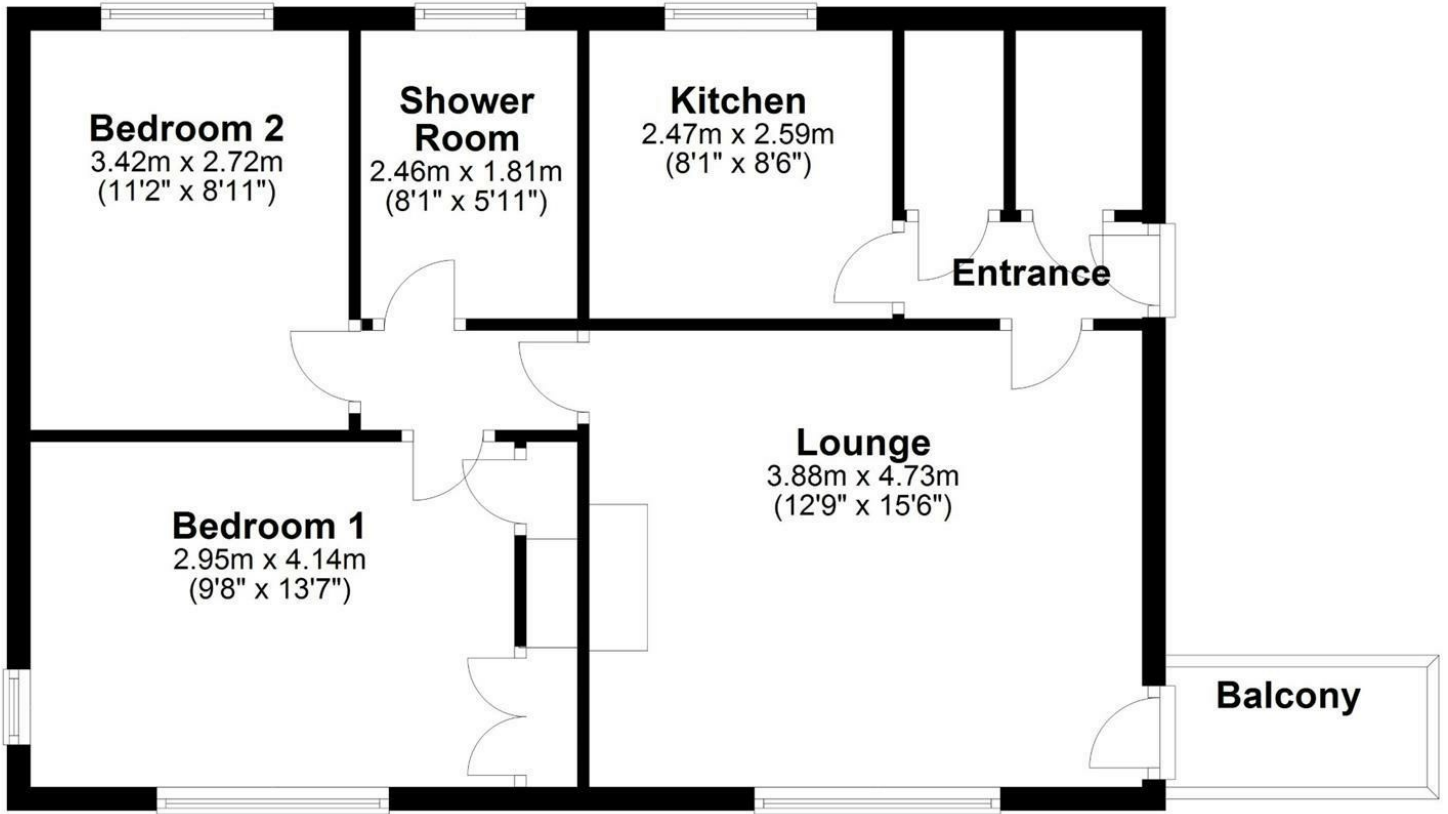

Total area: approx. 61.3 sq. metres (659.6 sq. feet)

Area Map

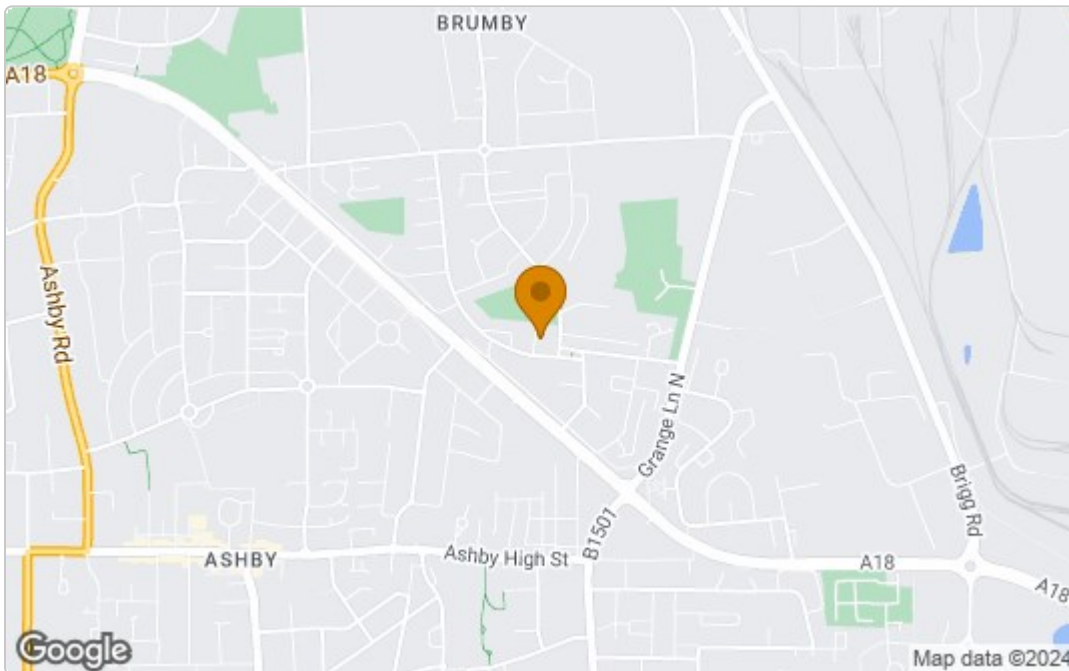

Energy Efficiency Graph

Energy Efficiency Rating		
	Current	Potential
Very energy efficient - lower running costs		
(92 plus) A		
(81-91) B	81	81
(69-80) C		
(55-68) D		
(39-54) E		
(21-38) F		
(1-20) G		
Not energy efficient - higher running costs		
EU Directive 2002/91/EC		
Environmental Impact (CO ₂) Rating		
	Current	Potential
Very environmentally friendly - lower CO ₂ emissions		
(92 plus) A		
(81-91) B		
(69-80) C		
(55-68) D		
(39-54) E		
(21-38) F		
(1-20) G		
Not environmentally friendly - higher CO ₂ emissions		
EU Directive 2002/91/EC		

These particulars, whilst believed to be accurate are set out as a general outline only for guidance and do not constitute any part of an offer or contract. Intending purchasers should not rely on them as statements of representation of fact, but must satisfy themselves by inspection or otherwise as to their accuracy. No person in this firm's employment has the authority to make or give any representation or warranty in respect of the property.