



## Westbourne Terrace, London W2

Guide price £775,000 Share of Freehold





# Description

Situated in Paddington, Westbourne Terrace is a highly esteemed street graced by its elegant stucco-fronted terrace and close proximity to both Hyde Park and the bustling station.

Located on the third floor, the apartment comprises a bright reception, separate kitchen, two double bedrooms and a bathroom.

The touch of elegance is added by the parquet wood floors, and the spacious reception area is perfect for hosting and entertaining.

With its convenient location this apartment provides easy access to an array of amenities including shopping, dining, hotels, healthcare facilities, cultural and recreational venues and more, enhancing the overall appeal and convenience of the area.



- Stucco-fronted Victorian townhouse
- 2 Double bedrooms
- 1 Bathroom
- South-facing reception
- Separate kitchen
- 697 sq ft / 64.8 sq m
- EPC C

# Floorplan

697 sq ft | 65 sq m

## WESTBOURNE TERRACE

APPROXIMATE GROSS INTERNAL FLOOR AREA 697 SQ.FT (64.8 SQ.M)

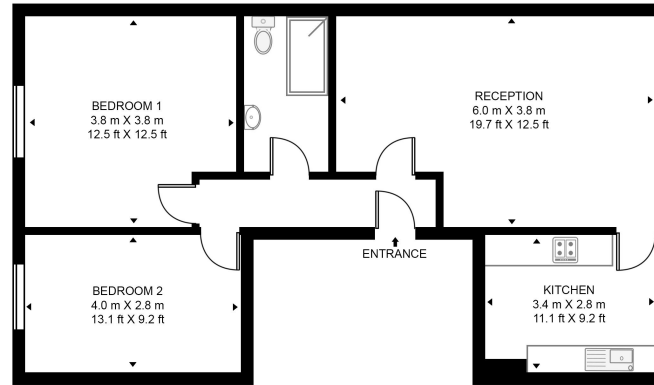

THIRD FLOOR



This floor plan has been defined by the RICS Code of Measurement. This floor plan and all others are for approximate representative purposes only and upon usage is agreed to as such by the client.  
WWW: [hdvirtualart.com](http://hdvirtualart.com) | TEL: 0203.974.1567 | EMAIL: [info@hdvirtualart.com](mailto:info@hdvirtualart.com)

Kensington  
387 Kensington High Street,  
London W14 8QA  
+4420 7087 5696  
[lettingskensington@eu.jll.com](mailto:lettingskensington@eu.jll.com)

*Urban living, your way.*

[jll.co.uk/residential](http://jll.co.uk/residential)

© 2019 Jones Lang LaSalle IP, Inc. All rights reserved. All information contained herein is from sources deemed reliable; however, no representation or warranty is made to the accuracy thereof.

