



Hugero Point, 2 Rennie Street, Greenwich SE10 0GS



Hugero Point, 2 Rennie Street, SE10

Leasehold (986 years remaining)

This stunning apartment features a large private balcony offering stunning river views across to Canary Wharf from the kitchen/dining area. It is located in the Greenwich Peninsula (Greenwich Millennium Village), within walking distance of the Greenwich Shopping Park.

Key Features

- 2 Bedrooms, 2 Bathrooms
 - Light and spacious
 - Riverside development
 - Council Tax: **D**
 - Service Charge: **£3,488.86**
 - Ground Rent: **£400**
 - Excellent transport links
 - EPC: **B**
-

Situated in a corner block of buildings, this apartment benefits from river views and the assurance that no further developments will be built nearby. This elevated vantage point captures the ever-changing beauty of the river and the capital, offering a truly unique perspective of one of the world's great cities. With a generous 864 square feet of interior space, the apartment includes two well-proportioned bedrooms and two bathrooms, designed to maximize both comfort and functionality.

The location is advantageous, being next to the Greenwich Yacht Club, Southern Park and Ecology Park, and features a quiet neighbourhood with local nurseries just around the corner. The development also offers luxurious amenities such as a 24-hour concierge service, internal bike storage, and various playgrounds, all within a short walk.

Transport connections are easily accessible, with North Greenwich station (Jubilee Line) and Westcombe Park (overground) offering convenient links to Canary Wharf, London Bridge and Central London. Also, the Thames Clipper service provides a scenic commuting option.









Hugero Point, SE10

Approximate Gross Internal Area = 80.2 sq m / 864 sq ft

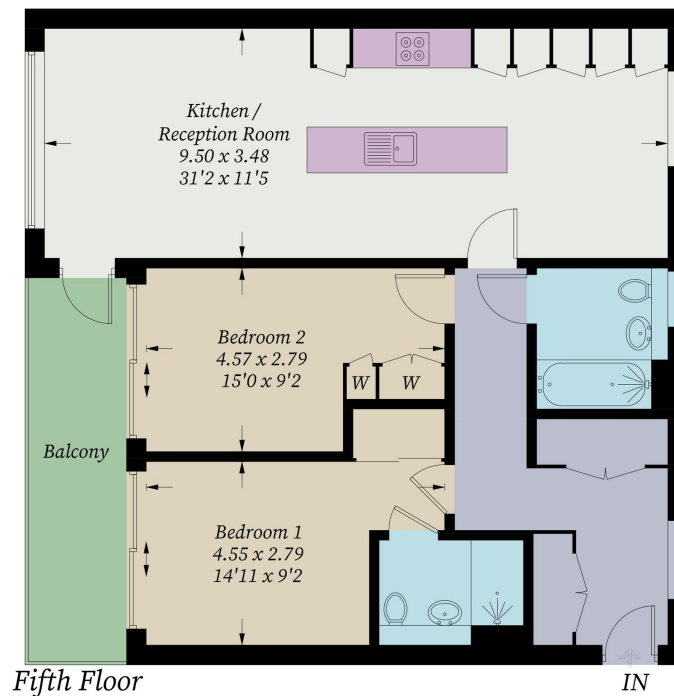

Illustration for identification purposes only, measurements are approximate,
not to scale. Fourlabs.co © (ID1267952)

22 College Approach, Greenwich,
London, SE10 9HY
Tel: 020 7399 5595

Sales, Lettings & Property Management

residential.jll.co.uk

