



Braddyll Street, Greenwich, London, SE10 9AE



Braddyll Street, Greenwich, London SE10

Freehold

A pretty, period terraced house located in this sought after street in East Greenwich just a short walk from Maze Hill and Greenwich mainline stations and the Cutty Sark DLR station

Key Features

- Two Double Bedrooms
 - Two Reception Rooms
 - Front and Rear Gardens
 - Council Tax: **D**
 - Period Terraced house
 - Beautifully presented
 - Close to mainline and DLR
 - EPC: **D**
-

The accommodation comprises a bright and airy living space with period fireplace with built in cupboards and shelving to both alcoves, beautiful sash windows with wooden shutters. Reception two is currently used as a dining room also has built in cupboards to each alcove and opens onto a fitted kitchen with an arrangement of base and wall mounted units, stone worktops and side access onto the rear garden. The rear garden is a good size (23'0 x 13'4) and perfect for socializing with friends and family. Also on the ground floor is a contemporary family bathroom. On the first floor, you have two good sized double bedrooms.

The property is just a short walk from Maze Hill and Greenwich mainline stations and the Cutty Sark DLR station. The river walk is a great way to end the evening after a long day at work and you can take full advantage of the excellent range of bars, restaurants, and shops that Greenwich has to offer.









Braddyll Street, SE10

Approximate Gross Internal Area = 57.9 sq m / 623 sq ft

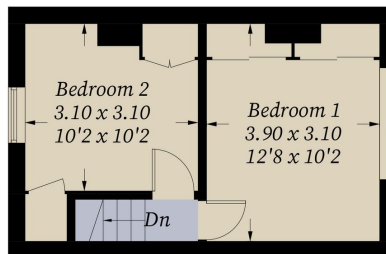

First Floor

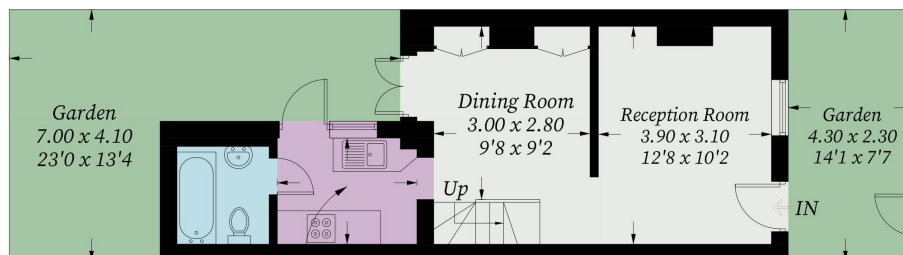

Kitchen
2.50 x 1.80
8'2 x 5'9

Ground Floor

Illustration for identification purposes only, measurements are approximate,
not to scale. Fourlabs.co © (ID1183087)

22 College Approach, Greenwich,
London, SE10 9HY
Tel: 020 7399 5595

Sales, Lettings & Property Management

residential.jll.co.uk

