



Chandlers Avenue, Greenwich, SE10 0NN



## Chandlers Avenue, Greenwich SE10

Leasehold (115 years remaining)

EWS1 Complaint - A beautifully presented 8th floor apartment, located in the popular Greenwich Peninsula, moments from North Greenwich underground station for the Jubilee line.

### Key Features

- 1 Bedroom
- South-west facing Balcony
- 8th Floor
- Council Tax: **B**
- Concierge Services
- Excellent storage
- Service Charge: **£2,800 P/A**
- EPC: **B**

The accommodation comprises; large entrance hall and double built in cupboard for great storage and doors leading to all rooms. Open plan kitchen / reception room which measures (21'5 x 14'3) which leads onto a private south-west balcony overlooking the communal ground. Double bedroom and a separate family bathroom finished off the property.

Greenwich Peninsula is a vibrant area with a mix of residential, commercial, and leisure developments. It is also best known for The O2, an iconic entertainment venue that hosts concerts, sports events, exhibitions, and more. The O2 is surrounded by restaurants, bars, and other entertainment options, making it a popular destination for locals and tourists alike. You also have access to the Emirates Air Line cable car, which provides a unique mode of transport across the River Thames, offering stunning views of London.

You are also moments from The Tide, the newly landscaped Thames riverfront park, a running/cycle path and the Peninsula's multi open green spaces, including Central Park and the Ecology Park.













## *Chandlers Avenue, SE10*

Approximate Gross Internal Area = 50.7 sq m / 546 sq ft

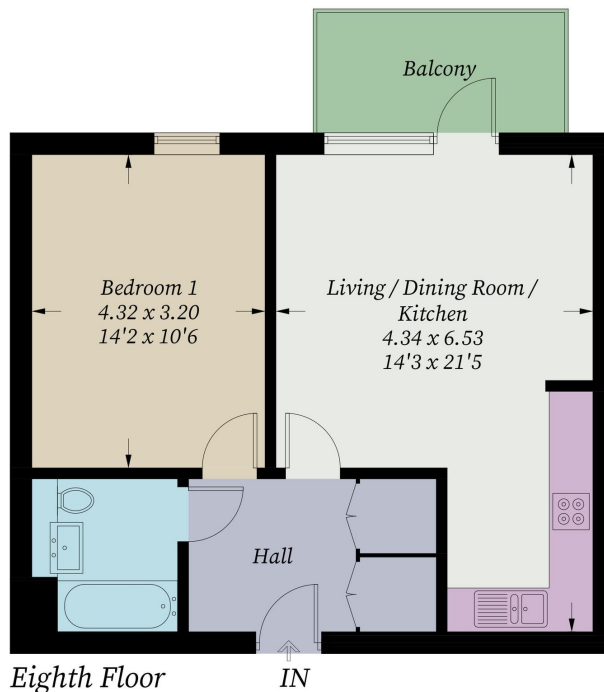

Illustration for identification purposes only, measurements are approximate, not to scale. Fourlabs.co © (ID1179779)

22 College Approach, Greenwich,  
London, SE10 9HY  
Tel: 020 7399 5595

**Sales, Lettings & Property Management**

**[residential.jll.co.uk](https://residential.jll.co.uk)**

