



Atlantic Point, 2 Harrison Walk, Greenwich, London SE10 0YL



Atlantic Point, Greenwich, London, SE10

Leasehold (997 years remaining)

EWS1 COMPLIANT - A beautifully presented apartment on the 3rd floor overlooking the communal grounds. This spacious property measures circa 783 sq. ft and occupies a prime position on the Thames

Key Features

- 2 Double bedrooms, 2 Bathrooms
- Large Balcony
- Prestigious Riverside Development
- 24Hr Concierge and Onsite Leisure
- Council Tax: **E**
- Service Charge: **£4,000 P/A**
- Ground Rent: **£350 P/A**
- Walk to Cutty Sark DLR
- Walk to Maze Hill mainline
- EPC: **B**

The accommodation comprises large entrance hall with built in storage, large reception room / kitchen with floor to ceiling windows providing views of the communal grounds. Two double bedrooms, master with en-suite bathroom and a separate family bathroom.

The apartment is light and spacious throughout and benefits from 24 hour concierge and also access to private leisure facilities, which include a swimming pool, gymnasium, tennis court and gardens within the grounds.

River Gardens is arguably one of the best and most popular riverside developments in Greenwich, and is located just east of the old Naval College, Museum and The Royal Park with its Observatory. The town centre is only a short walk away which gives access to a superb array of shops and restaurants.









Atlantic Point

Approximate Gross Internal Area = 72.7 sq m / 783 sq ft

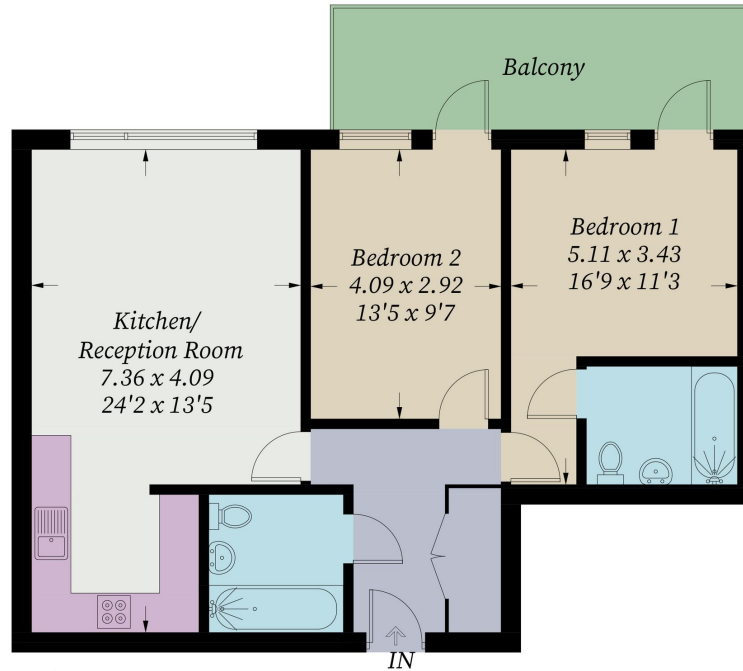

Third Floor

Illustration for identification purposes only, measurements are approximate,
not to scale. Fourlabs.co © (ID1176267)

22 College Approach, Greenwich,
London, SE10 9HY
Tel: 020 7399 5595

Sales, Lettings & Property Management

residential.jll.co.uk

