



*Cutter Lane, Greenwich, SE10 0ZT*



## 2 Cutter Lane, Greenwich, London, SE10

Leasehold (250 years remaining)

***A stylish flat located in the Upper Riverside development, on the 1st floor with views of the gardens, close to North Greenwich tube station (Jubilee Line) with direct links into Canary Wharf and the City.***

### Key Features

- 1 Double bedrooms
- First Floor
- On-site leisure facilities
- Council Tax: **D**
- Service Charge: **£4,130 P/A**
- Ground Rent: **£563 P/A**
- Walk to transport links
- EPC: **B**

---

The accommodation comprises open plan living space with a fitted kitchen and lounge that opens onto a balcony which offers garden views and far reaching Thames views. Good sized bedroom with fitted wardrobes and a separate contemporary bathroom.

Upper Riverside in Greenwich Peninsula was designed by world-famous architects som, the 5 prism towers cascade along the riverfront. Located 300m from North Greenwich bus and tube station, adjacent to the IFS Cloud Cable car and opposite North Greenwich Pier, transport links are readily available. Residents of Upper Riverside enjoy the full set of exclusive residents' amenities such as spa pool, steam room, two well equipped gyms, 20m swimming pool, bbq facilities, 24 Hour concierge, cinema, media room and residents roof terraces.











## Cutter Lane, London, SE10

Approximate Area = 524 sq ft / 48.7 sq m

For identification only - Not to scale

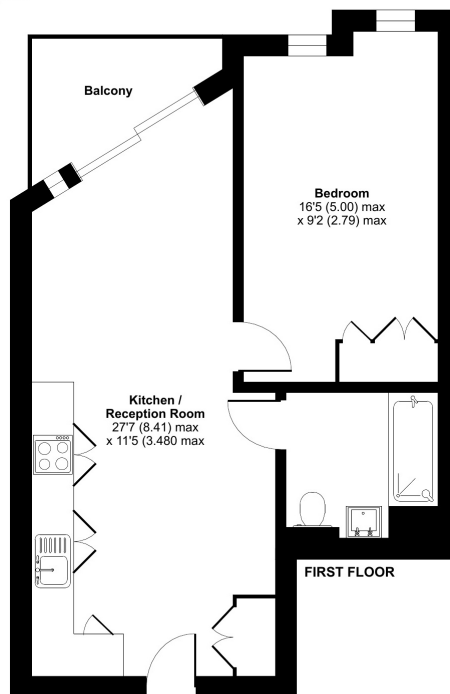

Certified  
Property  
Measurer

Floor plan produced in accordance with RICS Property Measurement Standards incorporating  
International Property Measurement Standards (IPMS2 Residential). © richcom 2023.  
Produced for JLL Residential. REF: 1038713

22 College Approach, Greenwich,  
London, SE10 9HY  
Tel: 020 7399 5595

**Sales, Lettings & Property Management**

**[residential.jll.co.uk](https://residential.jll.co.uk)**

