



*Wyndham Apartments, 65 River Gardens Walk, Greenwich, SE10 0TZ*



## Wyndham Apartments, Greenwich, SE10

Leasehold (985 years remaining)

***Located on the 9th floor of this amazing riverside development, this property has a fantastic aspect with Thames river views from the balcony.***

### Key Features

- 2 Double bedrooms
- 2 Bathrooms
- Stunning river views
- 24-Hour concierge
- Council Tax: E
- Service Charge: **£5,484 P/A**
- Ground Rent: **£400 P/A**
- On-site leisure facilities
- Close to Maze Hill mainline
- EPC: B

The accommodation comprises large entrance hall with a built in double storage cupboard. 29'0 sq ft open plan reception room / kitchen with integrated appliances and access onto the balcony with river views. Two double bedrooms, master with en-suite four piece bathroom and a separate family bathroom.

The property is beautifully presented throughout in neutral tones.

The River Gardens development is located in East Greenwich and offers multiple commuting options to Central London - a mere 10 minute walk to Maze Hill, along with the easy access to the DLR, boat and tube.













## River Gardens Walk, London, SE10

Approximate Area = 963 sq ft / 89.4 sq m

For identification only - Not to scale

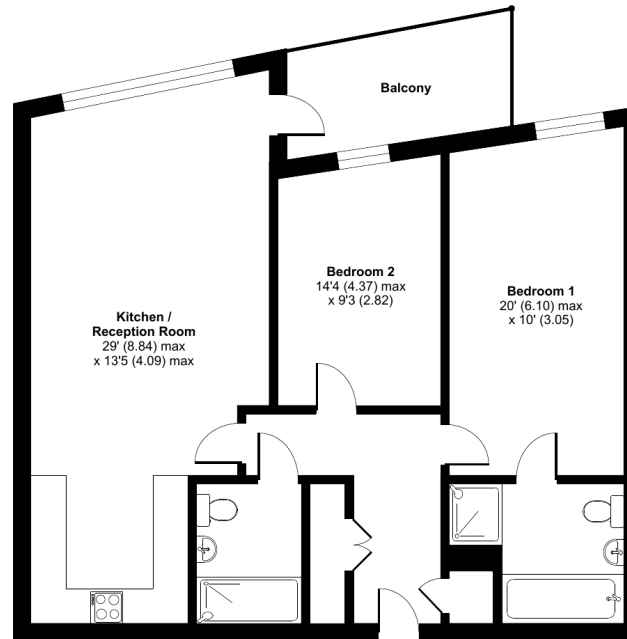

**NINTH FLOOR**



Floor plan produced in accordance with RICS Property Measurement Standards incorporating International Property Measurement Standards (IPMS2 Residential). © nlcocom 2023.  
Produced for JLL Residential. REF: 1061648

22 College Approach, Greenwich,  
London, SE10 9HY  
Tel: 020 7399 5595

**Sales, Lettings & Property Management**

**residential.jll.co.uk**

