



Iverson Point, 4 Harrison Walk, Greenwich, London SE10 0XN



## Iverson Point, 4 Harrison Walk, London, SE10

Leasehold (993 years remaining)

*Boasting a residents only gym, swimming pool & tennis courts, as well as a 24-hour concierge, this stunning apartment comes to the market boasting generous living space throughout. Built in 2019, in the ever popular River Gardens development*

### Key Features

- 2 Double bedrooms
- 2 Bathrooms
- Balcony with river views
- Council Tax: **E**
- Service Charge: **£4,500 P/A**
- Ground Rent: **£350 P/A**
- Walk to Maze Hill mainline
- EPC: **B**

The accommodation comprises; a welcoming entrance hallway with doors leading to all rooms and a large storage / utility cupboard. The reception room is a generous size at 24'2 x 11'5 which has been tastefully decorated in neutral tones with a large balcony offering impressive views. The kitchen has been finished with high-quality worksurfaces, an array of eye and base level units and integrated appliances. Two double bedrooms, master bedroom has a floor-to-ceiling window, flooding the room with natural light, there is also a fitted wardrobe, providing ample storage and access into an en-suite shower room. Bedroom two benefits from access onto the shared balcony from the main reception room. Completing the flat is the family bathroom.

The River Gardens is a stunning development along the river, boasting impressive facilities, including a residents gym, swimming pool, tennis courts & a 24-hour concierge.













## Iverson Point, SE10

Approximate Gross Internal Area  
73.6 sq m / 793 sq ft

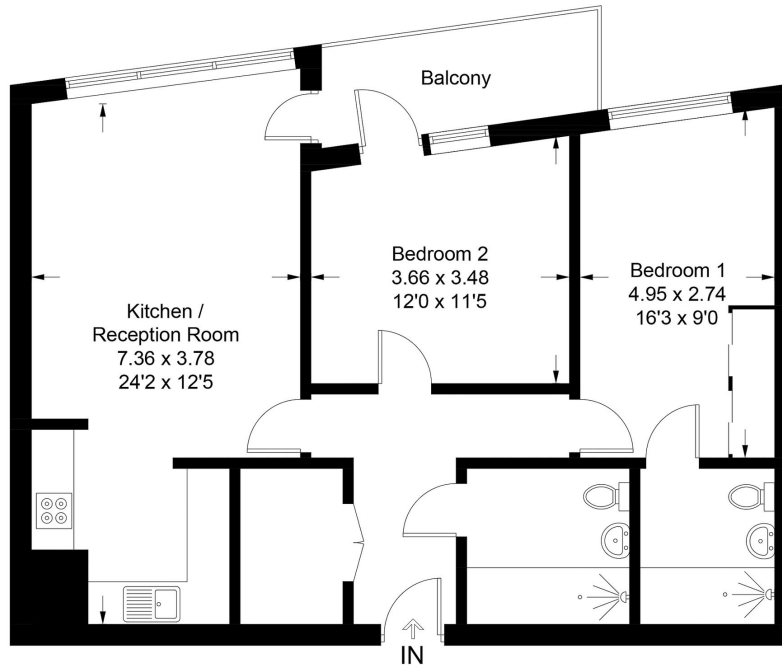

Illustration for identification purposes only, measurements are approximate,  
not to scale. Fourlabs.co © (ID1153666)

22 College Approach, Greenwich,  
London, SE10 9HY  
Tel: 020 7399 5595

**Sales, Lettings & Property Management**

**[residential.jll.co.uk](https://residential.jll.co.uk)**

