



Ringwood Court, 24 Kidbrooke Grove, Blackheath, SE3 0LF



Ringwood Court, Blackheath, SE3

Share of Freehold (978 years remaining)

Forming part of this imposing detached Victorian residence and positioned on one of Blackheath's most prestigious roads comes this top floor apartment.

Key Features

- 2 Bedrooms
- Period apartment
- Garage
- Council Tax: **D**
- Service Charge: **£1,500 P?A**
- Close to Blackheath Village
- Shared communal garden
- EPC: **C**

The accommodation comprises; a large and welcoming entrance hallway with doors leading to all rooms. The reception room is a generous size at 14'10 x 21'9 boasting large bay window to the front, flooding the room with natural light. The newly-fitted kitchen has been thoughtfully arranged with an array of eye and base level units. Both bedrooms are located at the opposite end to the reception room, and the principle bedroom is a good sized double. The second bedroom is smaller, perfect as either a guest room or home office and completing the property is the family shower room.

Kidbrooke Grove is just a short walk to Blackheath mainline station and the bars, shops and restaurants of Blackheath Village and a short distance away from Greenwich Park and the River Thames.

Early viewings are highly recommended









Ringwood Court

Approximate Gross Internal Area = 52.8 sq m / 568 sq ft

Garage = 11.5 sq m / 124 sq ft

Total = 64.3 sq m / 692 sq ft

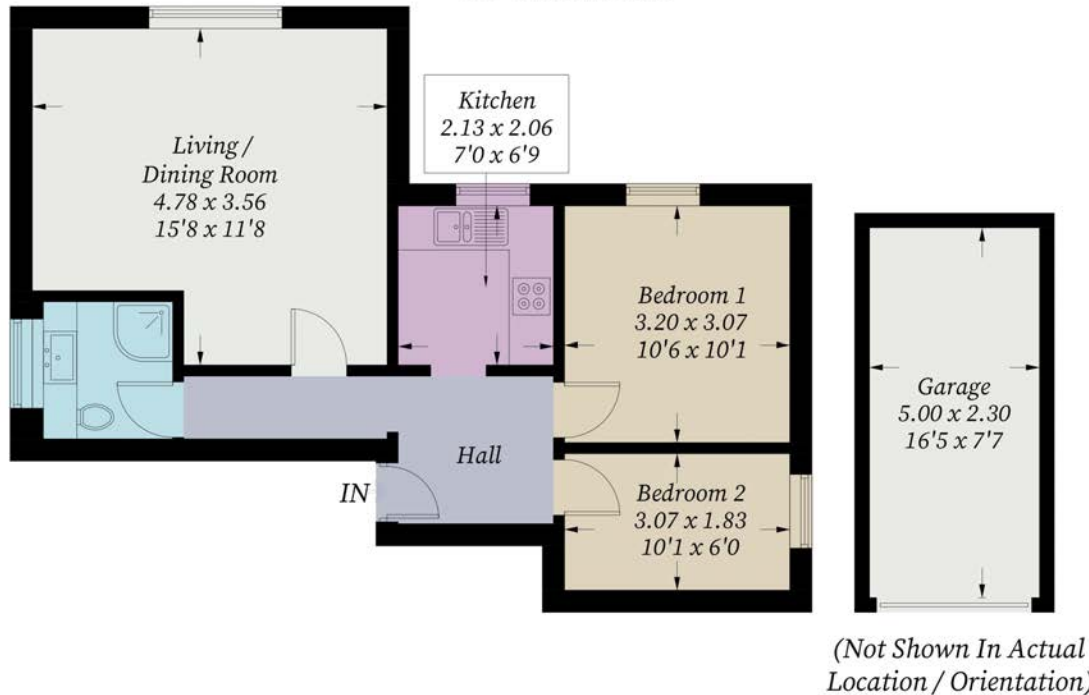

Illustration for identification purposes only, measurements are approximate,
not to scale. Fourlabs.co © (ID1191392)

22 College Approach, Greenwich,
London, SE10 9HY
Tel: 020 7399 5595

Sales, Lettings & Property Management

residential.jll.co.uk

