



Knights Tower, 14 Wharf Street, London, SE8 3FX



Knights Tower, 14 Wharf Street, London, SE8

Leasehold (982 years remaining)

A light and well presented modern apartment located in the Paynes & Borthwick development just a short walk from Deptford mainline station and the Cutty Sark DLR.

Key Features

- 2 Bedrooms
- 2 Bathrooms
- Balcony
- Council Tax: E
- Service Charge: £3,857.80
- Ground Rent: £400 p/a
- 24 Hour concierge
- EPC: B

Situated on the 10th floor, this light and spacious accommodation comprises; large entrance hall with a double built in cupboard and doors leading to all rooms. Open plan kitchen with integrated appliances / reception room with access onto a private balcony with beautiful river views. Two double bedrooms, master with access to an en-suite shower room, bedroom two has fitted wardrobes. A large family bathroom finishes off the property.

The development benefits from excellent transport links with both Deptford Bridge DLR station and Cutty Sark Station walking distance from the property both providing excellent links into both Canary Wharf and London Bridge. Just a short distance from Knights Tower, you will find Greenwich high street and the famous Greenwich Market. This vibrant market offers a diverse range of food stalls, crafts, antiques, clothing, and more. It's a wonderful place to explore and indulge in unique shopping experiences. The high street offers a vast array of both restaurants, amenities and shops.

The property also benefits from a 24 hour concierge and underground parking.









Knights Tower

Approximate Gross Internal Area = 64.5 sq m / 694 sq ft

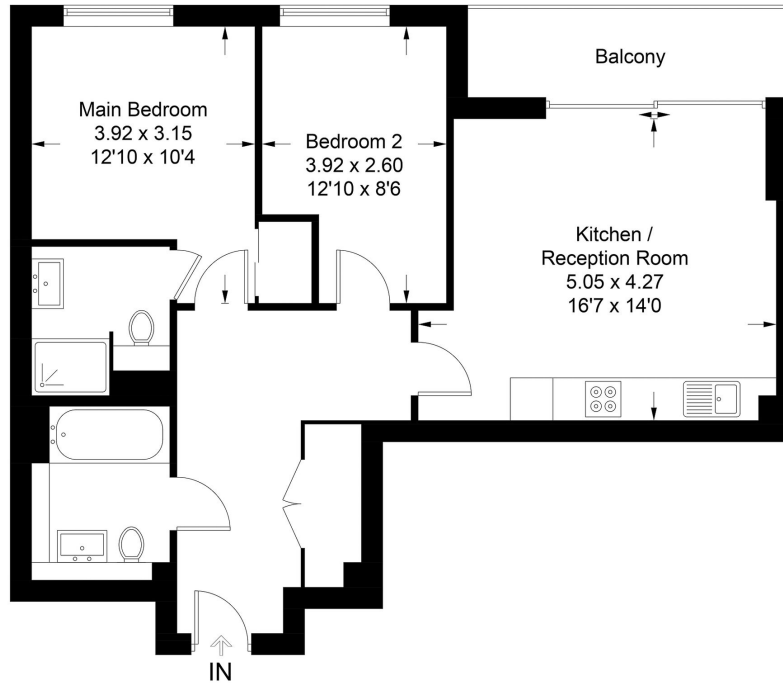

Illustration for identification purposes only, measurements are approximate, not to scale. floorplansUsketch.com © (ID1111296)

22 College Approach, Greenwich, London, SE10 9HY

Sales, Lettings & Property Management

Tel: 020 8858 9986

residential.jll.co.uk

