



Iverson Point, 4 Harrison Walk, Greenwich, London SE10 0YN



Iverson Point, Greenwich, London, SE10

Leasehold (991 years remaining)

EWS1 Compliant - This beautifully presented apartment on the 7th floor in one of Greenwich's premier riverside developments.

Key Features

- 2 Double bedrooms
- 2 Bathrooms
- Private balcony
- Fantastic river views
- Council Tax: E
- Service Charge: £4,800 p/a
- Ground Rent: £350 p/a
- EPC: B

The accommodation comprises; a welcoming entrance hallway with doors leading to all rooms. The open-plan reception room is a generous size at 26'3 x 11'6 and has been tastefully decorated in neutral tones. The kitchen has been thoughtfully arranged with an array of eye and base level units, integrated appliances and finished to a high standard. The main bedroom is a large double at 16'1 x 9'1 with en-suite shower room and built wardrobes. The second bedroom is also a generous double at 11'7 x 10'11 which is currently being used as a home office. Completing the flat is the family bathroom. The balcony is accessed from the reception room and offers fantastic views over the river and faces south, flooding the flat with natural light.

The residents of River Gardens also have access to a private gym, swimming pool & tennis court. There is a 24-hour concierge as well offered for convenience. Cutty Sark Station is a short 0.7 mile walk from the property, offering excellent links directly into Canary Wharf. Greenwich high street is also close by with its excellent array of shops, restaurants, pubs and amenities.









Iverson Point, Harrison Walk, SE10

Approximate Internal Area = 793 sq ft / 73.67 sq m

Balcony = 57 sq ft / 5.3 sq m

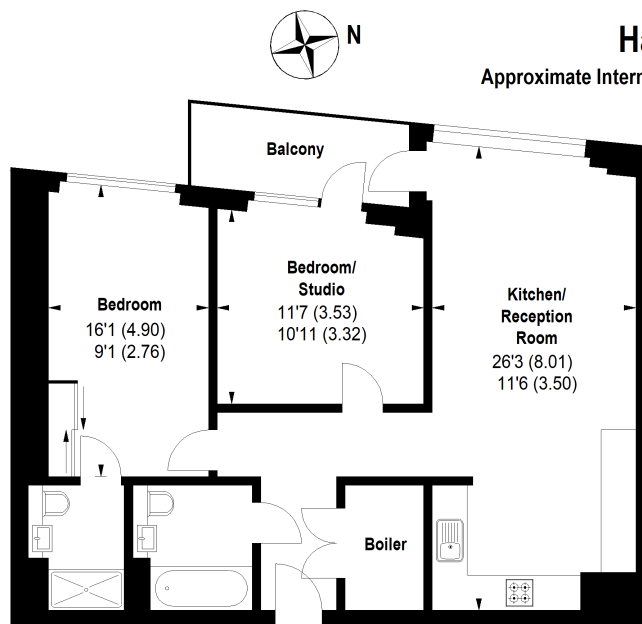

SEVENTH FLOOR

Not to scale, for guidance only and must not be relied upon as a statement of fact.
All measurements and areas are approximate only

22 College Approach, Greenwich, London, SE10 9HY

Sales, Lettings & Property Management

Tel: 020 8858 9986

residential.jll.co.uk

