



Cutter Lane, Greenwich, London SE10 0ZT



Cutter Lane, Greenwich, London, SE10 0ZT

Leasehold

A stylish one bedroom located in the Upper Riverside development, on the 1st floor with views of the gardens, 5 mins from North Greenwich tube station (Jubilee Line).

Key Features

- 1 Bedroom
- 1 Bathroom
- Balcony
- Residents' roof terrace
- On-site leisure facilities
- North Greenwich tube (Jubilee)
- 1st Floor
- EPC: B

The accommodation comprises open plan living space with a fitted kitchen and lounge that opens onto a balcony which offers garden views and far reaching Thames views. Good sized bedroom with fitted wardrobes and a separate contemporary bathroom.

Upper Riverside in Greenwich Peninsula was designed by world-famous architects so, the 5 prism towers cascade along the riverfront. Located 300m from North Greenwich bus and tube station, adjacent to the IFS Cloud Cable car and opposite North Greenwich Pier, transport links are readily available. Residents of Upper Riverside enjoy the full set of exclusive residents' amenities such as spa pool, steam room, two well equipped gyms, 20m swimming pool, bbq facilities, 24 Hour concierge, cinema, media room and residents roof terraces.









Cutter Lane, London, SE10

Approximate Area = 524 sq ft / 48.7 sq m

For identification only - Not to scale

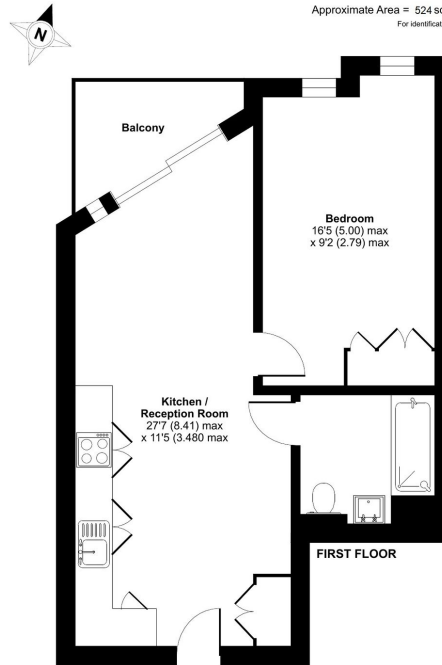

Floor plan produced in accordance with RICS Property Measurement Standards incorporating International Property Measurement Standards (IPMS Residential). © nicholson 2023. Produced for JLL Residential. REF: 1038713

22 College Approach,
Greenwich, SE10 9HY

Sales, Lettings & Property Management

Tel: 020 8858 9986

residential.jll.co.uk

