



Whiteheads Grove, London SW3

Guide price £850,000 Leasehold







Description

A very comfortable one bed flat situated on the fifth floor of this very well regarded block with 24/7 security and portage. Cranmer Court is located half way up Sloane Avenue in the heart of Chelsea and equidistant from Sloane Square and South Kensington.

- 1 Double bedroom
- 1 Bathroom
- Reception room
- Fully fitted kitchen
- 24-hour porter
- Lift
- Communal heating & hot water included
- Approx. 584 sq ft (54 sq m)
- EPC: C
- Council tax: Band F

Floorplan

584 sq ft | 54 sq m

Approx. Gross Internal Area 584 Sq Ft - 54.25 Sq M

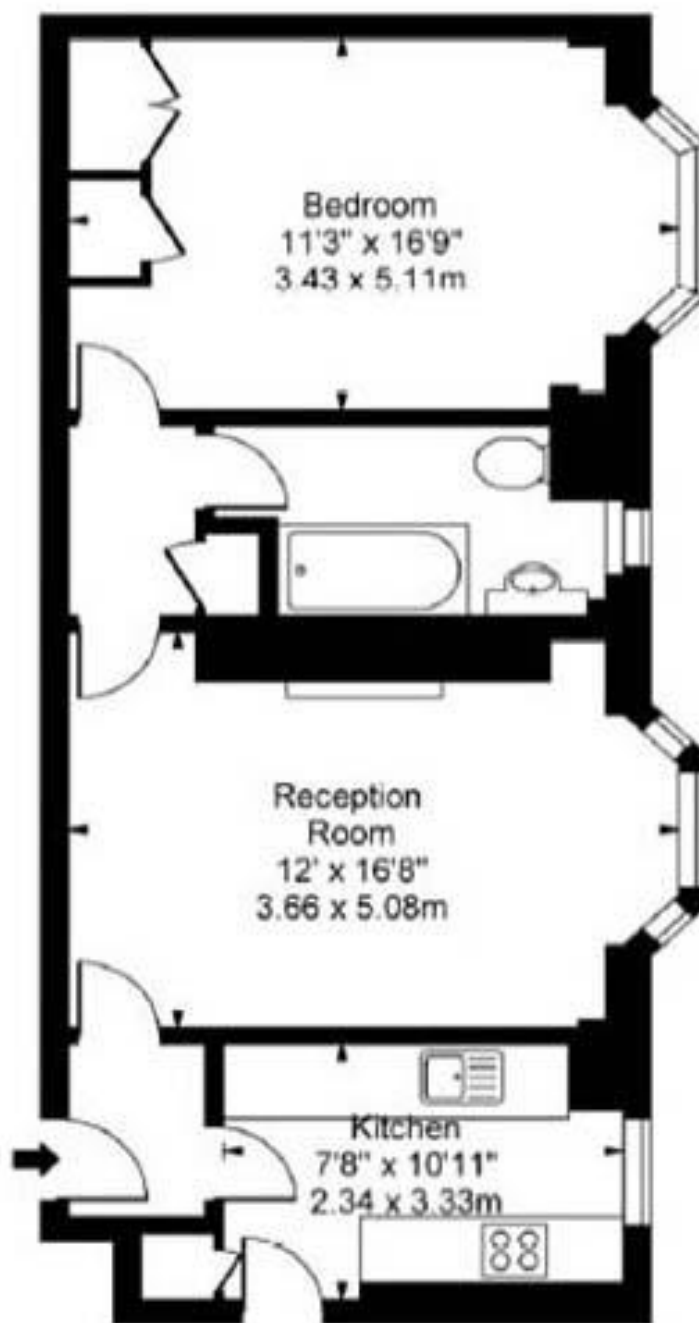

Sixth Floor

Chelsea & Knightsbridge
174 Brompton Road,
London SW3 1HP
+4420 7306 1600
salesknightsbridge@jll.com

Urban living, your way.

jll.co.uk/residential

© 2019 Jones Lang LaSalle IP, Inc. All rights reserved. All information contained herein is from sources deemed reliable; however, no representation or warranty is made to the accuracy thereof.

