



## Draycott Place, London SW3

Price £475 per week - Unfurnished









## Description

A well presented raised ground floor flat in this period building in the heart of Chelsea. The property consists of one double bedroom, one bathroom, reception room and a fully fitted kitchen. Draycott Place is close to all the amenities with plenty of shops, bars and restaurants within walking distance.

Rent is payable on a monthly basis and you may be required to pay more than a month's rent in advance, depending on your circumstances. You will be required to pay a 1 week holding deposit following a successful offer. Utility bills, council tax, telephone line and broadband are not included in the rent. As well as paying the rent, you may also be required to make some additional permitted payments. If your tenancy does not qualify as an AST, additional fees may apply. Please visit [jll.co.uk/fees](http://jll.co.uk/fees) for details of fees which may be payable when renting a property.

- 1 Double bedroom
- 1 Bathroom
- Reception room
- Fully fitted kitchen
- Ground floor
- Approx. 369 sq ft (34 sq m)
- Furnished
- EPC: C
- Council tax: Band F
- Deposit amount: £2,375 (estimate) and an initial holding deposit of 1 week's rent is payable to res

# Floorplan

369 sq ft | 34 sq m

Approx. Gross Internal Area \*  
369 Ft<sup>2</sup> - 34.28 M<sup>2</sup>

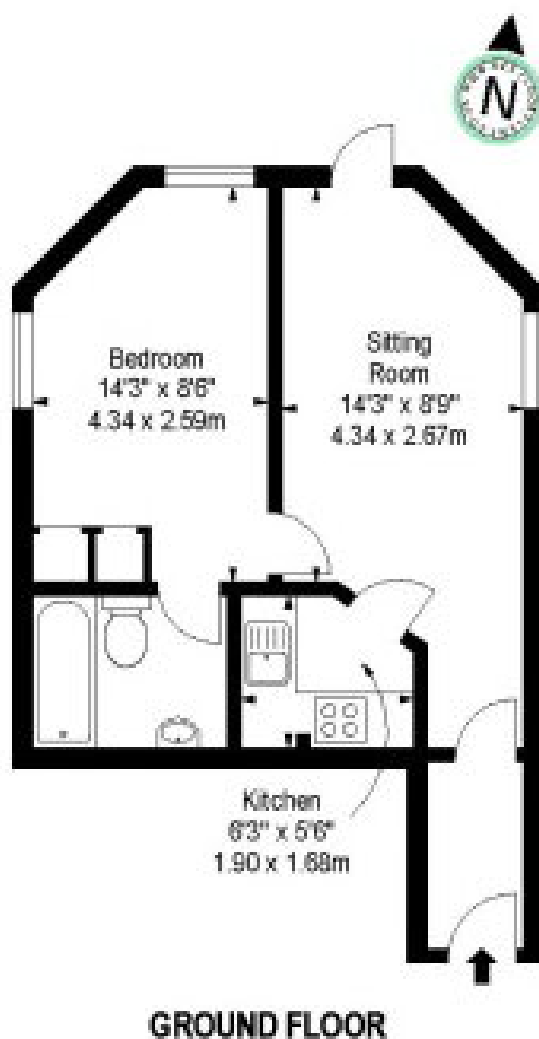

Chelsea  
2 Cale Street,  
London SW3 3QU  
+4420 7399 5010  
saleschelsea@jll.com

*Urban living, your way.*

[jll.co.uk/residential](http://jll.co.uk/residential)

© 2019 Jones Lang LaSalle IP, Inc. All rights reserved. All information contained herein is from sources deemed reliable; however, no representation or warranty is made to the accuracy thereof.

