

# WOODFORD HOUSE

SW6







Approx Gross Internal Area  
646 sq ft - 60 sq m

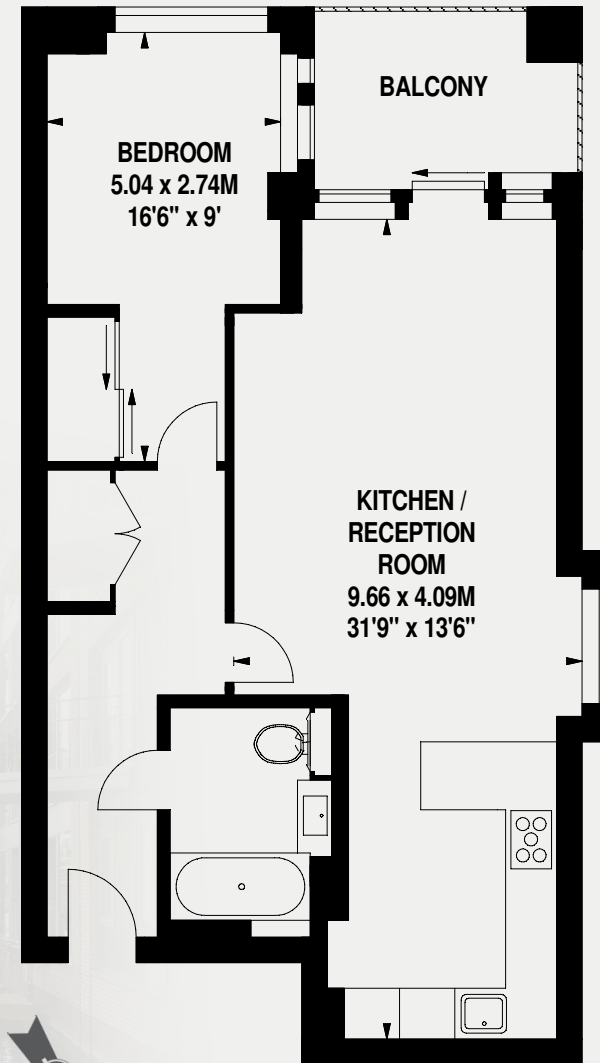

Third Floor

A superb apartment located on the third floor, measuring approximately 656 square feet and presented in immaculate condition. It also includes underground parking space.

There is a spacious open-plan reception room perfect for entertaining. The kitchen is fully equipped and of high specification, with integrated appliances and a breakfast bar. There is a good-sized double bedroom with built-in storage. Additionally, there is a large southwest-facing balcony overlooking the wonderful landscaped garden, comfort cooling and wooden floors throughout.

Woodford House is part of Chelsea Creek, a modern, luxurious development close to the River Thames and the New Kings Road. The development has on-site leisure facilities, including a residents' gym, a swimming pool, a spa, and a 24-hour concierge/security service.

**ACCOMMODATION**

One double bedroom | Bathroom | South West facing balcony | Comfort cooling | Leisure facilities | Residents' gym | Swimming pool/Spa | 24 hour concierge/security service



Guide price: £710,000

Tenure: Leasehold of approximately  
985 years remaining

Service charge: £7,356 pa

Ground rent: £350 pa

EPC: B

Council tax: Band F

These particulars are for general information only and do not constitute any part of an offer or contract. All statements contained therein are made without responsibility on the part of the vendors or lessors and are not to be relied upon as statement or representation of fact. Intending purchasers or lessees must satisfy themselves, by inspection, or otherwise, as to the correctness of each of the statements or dimensions contained in these particulars.

JLL Knightsbridge  
174 Brompton Road,  
London SW3 1HP  
020 7306 1610

