



## 8 Waterlily Close

Etruria, Stoke-On-Trent, ST1 5PY

Welcome to your future home in the heart of Etruria, Stoke-on-Trent — a beautifully presented three-bedroom, two-bathroom linked-detached house complete with a private garage, offering the perfect blend of comfort, convenience, and community. This charming property is nestled in a quiet residential enclave, ideal for families and professionals alike. The spacious layout includes a cosy living area, a modern kitchen, ground-floor WC, and generously sized bedrooms, including a master with en-suite. A private garden and integrated garage add to the appeal, making this home as practical as it is inviting. Living in Etruria means enjoying the best of both worlds — a peaceful neighbourhood with excellent access to urban amenities. Just minutes away, Festival Park offers a wide array of retail outlets, restaurants, and leisure facilities, including Waterworld and the Odeon cinema. Everyday essentials are easily met with nearby supermarkets such as Tesco Extra and Asda Wolstanton, while local pubs and eateries like Brindley Farm and Toby Carvery provide cosy spots to unwind. For those who cherish the outdoors, Etruria Park is just a short stroll away — a greenhaven perfect for morning jogs, weekend picnics, or simply soaking up the fresh air. Additional green spaces like North Shelton Community Garden and Specimen Square offer further opportunities to relax and reconnect with nature. With its rich industrial heritage, strong community spirit, and ongoing regeneration, Etruria is a place where tradition meets progress. This home is more than just a property — it's a lifestyle opportunity in one of Stoke-on-Trent's most accessible and evolving neighbourhoods. Your new beginning starts here.

**Offers in excess of £190,000**

# 8 Waterlily Close

Etruria, Stoke-On-Trent, ST1 5PY



- THREE BEDROOM, TWO BATHROOM, LINK DETACHED PROPERTY
- EXCELLENT COMMUTER LINKS
- MODERN DECOR WITH CONTEMPORARY INTERIOR
- NEARBY GREEN SPACES
- CLOSE TO FESTIVAL PARK
- THRIVING NEIGHBOURHOOD

DISCLAIMER: contact 01782 622621 [help@lowe-elliott](mailto:help@lowe-elliott)

## Lounge/Diner

11'10" x 14'1" (3.62m x 4.31m)

## Kitchen/Breakfast Room

15'2" x 9'3" (4.64m x 2.83m)

## W.C

2'11" x 4'8" (0.91m x 1.43m)

## Bedroom One

11'10" x 8'5" (3.63m x 2.57m)

## En-Suite

8'9" x 3'2" (2.67m x 0.98m)

## Bedroom Two

11'5" x 10'9" (3.50m x 3.28m)

## Bedroom Three

8'9" x 9'11" (2.67m x 3.03m)

## Bathroom

6'2" x 6'6" (1.90m x 2.00m)

## EXTERIOR

## Garage

9'3" x 16'9" (2.83m x 5.12m)



[Directions](#)





Floor Plan

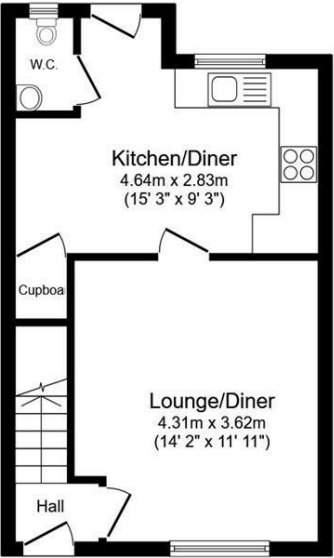

Ground Floor

Floor area 35.3 sq.m. (380 sq.ft.)



First Floor

Floor area 49.0 sq.m. (527 sq.ft.)

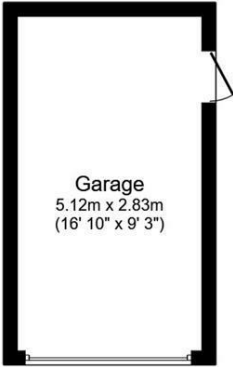

Garage

Floor area 14.5 sq.m. (156 sq.ft.)

Total floor area: 98.8 sq.m. (1,064 sq.ft.)

This floor plan is for illustrative purposes only. It is not drawn to scale. Any measurements, floor areas (including any total floor area), openings and orientations are approximate. No details are guaranteed, they cannot be relied upon for any purpose and do not form any part of any agreement. No liability is taken for any error, omission or misstatement. A party must rely upon its own inspection(s). Powered by [www.Propertybox.io](http://www.Propertybox.io)

These particulars, whilst believed to be accurate are set out as a general outline only for guidance and do not constitute any part of an offer or contract. Intending purchasers should not rely on them as statements of representation of fact, but must satisfy themselves by inspection or otherwise as to their accuracy. No person in this firm's employment has the authority to make or give any representation or warranty in respect of the property.

