



The Willows The Woodlands Chesterfield, S43 3LF



Noble Living are delighted to bring to the open market these modern & spacious three bedroom town houses situated in The Woodlands estate affording an exclusive gated facility and private rear gardens which are laid to lawn with flagged patio areas. These homes have been designed and developed to a very high standard with quality fixtures and fittings including oak and chrome staircases, oak style cottage doors, high gloss grey kitchens and low running costs due to a variety of eco-friendly green methods installed. The development also features electric gates and a CCTV security system. The development is situated within easy reach of Junction 29a of the M1 motorway network, the buzzing Chesterfield town centre just 15 minutes by car, less than 2 hours by train from Chesterfield to London, and the stunning Peak District National Park just a 25 minute drive from the Woodlands; this gated community is the perfect place to call home for commuting professionals and families alike.

- NEW BUILD
- THREE BEDROOM TOWN HOUSE
- GATED COMMUNITY
- GAS CENTRAL HEATING
- DOUBLE GLAZING
- INTERGATED APPLIANCES
- ENCLOSED GARDEN TO REAR
- EASY REACH OF M1 MOTORWAY
- TENANTS IN SITU
- £10,000 P/A INCOME

Offers over £160,000

Viewing

Please contact our Doncaster Office on 01302771708 if you wish to arrange a viewing appointment for this property or require further information.

GROUND FLOOR 26.95 sq. m.
(290.04 sq. ft.)

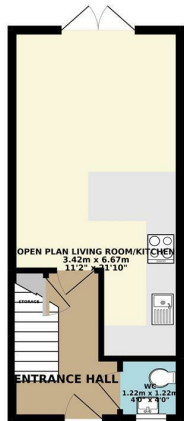

1ST FLOOR 26.95 sq. m.
(290.04 sq. ft.)

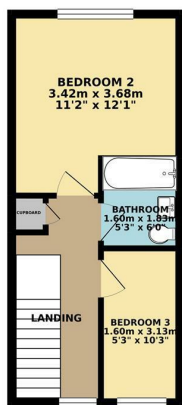

2ND FLOOR 26.95 sq. m.
(290.04 sq. ft.)

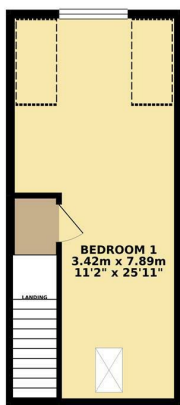

TOTAL FLOOR AREA : 80.84 sq. m. (870.11 sq. ft.) approx.

Whilst every attempt has been made to ensure the accuracy of the floorplan contained here, measurements of doors, windows, rooms and any other items are approximate and no responsibility is taken for any error, omission or misstatement. This plan is for illustrative purposes only and should be used as such for any prospective purchase. The services, systems and appliances shown have not been tested and no guarantee as to their operability or efficiency can be given.
Made with Metropix (2020)

The Woodlands, Poolsbrook, Chesterfield, S43 3LF

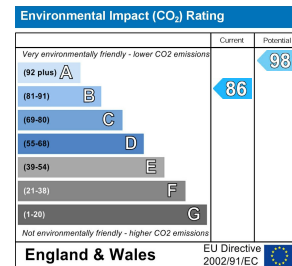
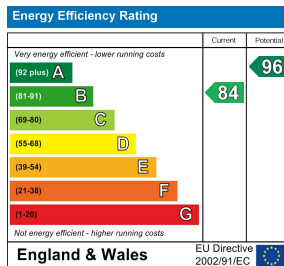

These particulars, whilst believed to be accurate are set out as a general outline only for guidance and do not constitute any part of an offer or contract. Intending purchasers should not rely on them as statements of representation of fact, but must satisfy themselves by inspection or otherwise as to their accuracy. No person in this firms employment has the authority to make or give any representation or warranty in respect of the property.