



The Gatehouse, Leamington Spa, CV31 3QA

**SHELDON
BOSLEY
KNIGHT**

LAND AND
PROPERTY
PROFESSIONALS

Property Description

*** AVAILABLE 13th MAY *** Set within a private, secure gated community this mid floor two-double bedroom apartment is excellently located to reach all amenities and major commute routes.

Modern presentation throughout and comprises in brief: Hallway with storage cupboard, spacious and light living room with wood effect laminate flooring and Juliet balcony looking over the communal gardens, breakfast kitchen with appliances included (washing machine, dishwasher and stand-alone fridge/freezer), two well-proportioned double bedrooms, both with built in mirrored wardrobes. Bathroom with full suite including shower over bath.

With lift access to all floors, residents parking and designated bicycle shelter this property is offered FURNISHED. Council Tax Band C. Energy rating C. Sorry, no pets are permitted within this development due to the headlease.





Approx. 61.2 sq. metres (658.9 sq. feet)

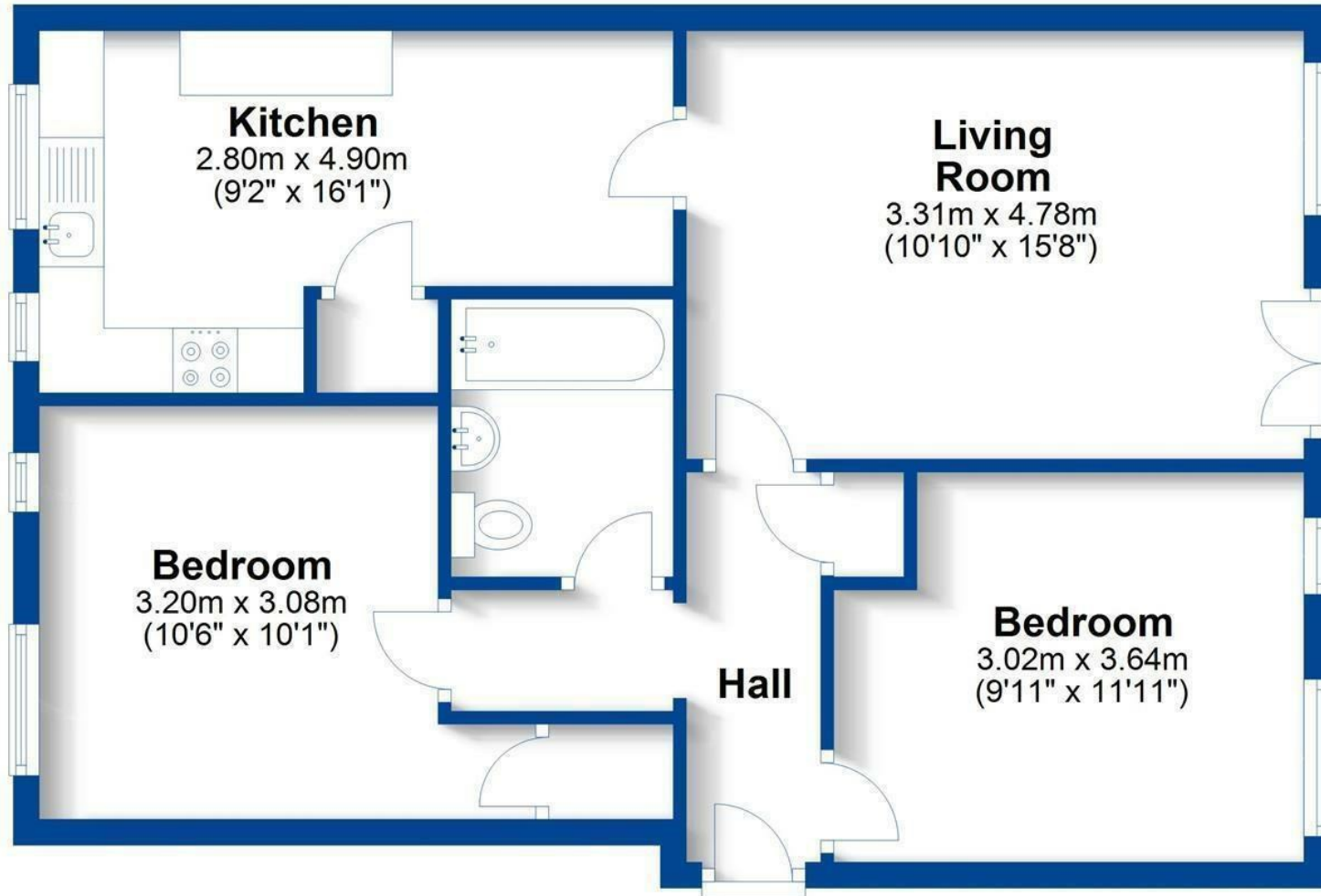

Total area: approx. 61.2 sq. metres (658.9 sq. feet)

This plan is for illustration purposes only and should not be relied upon as a statement of fact
Property of Sheldon Bosley Knight Limited. Not to be reproduced

Key Features

- AVAILABLE 13th MAY
- Leamington Spa
- Two Double Bedrooms
- Mid-Floor Apartment
- Furnished
- Secure Gated Community
- Allocated Parking & Bicycle Shelter
- Close to Town Centre & Victoria Park
- Energy Rating C
- Council Tax Band C

£1,195 PCM