



Jury Street, Warwick, CV34 4EY

**SHELDON
BOSLEY
KNIGHT**

LAND AND
PROPERTY
PROFESSIONALS

Property Description

*** AVAILABLE EARLY/MID NOVEMBER ***

This wonderfully appointed two-bedroom ground floor apartment is positioned close to Warwick Castle, Warwick town centre and the River Avon.

The accommodation comprises in brief - Entrance hall, good sized bathroom with full suite including shower over bath, spacious open plan living room/kitchen with range of integrated appliances including fridge/freezer and utility cupboard (which houses the washing machine), well-proportioned main bedroom with ensuite shower room and built in wardrobes, further bedroom with fitted storage and patio providing access to the communal courtyard area.

Warwick has a variety of shopping, cafés, restaurants and recreational facilities, there are regular trains from nearby Warwick Station, and from Warwick Parkway and Leamington Spa to London Marylebone. The motorway network is easily accessible with junction 15 of the M40 a few miles to the south of the town.

With an allocated car parking space, positioned directly to the rear of the building and accessed from Castle Lane through secure electrically operated security gates this property is offered Part-furnished. Energy Rating C. Council Tax Band D. (SORRY NO PETS ALLOWED)





Key Features

- AVAILABLE EARLY/MID NOVEMBER
- Warwick
- Two Bedrooms, Two Bathrooms
- Ground Floor Apartment
- PART-FURNISHED
- Secure Allocated Parking Space
- Town Centre Location
- Energy Rating C
- Council Tax Band D
- SORRY NO PETS ALLOWED

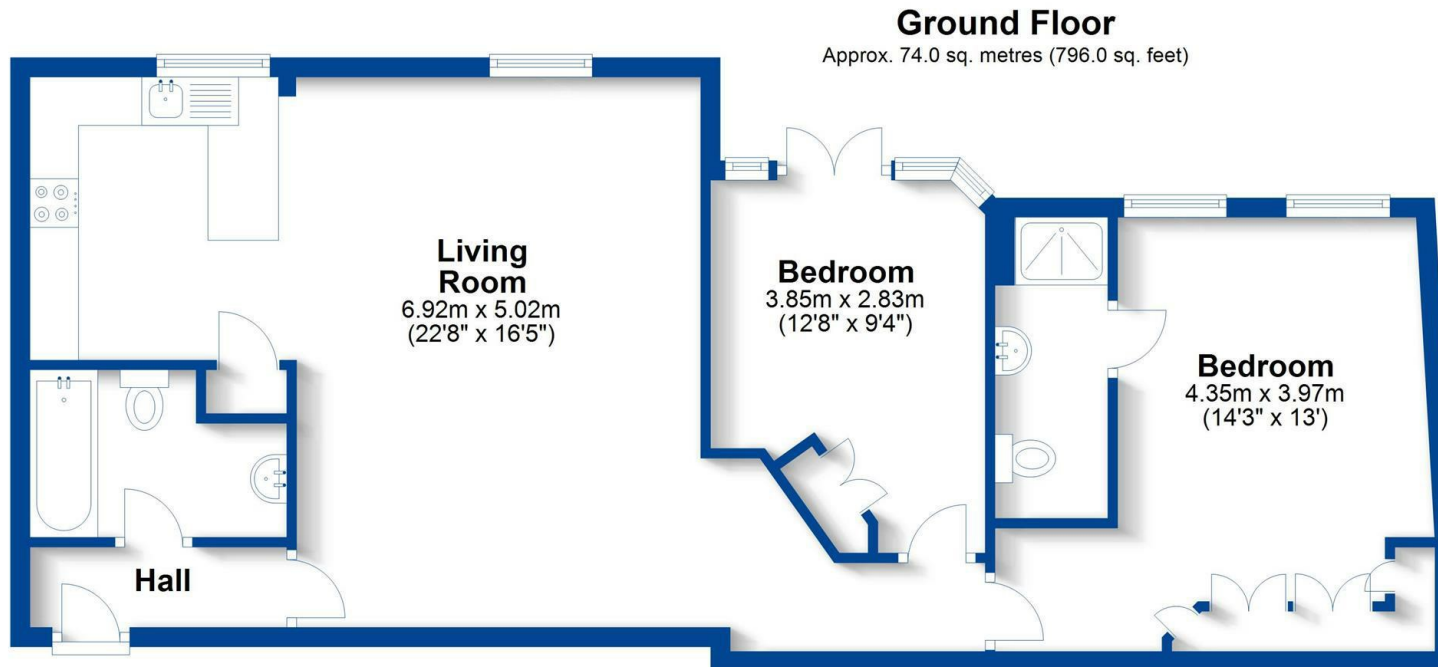

Total area: approx. 74.0 sq. metres (796.0 sq. feet)

This plan is for illustration purposes only and should not be relied upon as a statement of fact
Property of Sheldon Bosley Knight Limited. Not to be reproduced

£1,350 PCM