



Priam Circus, Warwick, CV34 6GF

**SHELDON
BOSLEY
KNIGHT**

LAND AND
PROPERTY
PROFESSIONALS

Property Description

*** AVAILABLE 28th SEPTEMBER ***

This modern two bedroom terraced house is located in Warwick Gates, only a short distance to Leamington Spa Town Centre, train station, major supermarkets and provides great commute access to M40 corridor and A46.

The property comprises in brief; entrance hallway with WC, living room with ample space to create dining area and patio doors leading to the rear private garden. Modern kitchen with appliances included (fridge, freezer, washing machine).

To the first floor: Two double bedrooms, main bedroom with storage cupboard/wardrobe, bathroom with full suite including shower over bath.

With a pretty landscaped garden and off road parking this property is offered UNFURNISHED. Council Tax C. Energy Rating B.

Please note that previous marketing images have been used





Key Features

- AVAILABLE 28th SEPTEMBER
- Heathcote, Warwick
- Mid-Terraced House
- Two Bedrooms
- Excellent Commute Links
- Close to Leamington Town Centre
- Major Supermarkets Nearby
- Energy Rating C
- Council Tax Band B
- One Pet Carefully Considered

Ground Floor

Approx. 28.3 sq. metres (304.9 sq. feet)

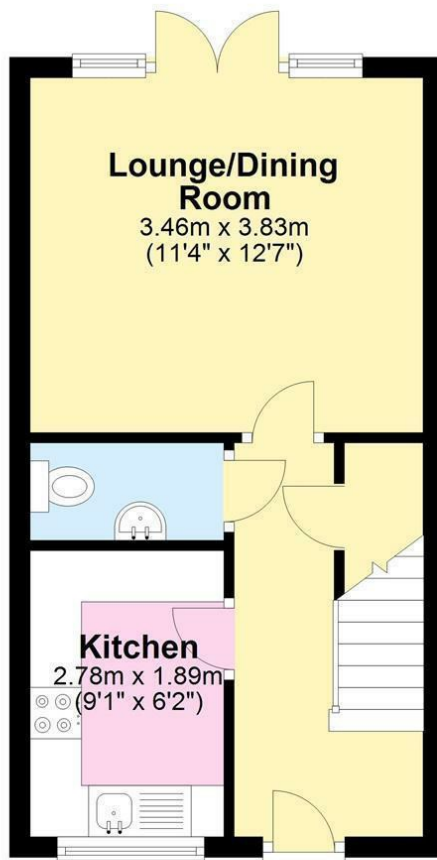

First Floor

Approx. 28.7 sq. metres (309.2 sq. feet)

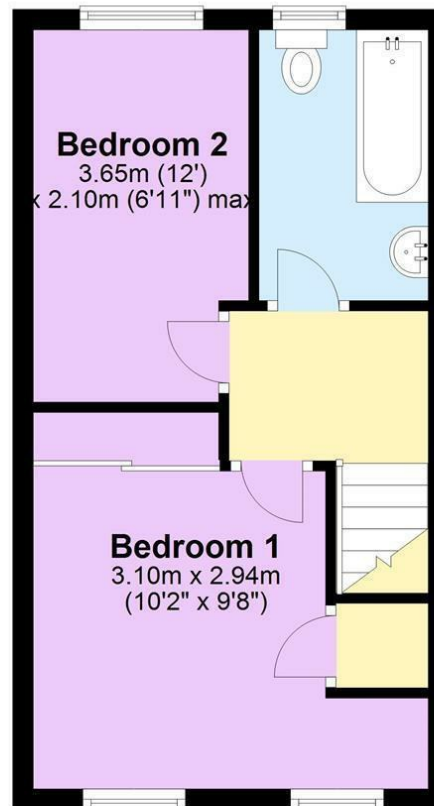

Total area: approx. 57.0 sq. metres (614.0 sq. feet)

£1,175 PCM