



HR ESTATE AGENTS

4 Bedrooms

Farmhouse

Guide Price

£1,200,000

Located in

Coventry





Woodlands poultry farm Ted Pitts

Coventry | CV5 9FL



This property offers a remarkable opportunity for those seeking a spacious family home with additional accommodation and equestrian potential, all set within a picturesque countryside setting. Here's an overview:

****Main House:****

- ****Four Bedrooms:**** Located on the first floor, two of the bedrooms benefit from en suite shower rooms.
- ****Living Spaces:****
 - Two lounges for ample family living and entertaining.
 - A separate living room for additional versatility.
 - Conservatory overlooking the surrounding countryside.
- ****Ground Floor Amenities:****
 - Modern kitchen with utility room.
 - Office space.
 - Ground-floor bathroom.
- ****Heating and Windows:**** Gas central heating and double glazing ensure comfort and efficiency.

****Annexes:****

- ****Annex 1:**** Includes an open-plan living area, office, bedroom, and en suite shower room.

Woodlands poultry farm Ted

£1,200,000



- 8 + Acres
- Character Farm House
- Approximately 2300ft²
Detached Workshop
- 5,000 sq ft of Buildings
- Two Annexes

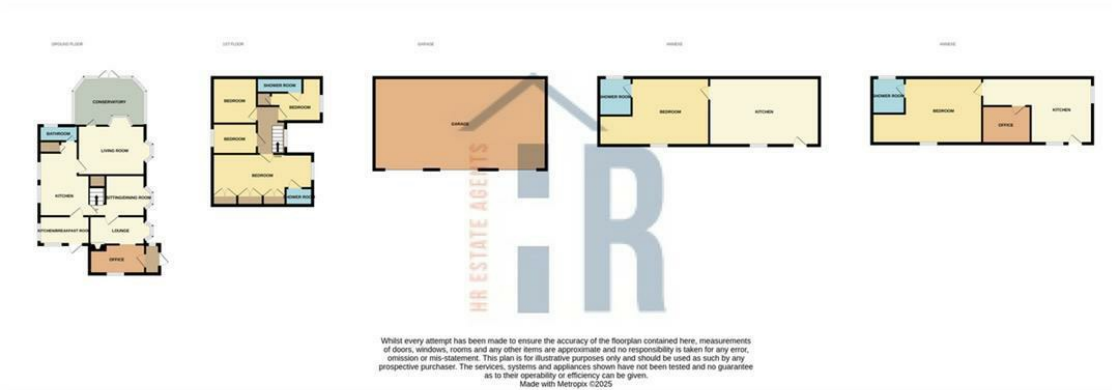

Council Tax Band

Local Authority

Agents Note: Whilst every care has been taken to prepare these particulars, they are for guidance purposes only. All measurements are approximate and are for general guidance purposes only and whilst every care has been taken to ensure their accuracy, they should not be relied upon and potential buyers/tenants are advised to recheck the measurements.

Energy Efficiency Rating		
	Current	Potential
Very energy efficient - lower running costs		
(92 plus) A		81
(81-91) B		
(69-80) C		
(55-68) D		
(39-54) E	48	
(21-38) F		
(1-20) G		
Not energy efficient - higher running costs		
England & Wales		EU Directive 2002/91/EC

Number Three Siskin Drive
Coventry
CV3 4FJ

HR ESTATE AGENTS