

PROMINENCE
ESTATES



RESIDENTIAL
PROPERTY EXPERTS

COVENTRY, WARWICKSHIRE
& LEAMINGTON SPA

HOCKETT STREET,
CHEYLESMORE, COVENTRY, CV3 5FR

PRICE GUIDE
£299,995

HOCKETT STREET



PROMINENCE ESTATES

Welcome to your newly renovated home in the heart of Cheylesmore. This stylish and ultra-modern 3 bedroom mid-terraced home has been thoughtfully refurbished throughout, boasting modern amenities and convenient features including a bespoke media wall and open plan kitchen/diner with bi-fold doors.

Upon entering the home, you are welcomed with the hallway, leading to a generously proportioned family living room with a bespoke media wall and integrated fireplace, ideal for family gatherings. The ground floor further features a convenient cloakroom with WC, while the extended modern kitchen seamlessly integrates with an open-plan dining area, accentuated by bi-fold doors that invite natural light and provide seamless access to the decking area and newly landscaped garden.

Ascending the stairs, the first floor reveals three well-appointed bedrooms, each offering ample space for relaxation and restful nights. A modern fully tiled shower room completes the upper level, showcasing exquisite attention to detail and contemporary design elements.

This exceptional property leaves no stone unturned in its pursuit of luxury living and is offered to the market with no upward chain, ensuring a hassle-free transition for prospective buyers. The property also benefits from newly fitted blinds throughout and integrated blinds in the bi-fold doors.

Externally, the landscaped garden provides a peaceful retreat, perfect for enjoying your morning coffee or hosting summer barbecues with friends and family. Plus, the added convenience of a private driveway

offers off-road parking for easy access.

Located in the heart of Cheylesmore, residents benefit from excellent motorway connectivity, proximity to acclaimed schools, and convenient access to the city centre, along with the nearby Daventry Road parade of shops and eateries, promising a lifestyle of utmost convenience and comfort.

Living Room (into bay)

20'1" x 10'1"

Kitchen/Diner

17'2" x 15'5"

W/c

6'5" x 2'4"

Master Bedroom (into bay)

11'11" x 10'5"

Bedroom Two

10'5" x 9'6"

Bedroom Three

7'1" x 5'4"

Bathroom

4'11" x 5'3"





GROUND FLOOR

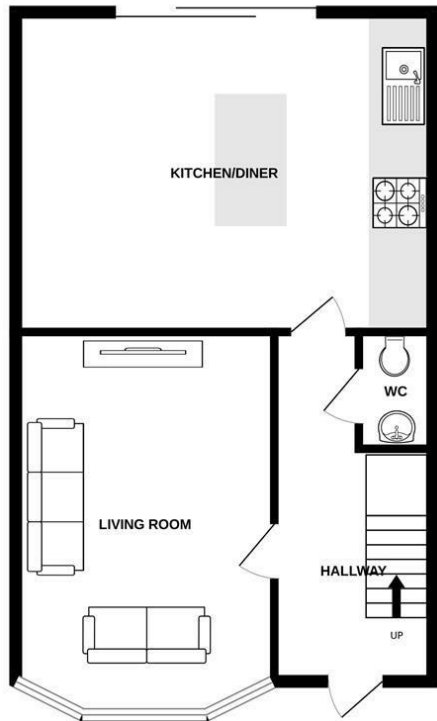

1ST FLOOR

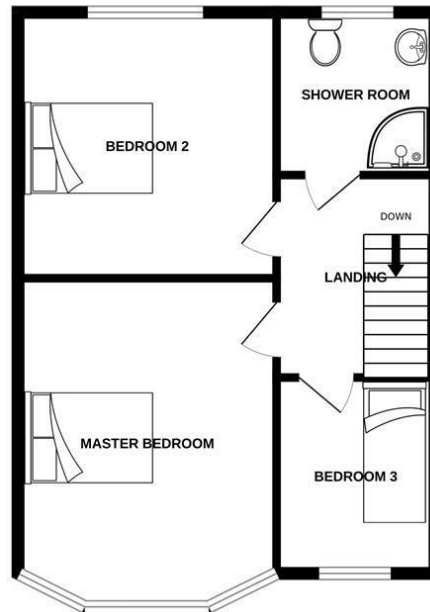

Whilst every attempt has been made to ensure the accuracy of the floorplan contained here, measurements of doors, windows, rooms and any other items are approximate and no responsibility is taken for any error, omission or mis-statement. This plan is for illustrative purposes only and should be used as such by any prospective purchaser. The services, systems and appliances shown have not been tested and no guarantee as to their operability or efficiency can be given.
Made with Metropix ©2024



Energy Efficiency Rating

	Current	Potential
Very energy efficient - lower running costs		
(92 plus) A		
(81-91) B		
(69-80) C		
(55-68) D		
(39-54) E		
(21-38) F		
(1-20) G		
Not energy efficient - higher running costs		
		77
	59	
England & Wales	EU Directive 2002/91/EC	

Prominence Estates
5 Queen Isabels Avenue,
Cheylesmore,
Coventry,
CV3 5GE

02476 309 826
sales@prominenceestates.com
www.prominenceestates.com

