



28 Sweetbriar Lane, Holcombe

Guide Price **£550,000**





28 Sweetbriar Lane

Holcombe, Dawlish

Council Tax band: E

Tenure: Freehold

EPC Energy Efficiency Rating: C

EPC Environmental Impact Rating:

- BEAUTIFULLY PRESENTED BUNGALOW IN LEVEL LOCATION OFFERING FANTASTIC SEA, COASTAL AND COUNTRYSIDE VIEWS
- VIEWING HIGHLY RECOMMENDED
- HALL, UTILITY ROOM, LIVING ROOM / DINER, KITCHEN, THREE BEDROOMS ONE WITH EN SUITE SHOWER ROOM, FAMILY ROOM / SECOND RECEPTION, FAMILY SHOWER ROOM
- RECENTLY FITTED MODERN WREN KITCHEN
- COMPOSITE DECKED AREA PERFECT FOR AL-FRESCO DINING
- DRIVEWAY PARKING FOR 3 VEHICLES



You can include any text here. The text can be modified upon generating your brochure.





You can include any text here. The text can be modified upon generating your brochure.



You can include any text here. The text can be modified upon generating your brochure.



Ground Floor
135.8 sq.m. (1462 sq.ft.) approx.

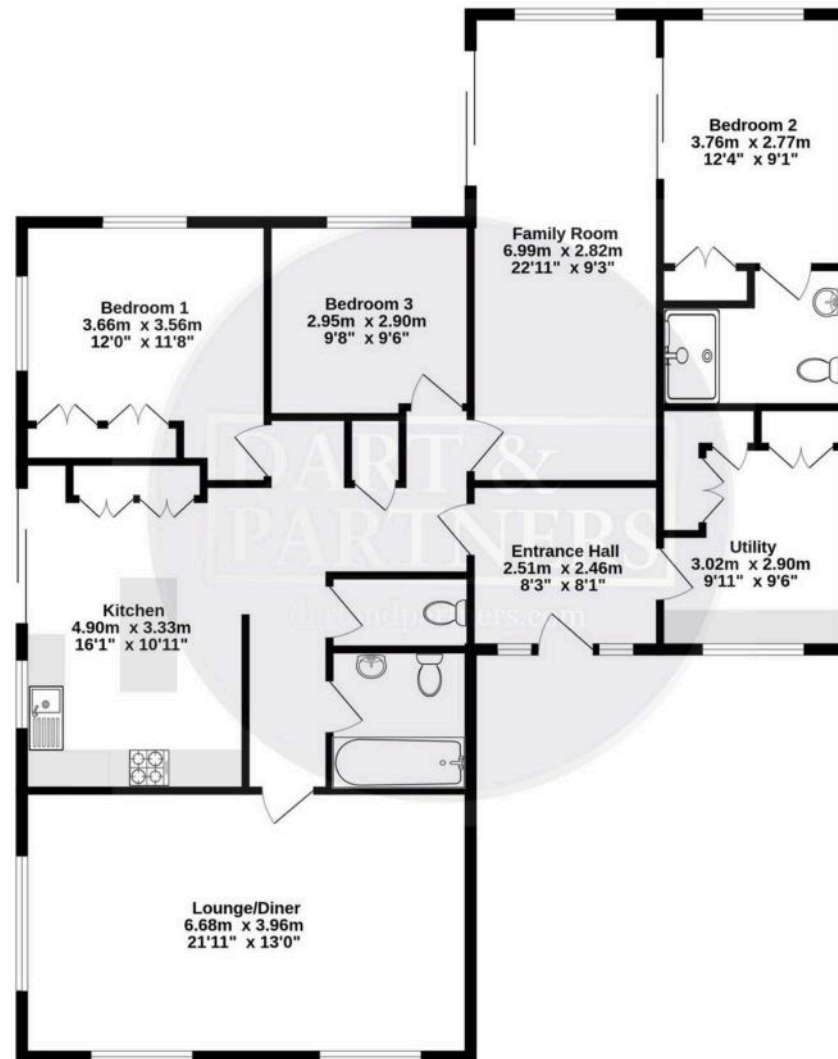

TOTAL FLOOR AREA : 135.8 sq.m. (1462 sq.ft.) approx.

Whilst every attempt has been made to ensure the accuracy of the floorplan contained here, measurements of floors, windows, rooms and any other items are approximate and no responsibility is taken for any error, omission or mis-statement. This plan is for illustrative purposes only and should be used as such by any prospective purchaser. The services, systems and appliances shown have not been tested and no guarantee as to their operability or efficiency can be given.
Made with Metropix ©2025

