

Horton & Senate



1238 Yardley Wood Road, Shirley, Solihull, B90 1JX

Offers Over £300,000

- Semi Detached House
- Two Receptions
- Sold With No Upward Chain
- Three Double Bedrooms
- Large Driveway
- Generous Rear Garden

1238 Yardley Wood Road, Solihull B90 1JX

This three-bedroom house in Shirley presents a wonderful opportunity for those seeking a comfortable and well-located residence. Do not miss the chance to make this lovely property your own.

3

1

2

Council Tax Band: C







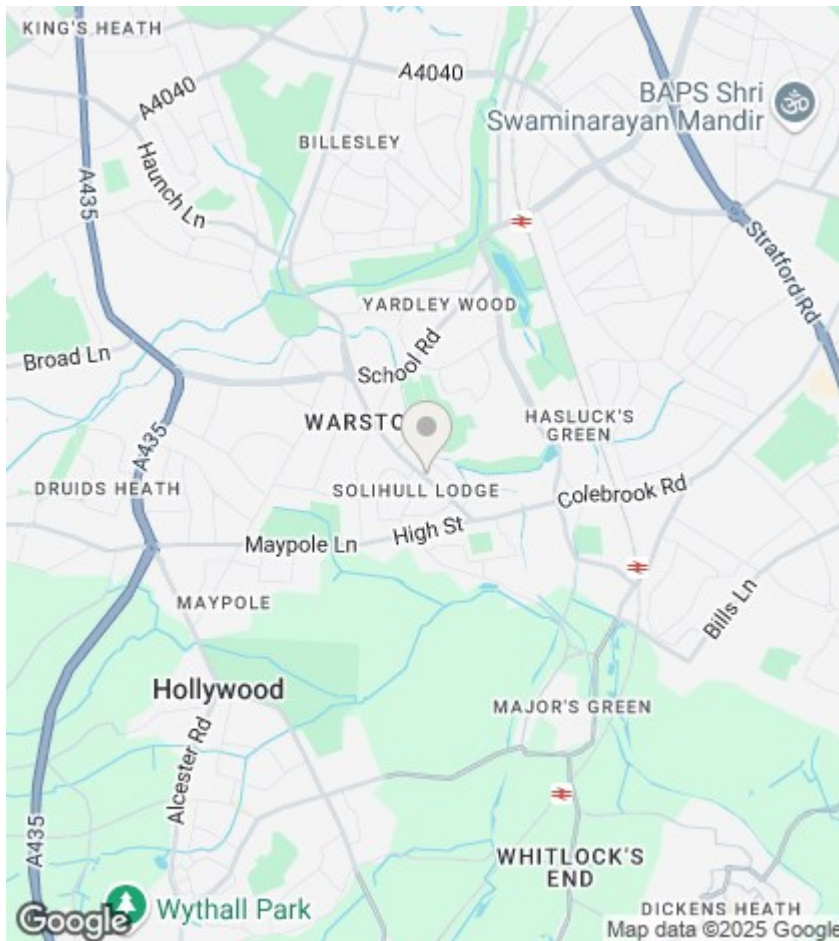

Directions

Viewings

Viewings by arrangement only. Call 0121 663 0099 to make an appointment.

EPC Rating:

Energy Efficiency Rating		Current	Potential
Very energy efficient - lower running costs			
(92 plus)	A		
(81-91)	B		
(69-80)	C		
(55-68)	D		
(39-54)	E		
(21-38)	F		
(1-20)	G		
Not energy efficient - higher running costs			
England & Wales		EU Directive 2002/91/EC	

Ground Floor

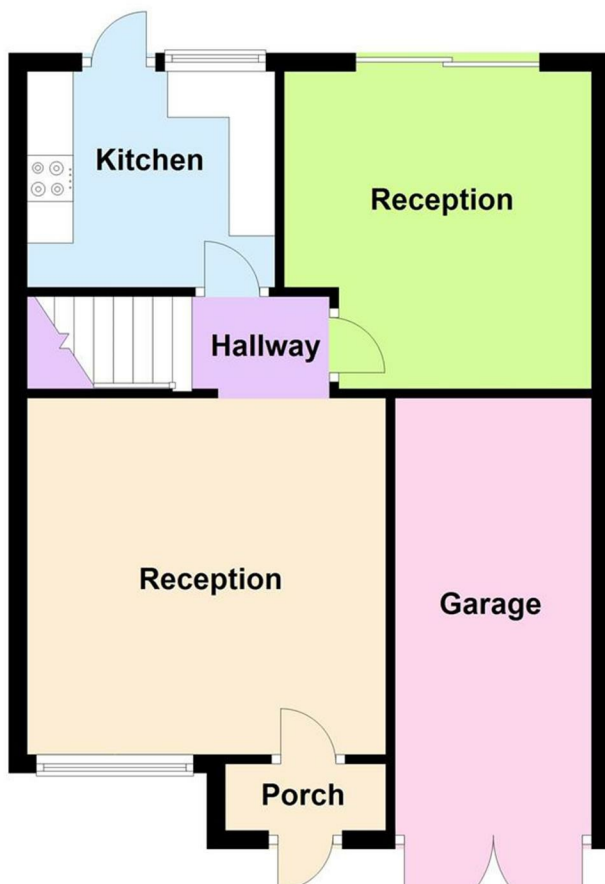

First Floor

