

Horton & Senate



143 St. Johns Close, Knowle, Solihull, B93 0NL

£389,950

- Mid Terrace Property
- Rear Garden
- Council Tax Band D
- Three Bedrooms
- Well Presented
- EPC Rating D
- Gas Central Heating
- Modern Kitchen

Ground Floor

Approx. 33.8 sq. metres (364.1 sq. feet)

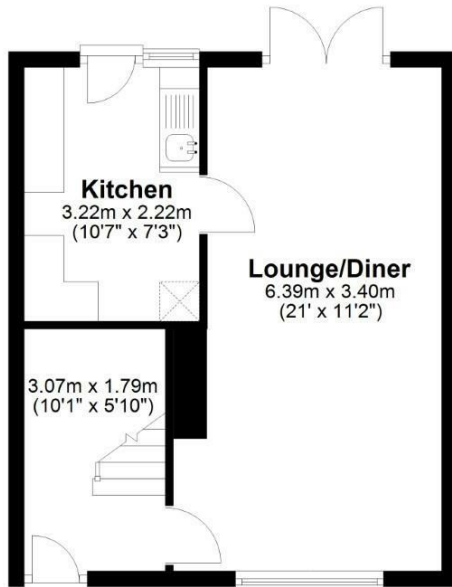

First Floor

Approx. 38.1 sq. metres (410.1 sq. feet)

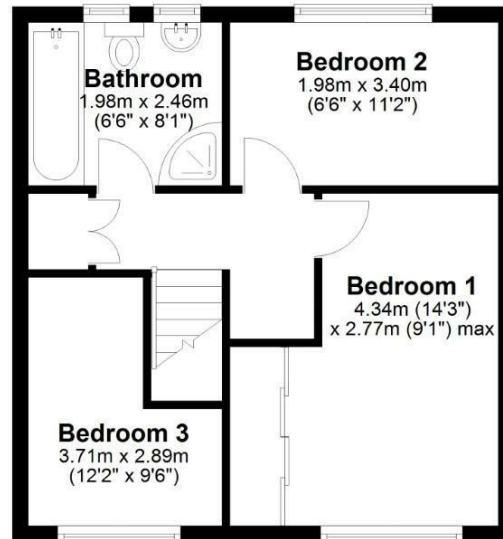

Total area: approx. 71.9 sq. metres (774.2 sq. feet)

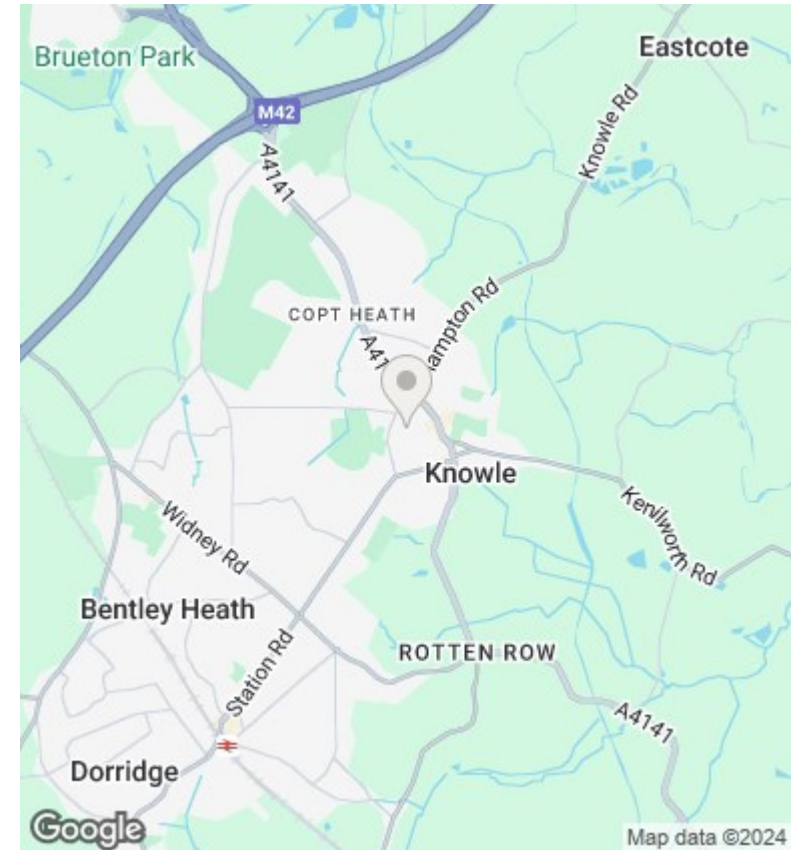

Directions

Viewings

Viewings by arrangement only. Call 01564 773200 to make an appointment.

Council Tax Band

D

EPC Rating:

D

Energy Efficiency Rating		Current	Potential
Very energy efficient - lower running costs			
(92 plus) A			88
(81-91) B			
(69-80) C			
(55-68) D		68	
(39-54) E			
(21-38) F			
(1-20) G			
Not energy efficient - higher running costs			
England & Wales		EU Directive 2002/91/EC	