

Horton & Senate



14 Wilsons Road, Knowle, Solihull, B93 0HZ

£1,150

- Mid Terrace Property
- South Facing Rear Garden
- Secondary Glazing
- Unfurnished
- 2 Double Bedrooms
- Refitted Kitchen/Diner
- Refitted Bathroom
- Fully Refurbished
- Gas Central Heating
- Available start of June

49a Station Road, Knowle, Solihull, West Midlands, B93 0HN
01564 773200

info@senateproperty.co.uk

Ground Floor

Approx. 25.4 sq. metres (273.1 sq. feet)

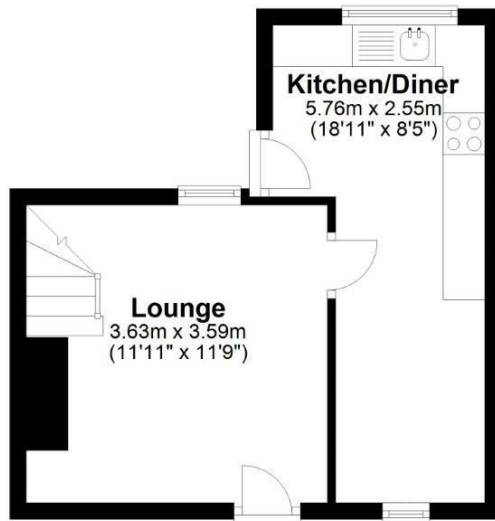

First Floor

Approx. 25.8 sq. metres (277.7 sq. feet)



Total area: approx. 51.2 sq. metres (550.8 sq. feet)

This floor plan is not to scale and is for illustration/marketing purposes of Senate Property Services Ltd.
Plan produced using PlanUp.

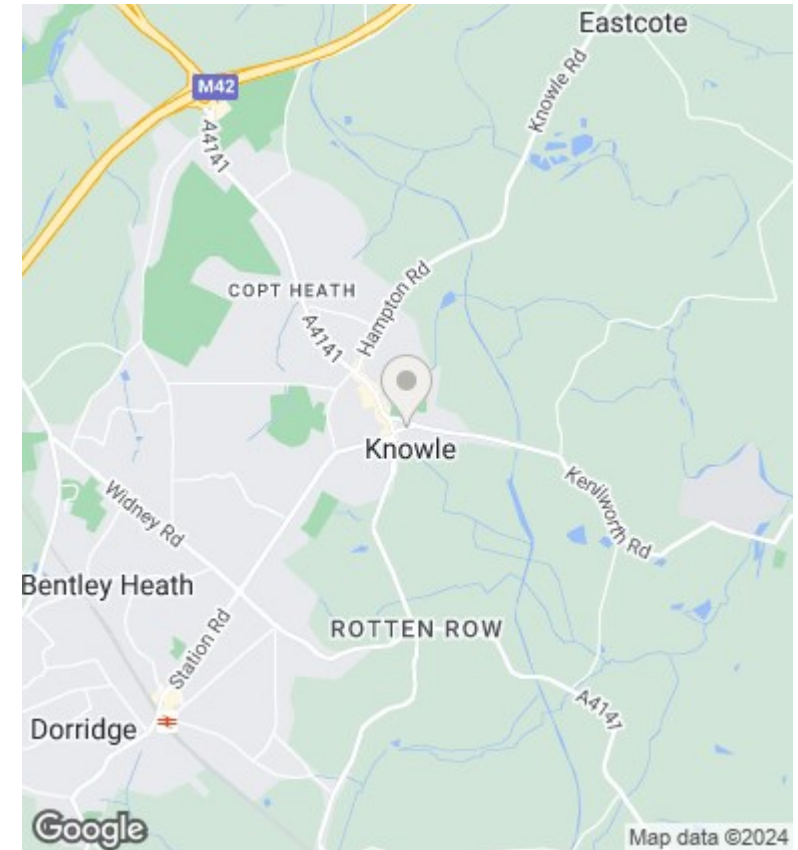

Directions

Viewings

Viewings by arrangement only. Call 01564 773200 to make an appointment.

Council Tax Band

B

EPC Rating:

D

Energy Efficiency Rating		Current	Potential
Very energy efficient - lower running costs			
(92 plus)	A		88
(81-91)	B		
(69-80)	C		
(55-68)	D	66	
(39-54)	E		
(21-38)	F		
(1-20)	G		
Not energy efficient - higher running costs			
England & Wales		EU Directive 2002/91/EC	