

# Offices To Let

## Pt 5<sup>th</sup> Floor, WestWorks, White City Place, W12 7FQ



### Location

White City Place is made up of a collection of re-imagined buildings set around a central avenue with high quality retail, restaurants, gardens and gathering spaces.

The regeneration of White City includes a new Imperial College London campus, the expansion of Westfield London into Europe's largest shopping centre, a new cultural focus for West London at Television Centre, homes from Berkeley St James, and the business district White City Place.

### Description

Designed by award winning architects Allies & Morrison, WestWorks is a 290,000 sq ft building with a WiFi enabled co-working reception and a communal garden and terrace.

The part 5<sup>th</sup> floor offers 18,000 sq ft of fully fitted accommodation. Further splits are available on request.

### Specification

- Fully fitted
- 3.8 m ceiling height
- 10,000 sq ft communal terrace
- Cycle parking, showers and lockers
- Car parking available
- LED lighting
- Air conditioning
- Occupational density of 1:8 sq m
- 8 passenger lifts

Floor	Area (sqft)	Area (sqm)
Pt 5 <sup>th</sup> Floor	18,025	1,674

## Fifth Floor Plan –

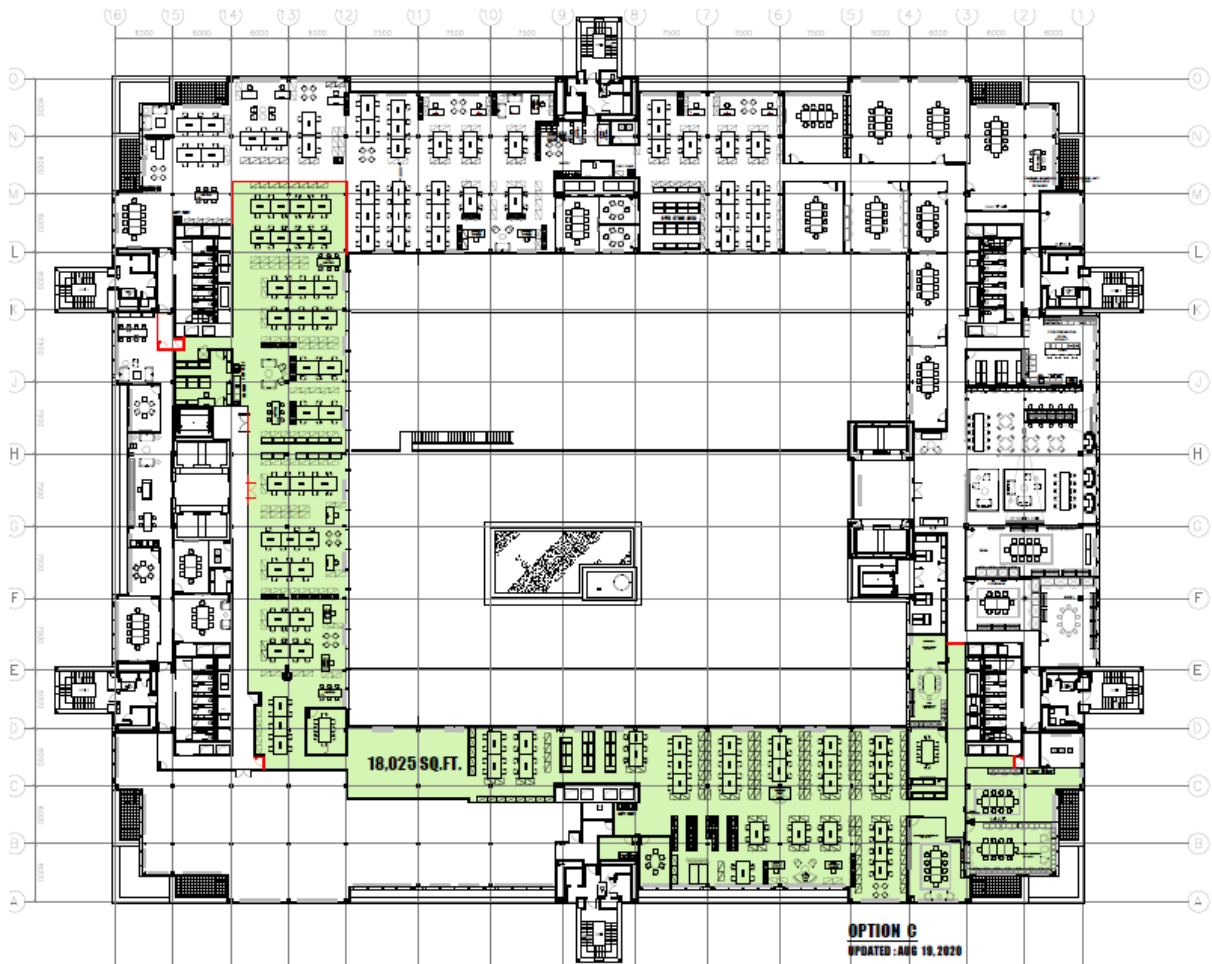

## Terms

- **Lease:** Available by way of a sub-lease of the lease expiring August 2024. A longer term is available until August 2029 by arrangement.
- **Quoting Rent:** £57.50 per sq ft
- **Business Rates:** est. £17.00 per sq ft
- **Service Charge:** est. £10.20 per sq ft

## Contacts – For further information please contact Savills or our joint agents Frost Meadowcroft.

**Angus Tullberg**  
Savills  
0207 075 2858  
angus.tullberg@savills.com

**Hunter Booth**  
Savills  
0207 409 8832  
hunter.booth@savills.com

**James Mann**  
Savills  
020 7299 3049  
James.mann@savills.com

Important Notice: Savills, their clients and any joint agents give notice that:

1. They are not authorised to make or give any representations or warranties in relation to the property either here or elsewhere, either on their own behalf or on behalf of their client or otherwise. They assume no responsibility for any statement that may be made in these particulars. These particulars do not form part of any offer or contract and must not be relied upon as statements or representations of fact.
2. Any areas, measurements or distances are approximate. The text, photographs and plans are for guidance only and are not necessarily comprehensive. It should not be assumed that the property has all necessary planning, building regulation or other consents and Savills have not tested any services, equipment or facilities. Purchasers must satisfy themselves by inspection or otherwise. August 2017.



*Communal Terrace and Cafe*



*Breakout Area*



*Meeting Room*



*Meeting Room*



*Open Plan Reception Cafe*



*Entrance*