

ARC
West London

Waterfront

WATERFRONT

GROUND & 4TH FLOOR

3,625 SQ FT TO 22,634 SQ FT

FITTED LAB AVAILABLE

SPRING 2024

BETTER WORKING ON THE BANKS OF THE THAMES

Come and work in ARC West London's recently refurbished world-class, flexible, lab building designed to enable your passion for innovation and get your ideas flowing.

We've worked closely with Bulb Laboratories, one of our key partners, to curate compliant spaces for everything from cell and tissue culture research to analysis, synthesis and diagnostics.

- 3,265 – 22,634 sq ft fitted CL2 lab space over 2 floors
- Top floor with private terrace and river views
- Landscaped gardens and river setting
- 10 mins walk from Hammersmith tube
- New end of journey experience with bike racks and shower facilities
- Full height Atrium with cafe and communal seating area
- Established location, home to Motherlabs fully fitted and managed laboratory space
- Ability to scale with new 150,000 sq ft Refinery lab building coming in 2024
- Close proximity to Charing Cross Hospital and Imperial College White City campus

A LAB LIKE NO OTHER



Waterfront lets you flow. It's part of the 240,000 sq ft ARC West London campus designed to help scientists and innovators thrive. At Waterfront you can easily scale up as required, so that as you grow your business you don't need to relocate, not that you would ever want to.



A 21ST CENTURY SCIENCE & INNOVATION COMMUNITY

Our campus is curated inside and out, creating vibrant communities with rich event programmes helping you to attract and retain the best talent.

Our Community and Events team is standing by ready to help you get the most out of everything on offer at Waterfront – whether it's hooking up with like-minded businesses, or getting your teeth into street food. It's a packed schedule every week in our event spaces.

Check our app to see what's going on, and you'll discover how Waterfront will work for you.

WORK WELL AT WATERFRONT

Healthy body, healthy mind. Waterfront at ARC West London promises a great work life balance with cycle use to get to and from work actively encouraged through cycle lockers, showers and even an in-house bike mechanic to keep your wheels turning. And for less strenuous exercise, join one of the regular yoga classes.



LEVEL UP YOUR LAB



Waterfront's penthouse suite on the fourth floor offers 10,961 sq ft CL2 lab and write-up space plus a large roof terrace providing breathtaking views over the river. It's a stunning space that's designed to impress your visitors and attract the very best staff.



LOVE THE LOCATION

Working in Waterfront means never being far from a great pub, bar or restaurant as well as having the best of the arts close by.

And with four tube lines a few minutes walk away you're seriously well connected for commuting, for heading into town or heading off to the airport.

- 01 Fulham Reach Boat Club
- 02 FRAME Hammersmith
- 03 Fitness & Squash Centre
- 04 Reach Fit
- 05 Better Gym
- 06 Virgin Active
- 07 Pure Gym
- 08 Boom Cycle

- 01 Eventim Apollo
- 02 Lyric Theatre
- 03 Eat17
- 04 Brasserie Blanc
- 05 Tesco Express
- 06 The Blue Anchor
- 07 The Blue Boat
- 08 The River Cafe
- 09 The Distillers
- 10 Fulham Reach Boat Club
- 11 Pret A Manger
- 12 Caffè Nero
- 13 Little Waitrose
- 14 Boots Pharmacy
- 15 Riverside Studios
- 16 Café Plum
- 17 Bread Lab
- 18 Truth
- 19 Antipode
- 20 Pure
- 21 Wasabi
- 22 Sam's Riverside Restaurant
- 23 Honest Burger
- 24 Riverside Bar & Kitchen
- 25 Sam's Larder

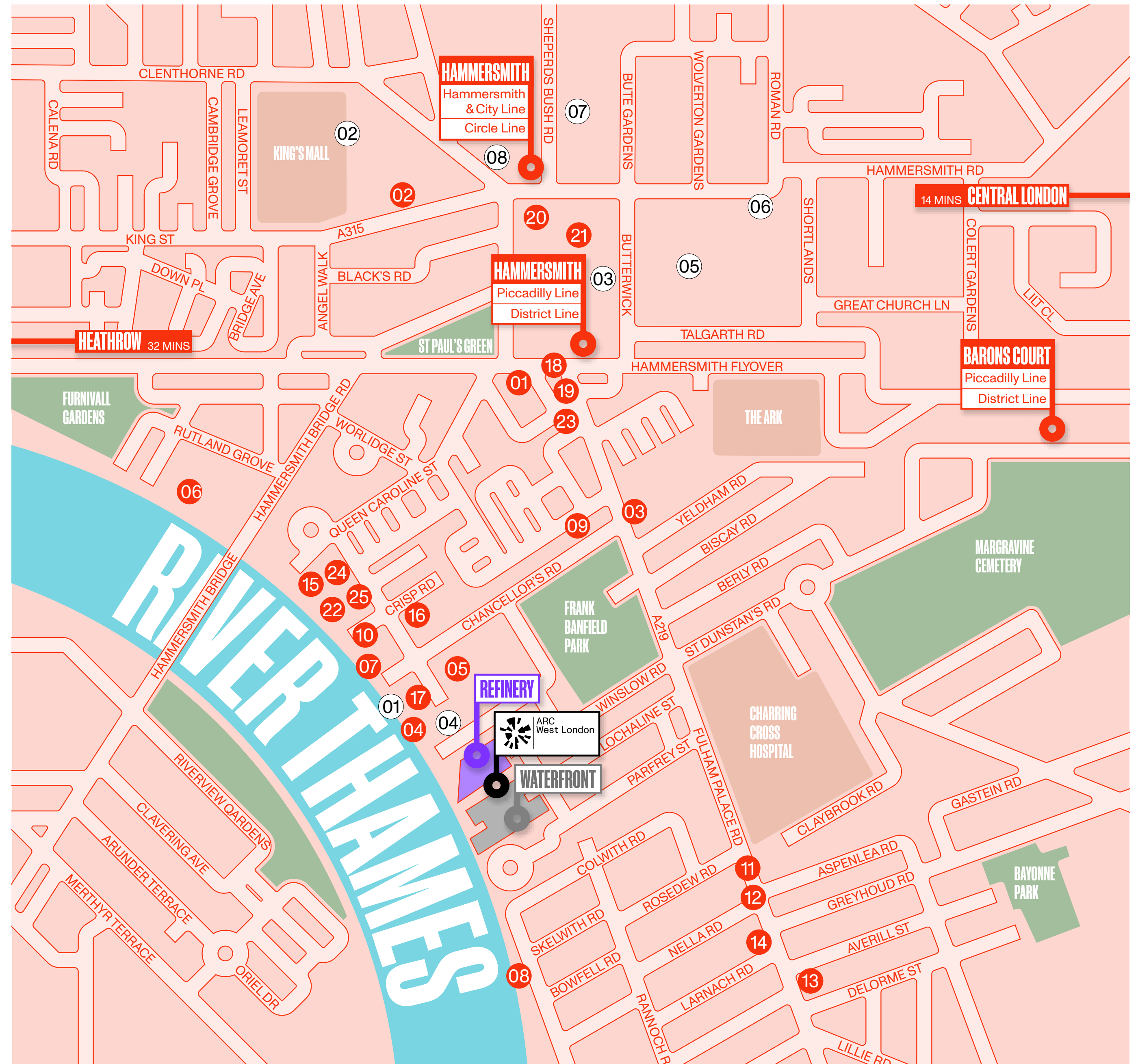

GETTING AROUND

Hammersmith is one of the most accessible locations by public transport in London. It has 4 tube lines offering direct access to 47% of London's Tube stations and 7 of its 13 rail terminals. By car it is easily accessed from the A4, the main arterial route from West London linking London to Heathrow, the M25 and motorway network.



to the West-End from Hammersmith Station using the Piccadilly line



to Heathrow Terminals 1, 2 & 3 from Hammersmith using the Piccadilly line



routes serve North, South, East and West London



of tube stations can be reached directly from Hammersmith

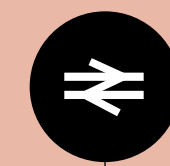

To Rail Terminals

VICTORIA

10 mins

PADDINGTON

13 mins

WATERLOO

21 mins

CANNON ST.

28 mins

LIVERPOOL ST.

30 mins

EUSTON

30 mins

KINGS CROSS

31 mins

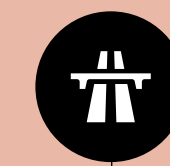

By Road

M4

4 mins

A40

10 mins

M4 (J1)

15 mins

M25 (J15)

17 mins

HEATHROW AIRPORT

25 mins

M40 (J1)

30 mins

M1 (J1)

50 mins



By Tube

WHITE CITY (WOOD LANE TUBE)

Hammersmith & City Line
4 mins

KNIGHTSBRIDGE

Piccadilly Line
11 mins

GREEN PARK

Piccadilly Line
16 mins

KING CROSS

Piccadilly Line
31 mins

HEATHROW AIRPORT

Piccadilly Line
32 mins

BANK (MONUMENT TUBE)

District Line
36 mins

LONDON CITY AIRPORT

District Line & DLR
53 mins

THAMES LIFE



The Thames is the heart of London and at Waterfront it's yours to explore. Take a stroll on the towpath, join a rowing club, get out on a two wheeled adventure. Discover historic sights and some of the capital's best-loved pubs, or go for something a little more upmarket with riverside fine dining experience at the River Cafe and Brasserie Blanc.

While your experiments are running, it's time to explore. Hammersmith has welcoming bars, global cuisine and diverse retail right on our doorstep. World-class culture options nearby include the Lyric Theatre and the Eventim Apollo and within 500m of Waterside you'll find more than 17 dining options, and that's even before you consider the delicious variety of food on offer inside ARC West London itself.



Motherlabs



ARC West London is home to Motherlabs – flexible, fully-managed lab space.

Motherlabs provides the critical infrastructure to help organisations to grow sustainably, to smartly innovate and to move ideas seamlessly from concept, to lab, to commercialisation at pace.

Motherlabs at ARC West London has brand new containment level 2 lab spaces, ranging from 670 sq ft to 1,600 sq ft in size.

Key specifications include:

- Private lab with dedicated write-up/office space
- Established Lab protocols
- 6 ach/hr
- Vulcathene drainage
- Vinyl lab flooring
- Perimeter dado trunking
- Specialist piped gases
- On-site lab manager
- Shared facility including Autoclave, Dishwasher, Ice Machine, Ducted Fume Hood, LN2

PLANS & AREAS

CL2 Labs

- 2 x fitted CL2 labs with 6 ach/hr in lab areas (approx 60/40)
- Lab gasses (CO₂, O₂, N, compressed air)
- Access to LN2 Chryo store
- Access to shared lab facility with Autoclave, Ducted Fume Hood, Ice Machine, purified water, etc
- Access to rear goods-in/goods lift
- Access to shared meeting room space
- Established Lab protocols
- Parking available
- Backbone Connect installed facilitating easy broadband connection up to 10GB

Co-working space summary

- Adapt co-working space by ARC
- Backbone Connect installed facilitating easy broadband connection up to 10GB

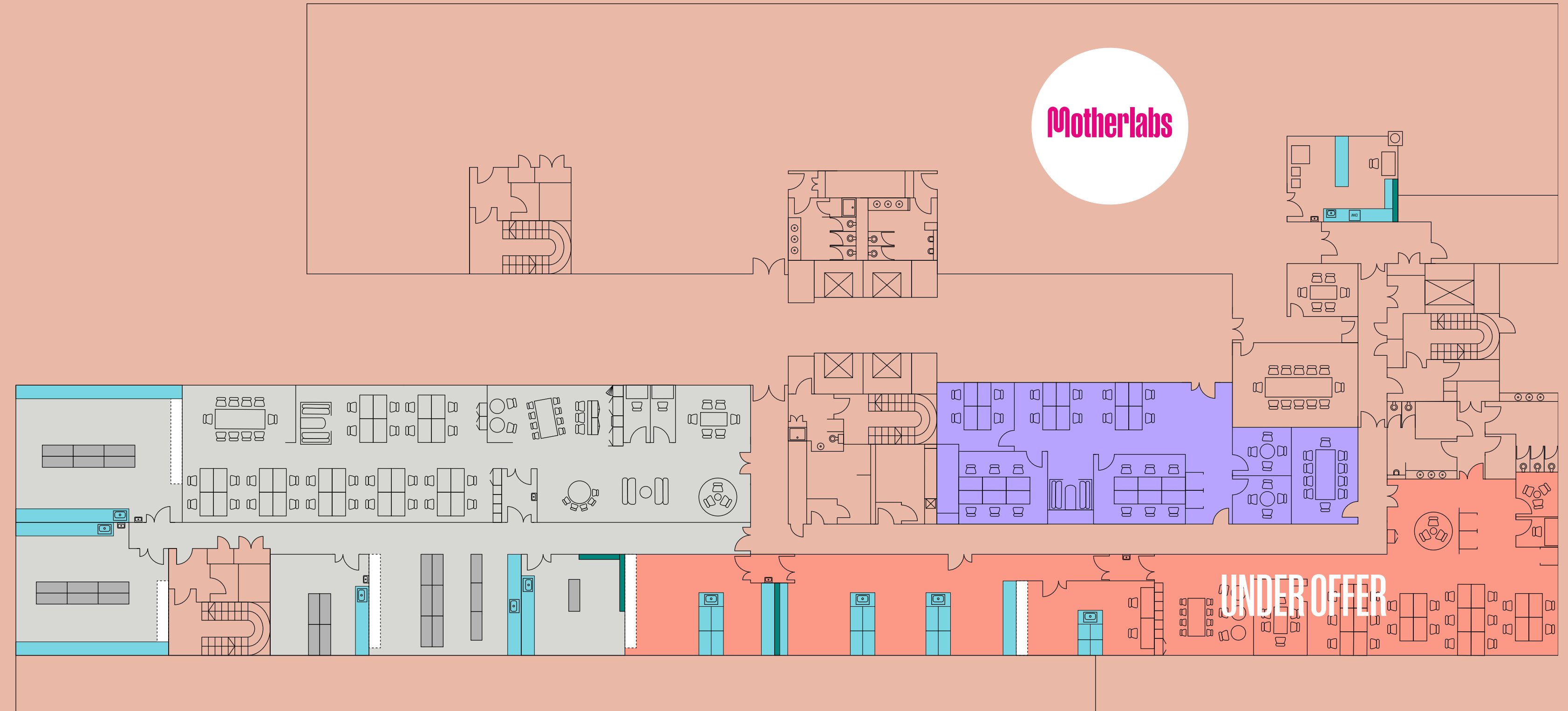

CL2 Lab Fitout

FLOOR

GROUND

Lab/Office Space

11,673 sq ft

1,084 sq m

- Unit 01 – 3,625 sq ft
 - Unit 01/Office – 1,894 sq ft
 - Unit 01/Laboratory – 1,731 sq ft
- Unit 02 – 6,124 sq ft
 - Unit 02/Office – 2,798 sq ft
 - Unit 02/Laboratory – 3,326 sq ft

- ARC space – 1,924 sq ft
- Mobile lab bench
- Lab bench
- Lab shelving

PLANS & AREAS

CL2 Labs

- 10,961 sq ft CL2 lab for single occupier (approx 50/50) 6 ach/hr in lab areas
- Stunning private roof terrace with river views
- Direct Access to goods lift
- Gas storage
- LN2 Store
- Established Lab protocols
- Backbone Connect installed facilitating easy broadband connection up to 10GB
- Parking spaces available

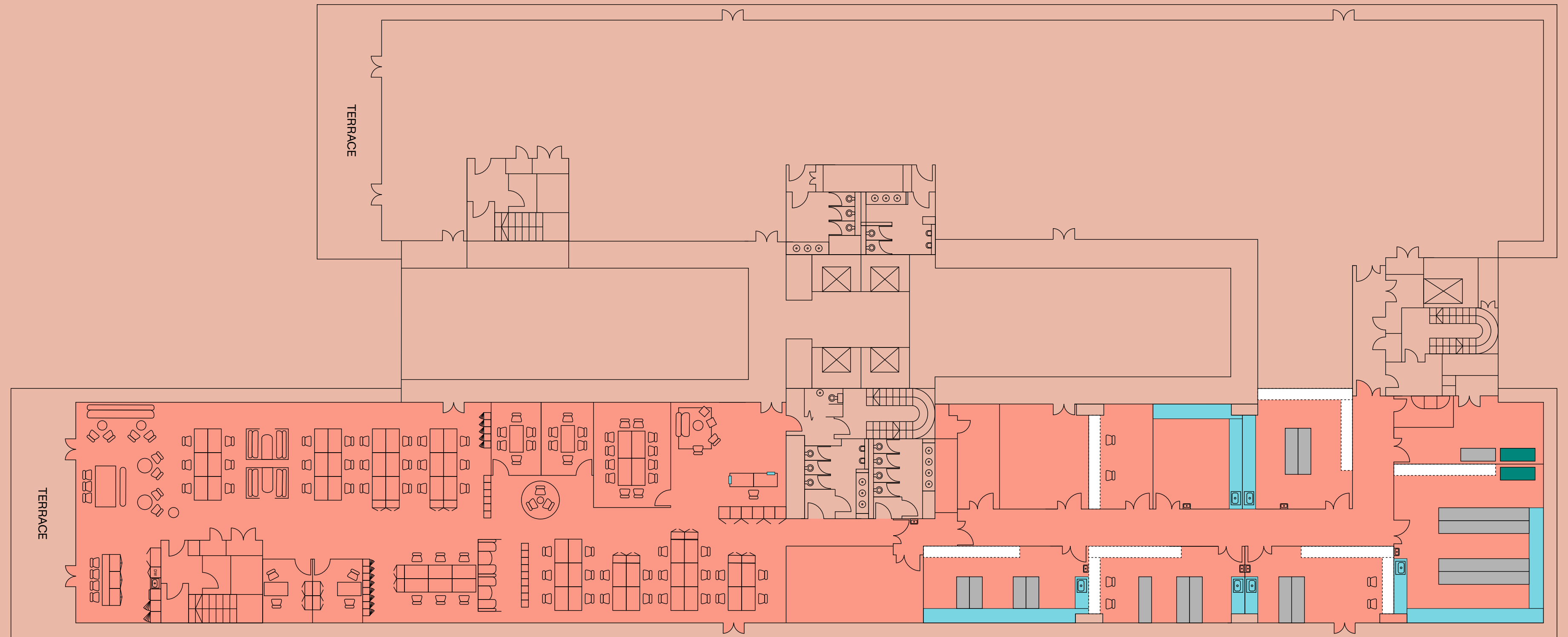

CL2 Lab Fitout

FLOOR

4

Lab/Office Space
10,961 sq ft
1,018 sq m

- Available
- Mobile lab bench
- Lab bench
- Lab shelving

SPECIFICATION

CAT-A BASE BUILD SPECIFICATION

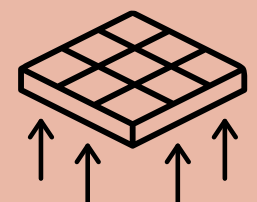

Raised floor

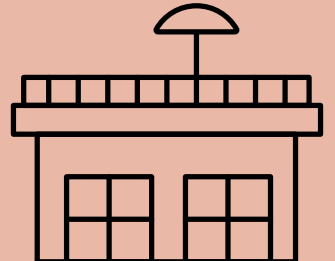

Private roof terrace on 4th floor

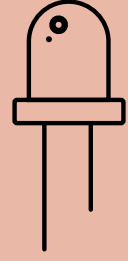

LED lighting

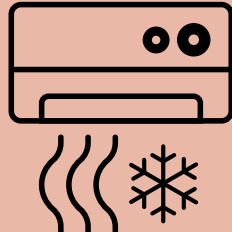

4 pipe fan coil air conditioning

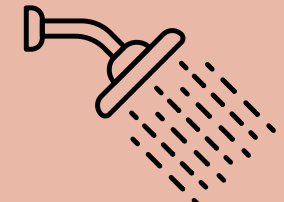

New end of Journey experience

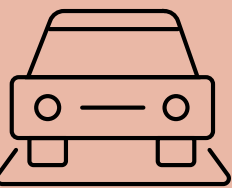

4 car parking spaces

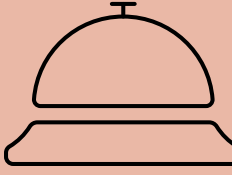

Concierge

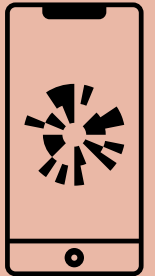

ARC West London app



Backbone Connect installed facilitating easy broadband connection up to 10GB



Rating C

FITTED CL2 LABS

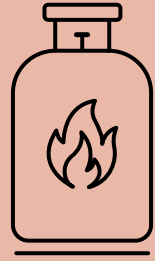

Gas storage

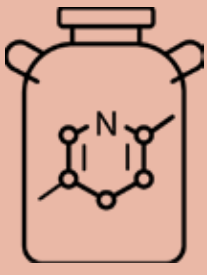

LN2 store



Freezer room

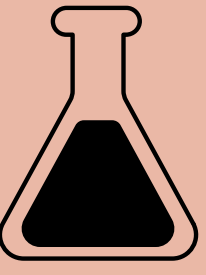

13 labs

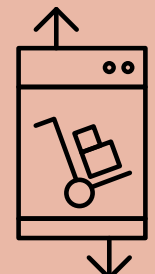

Direct access to goods lift

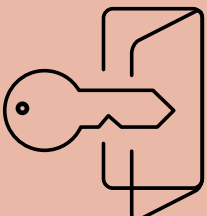

Store



Write-up area



Air lock

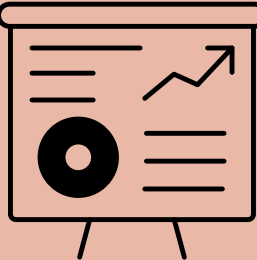

Co-working space with additional meeting rooms

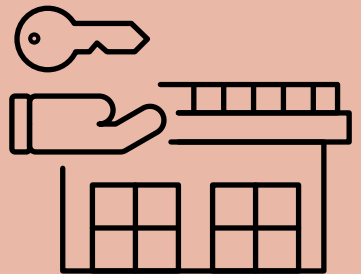

Direct access to roof to install additional plant

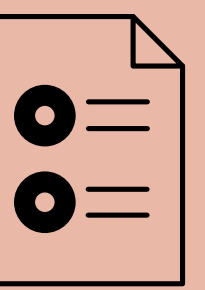

Established lab protocols



ARC NETWORK

When you join the ARC West London community you also become part of the ARC network of leading science and innovation campuses country-wide with ARC Oxford, ARC Uxbridge and ARC Harwell, along with ARC West London. This delivers exclusive membership benefits including access to collaboration space in every ARC site so that every member is part of something bigger with broader, faster, knowledge sharing facilitated by dedicated cluster and community managers.

ARC's energising environments and wellbeing initiatives create spaces where talent can thrive. As an ARC member you're plugged into the knowledge and business experience of over 250 member organisations.

ARC is also a platform for promoting your business. Online on social media, in our newspaper, and over the digital in our popular podcasts.

CONTACT

LETTING AGENTS

TOM MELLOWS

M: +44 (0)7870 555955
E: tmellows@savills.com

RUPERT DANDO

M: +44 (0)7813 624276
E: rupert.dando@savills.com

SAM DENEHY

M: +44 (0)7977 030175
E: samuel.denehy@savills.com

savills.co.uk



PADDY SHIPP

M +44 (0)7469 155531
E: paddy.shipp@eu.jll.com

BRIDGET PARTRIDGE

M: +44 (0)7921 309816
E: bridget.partridge@eu.jll.com

MATTHEW SYMONS

M: +44 (0)7928 501324
E: matthew.symons@eu.jll.com

jll.co.uk



Misrepresentation Act 1967 and Property Misdescriptions Act 1991. Savills, Jones Lang LaSalle and their clients give notice that: Savills and Jones Lang LaSalle for themselves and the vendor of this property give notice that these particulars do not form, or form part of, any offer or contract. They are intended to give fair description of the property and whilst every effort has been made to ensure their accuracy this cannot be guaranteed. Any intending purchaser must therefore satisfy themselves by inspection or otherwise. Neither Savills and Jones Lang LaSalle nor any of its employees has any authority to make or give any further representations or warranty whatsoever in relation to this property. All prices and rents quoted are net of VAT. October 2023.

ANDREW DAVIES

T: +44 (0)7545 009618
E: andrew.davies@arcgroup.io

DAN PAGELLA

T: +44 (0)7831 894332
E: dan.pagella@arcgroup.io

ARC.