

England & Wales	
EU Directive 2002/91/EC	
Very energy efficient - lower running costs	(92 plus) A
	(81-91) B
	(69-80) C
	(55-68) D
	(39-54) E
	(21-38) F
Not energy efficient - higher running costs	(1-20) G
Current	69
Potential	84

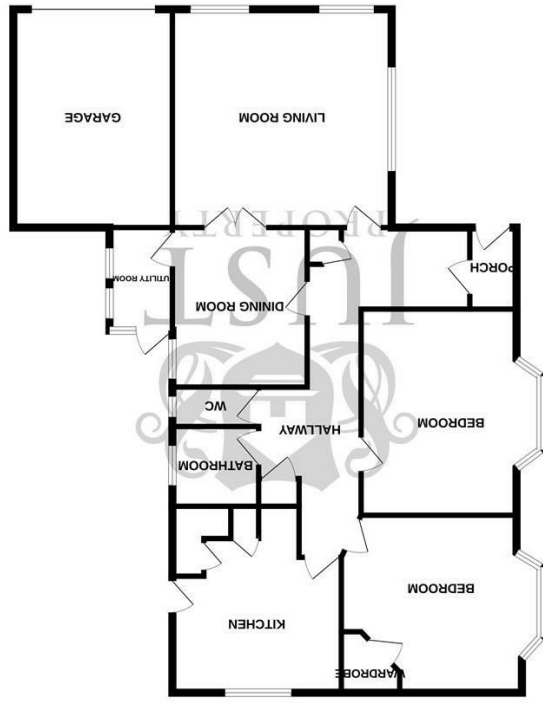

GROUND FLOOR



FLOORPLANS

28 Birkdale, Bexhill-On-Sea, TN39 3TL

www.justproperty.net

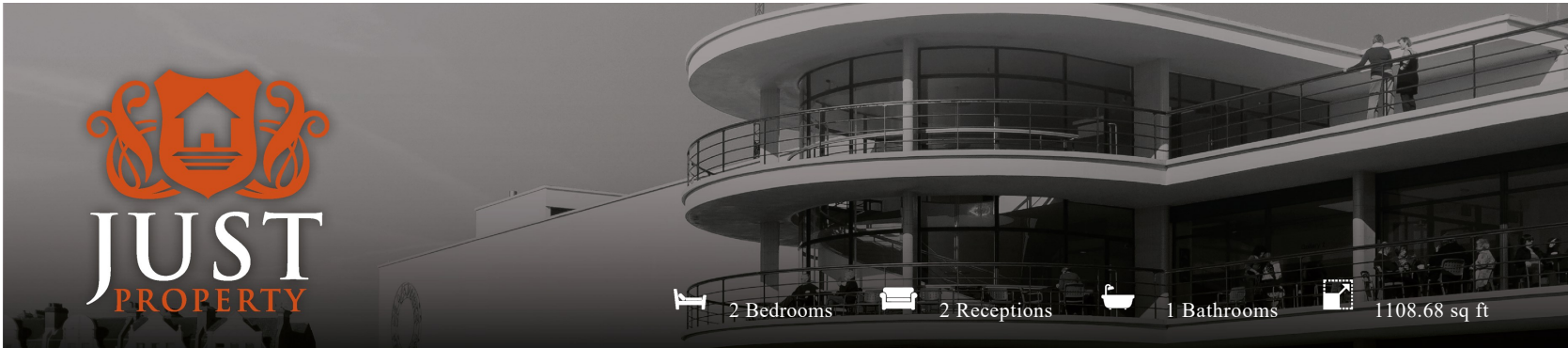

2 Bedrooms 2 Receptions 1 Bathrooms 1108.68 sq ft

Freehold
£449,950

28 Birkdale, Bexhill-On-Sea, TN39 3TL





2 Bedrooms 2 Receptions 1 Bathrooms 1108.68 sq ft

PROPERTY DETAILS

Just Property are delighted to bring to the open market this deceptively spacious TWO BEDROOM detached bungalow situated in this highly desirable location. The property is only a short walk away from bus routes, shops and local amenities as well as Little Common Village and surrounding areas.

The living accommodation is both bright and airy throughout and is to include TWO DOUBLE BEDROOMS, a family bathroom with separate W.C, a large kitchen area with multiple fitted appliances and white good as well as an open plan Lounge /Diner with natural light flooding in.

Externally the property has off road parking for multiple vehicles and a detached garage. There is also a large front / Rear garden which enjoys the sun all day round.

To arrange access for a viewing contact Just Property on 01424 444 100 to see all this wonderful property has to offer.

Properties in this address very rarely come to the market so viewings are considered essential.



ROOM DIMENSIONS

Front Door

Porch

Hallway

Living Room
16'0" x 14'11" (4.88 x 4.57)

Dining Room
9'9" x 11'11" (2.99 x 3.65)

Utility Room

Bedroom
11'11" x 15'1" (3.65 x 4.60)

Bedroom
13'11" x 12'11" (4.26 x 3.96)

Kitchen
12'4" x 9'10" (3.76 x 3.02)

Bathroom

W.C

Garage

Front and Rear Garden

Off Road Parking

FEATURES

- Two Bedroom Bungalow
- Desirable Location
- Garage/Off Road Parking
- Attractive Gardens
- Large Rooms Throughout
- TWO double Bedrooms
- Bright and Airy Living Accommodation
- Close to Bus Routes
- Viewing Essential Via Just Property

