

Whilst every attempt has been made to ensure the accuracy of the floorplans contained herein, measurements of rooms, areas, volumes and appliances should be taken on site by any prospective purchaser. The floorplans, drawings and appliances shown are for general guidance only and should not be used as a contract. Measurements are to the finished state of the property and are not intended to be used as a contract. Measurements are to the finished state of the property and are not intended to be used as a contract.

England & Wales	
EU Directive 2002/91/EC	
Very energy efficient - lower running costs	(92 plus) A
	(81-91) B
	(69-80) C
	(55-68) D
	(39-54) E
	(21-38) F
Not energy efficient - higher running costs	(1-20) G
Current	68
Potential	85

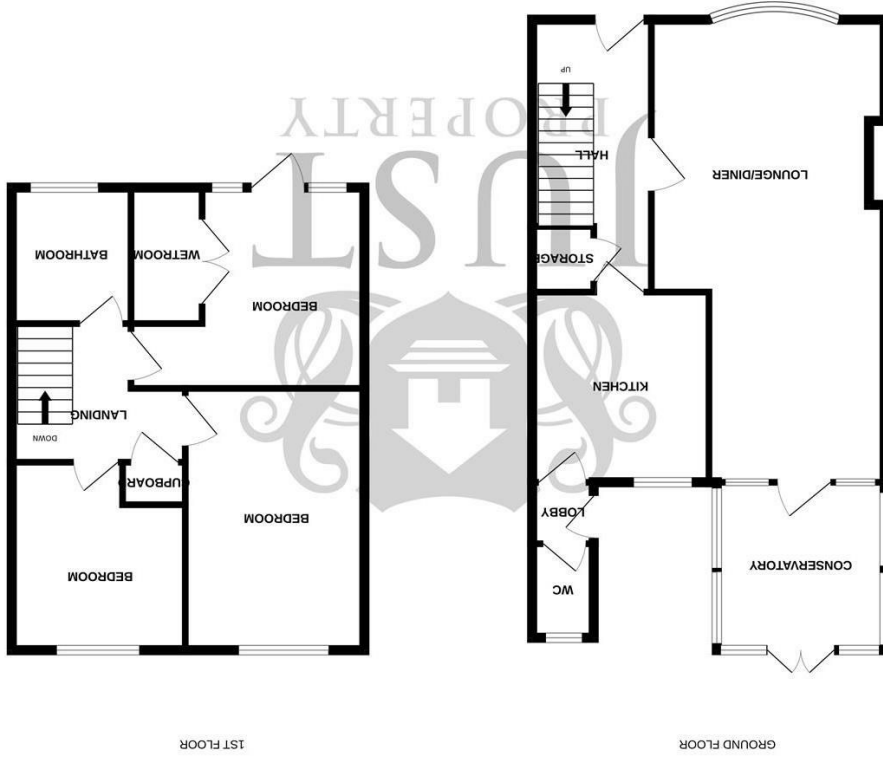

FLOORPLANS

29 Courthope Drive, Bexhill-On-Sea, TN39 4JN

www.justproperty.net

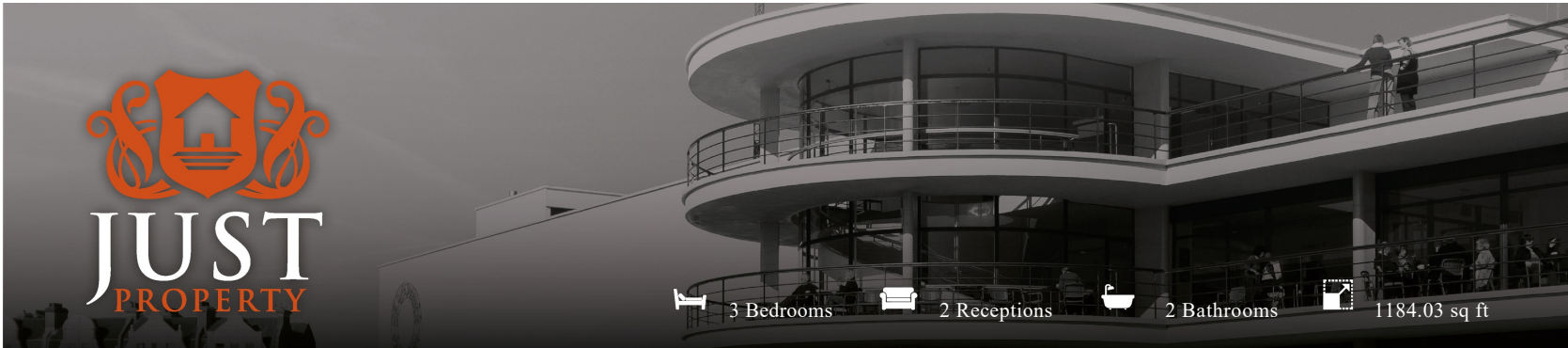

3 Bedrooms 2 Receptions 2 Bathrooms 1184.03 sq ft

Freehold
£365,000

29 Courthope Drive, Bexhill-On-Sea, TN39 4JN





3 Bedrooms 2 Receptions 2 Bathrooms 1184.03 sq ft

PROPERTY DETAILS

Welcome to Courthope Drive, Bexhill-On-Sea - a charming location for this well-presented CHAIN FREE house that boasts 2 reception rooms, 3 bedrooms, and 2 bathrooms. The property is in fantastic condition and is available with no onward chain. The rear conservatory is a fantastic place to enjoy the rear garden. the principle bedroom also has a balcony over looking the pleasant rear garden.

This delightful property offers a generous 1,184 sq ft of living space, providing ample room for a growing family or those who love to entertain. With off road parking parking available and a garage in the block, convenience is at your doorstep. There is gas fired central heating and UPVc double glazing throughout.

Situated close to doctors and shops, this home offers both comfort and practicality. Additionally, the proximity to Bexhill seafront and promenade allows for leisurely strolls by the sea, making it an ideal location for those who appreciate the coastal lifestyle.

Don't miss the opportunity to make this property your new family home. Contact Just Property today to arrange a viewing and experience the charm of Courthope Drive for yourself.



ROOM DIMENSIONS

Front Door	Bedroom 10'2" x 10'9" (3.1 x 3.3)
Entrance Hall	Bathroom
Lounge / Diner 13'5" x 28'2" (4.1 x 8.6)	FRont Garden
Conservatory 9'10" x 9'10" (3 x 3)	Rear Garden
Kitchen 9'10" x 11'1" (3 x 3.4)	Greenhouse
Downstairs W/C	Garage in Block To Rear 18'4" x 8'0" (5.59 x 2.45)
Stairs To First Floor Landing	
Bedroom 10'2" x 14'9" (3.1 x 4.5)	
En Suite Shower	
Bedroom 10'2" x 14'9" (3.1 x 4.5)	

FEATURES

- Three Bedroom Family Home
- South Facing Garden
- CHAIN FREE
- Spacious Accommodation
- Great Curb Appeal
- Off Road Parking & Garage in Block
- Master Bedroom and En Suite Shower
- Quiet Residential Road
- Close To Shops and Post Office

