



GRANT FRASER
TOWN & COUNTRY



28 Cartwright Drive, Shaw, Swindon, Wiltshire, SN5 5SB
Guide price £350,000



28 Cartwright Drive, Shaw, Swindon, Wiltshire, SN5 5SB

Guide price £350,000

Welcome to this detached home located on Cartwright Drive in the lovely area of Shaw, Swindon. This property boasts a spacious layout with 1 reception room, perfect for entertaining guests or relaxing with family. With 3 bedrooms and 2 bathrooms, there is ample space for everyone in the household.

One of the standout features of this property is its proximity to the stunning Lydiard 260 acre country park, offering a picturesque setting for leisurely walks or outdoor activities. For families with young children, Brook Field primary school is just a stone's throw away, making the school run a breeze.

Convenience is key with a bus collection point to the secondary school nearby, ensuring a stress-free commute for students. Additionally, the property is surrounded by public open spaces and parks, ideal for enjoying the outdoors and staying active.

For those who need to commute, Swindon train station is a mere 3.5 miles away, providing easy access to major cities. The M4 motorway is also conveniently located just 2 miles from the property, offering seamless travel by car.

Description

Comprising entrance porch, living room, kitchen diner, cloakroom, three bedrooms, bathroom and en-suite. The entrance hallway has a handy under stair cupboard, doors lead off to all ground floor rooms. The dual aspect living room has a feature box bay window overlooking the front garden. The kitchen diner enjoys views and access to the rear garden. There is a handy cloakroom on the ground floor. On the first floor bedroom one enjoys an en-suite shower room. There are two further bedrooms and a main bathroom with shower over the bath.

Outside there is tandem parking on the driveway with further street parking nearby. A footpath leads to gated rear access. The rear garden having a patio and expanse of lawn with a mature tree to the rear ideal for a child's swing.

Situation

Shaw is in the heart of west Swindon, within walking distance to the west Swindon district centre, offering an ASDA supermarket along with an array of shops, takeaways and salons etc, plus the vast leisure facilities, such as ice skating and a 25 meter indoor competition pool. There are three primary schools within close proximity, Brook Field in particular being yards from the property. Bus services run to local secondary schools, such as Lydiard Park Academy or Bradon Forest, which is in nearby Purton village. Lydiard country park is a beautiful 260 acre estate, open to the public year round, with play areas for the children, cafes and hosting many public events for all the family. There are also further smaller public open spaces along with lakes, such as Peatmoor, all within easy walk of the location, may with children's play areas.

The area has great transport links, the M4 motorway access 3 miles from the property, the A419 links to the M5 Motorway. Swindon Station is approximately 3.5 miles away and trains to central London, Bath and Bristol and the West Country run on a regular timetable.



Floor Plans

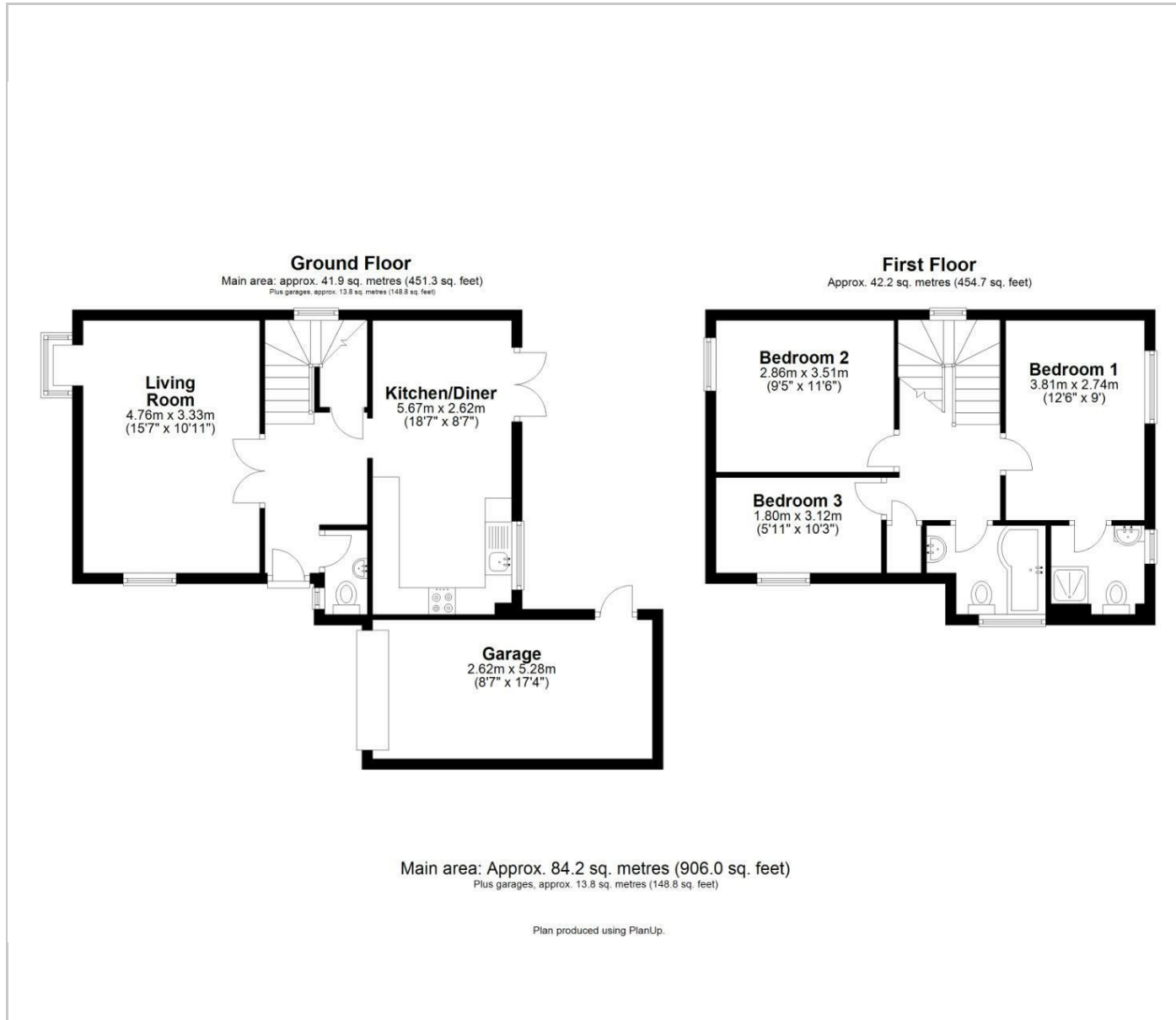

Area Map

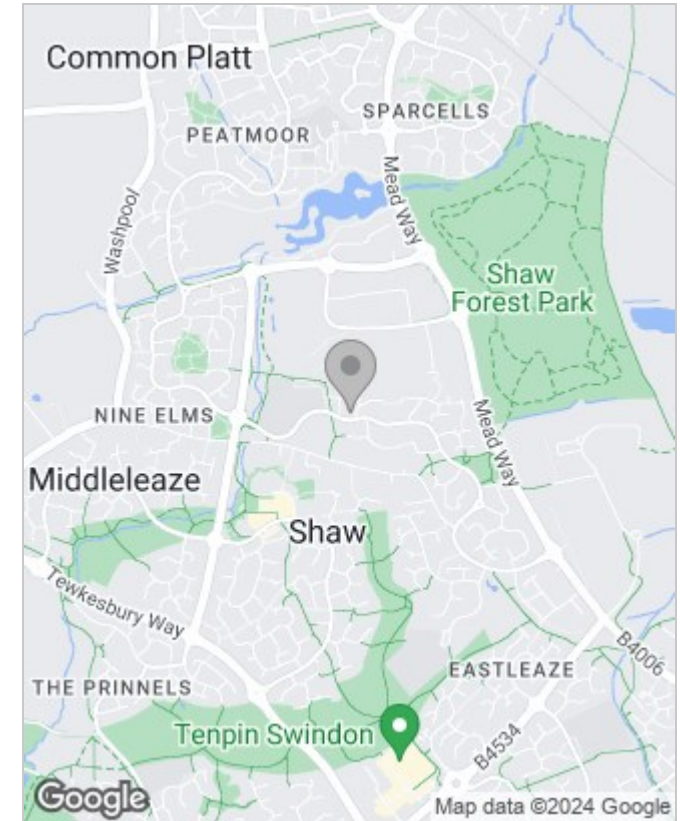

Energy Performance Graph

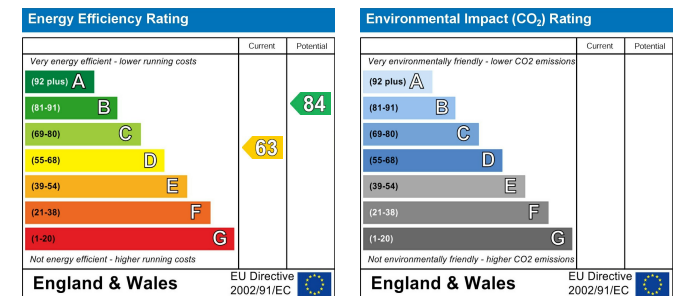

White Elm Newtown, Bishopstone, Swindon, Wiltshire, SN6 8QA

Tel: 01793 228 440 Email: info@grantfrasertc.co.uk