



15 Walden Terrace

Gifford, Haddington, EH41 4QP

kw SCOTLAND
KELLERWILLIAMS®



Property Summary

Set on a quiet cul-de-sac, this three-bedroom semi-detached house is a beautiful residence that offers a semi-rural lifestyle in Gifford village, enjoying close proximity to the surrounding countryside. The home also provides wonderful open-plan living, which includes a quality kitchen and French doors extending out into the rear garden. Furthermore, it is brought to market in true walk-in condition, enjoying a blank canvas of décor to allow new buyers to easily add their own stamp – perfect for a wide variety of buyers.

Extras: all fitted floor and window coverings, light fittings, and integrated kitchen appliances to be included in the sale.



Features

- A charming semi-detached house
- Situated in the village of Gifford
- Bright and welcoming entrance hall
- Open-plan kitchen/living/dining room
- Modern kitchen with integrated appliances
- Separate utility room
- Two spacious double bedrooms
- Third versatile bedroom/home office
- Stylish 3pc bathroom with overhead shower
- Easy-to-maintain front garden
- Large, fully-enclosed rear garden
- On-street parking
- Double-glazed and triple-glazed windows
- Air source heat pump in conjunction with an immersion system
- EPC Rating - D



kw

“A modern kitchen with integrated appliances and a separate utility room”







kw

“Two spacious double bedrooms, a third versatile bedroom/home office, and a stylish 3pc bathroom with overhead shower”







Floorplan

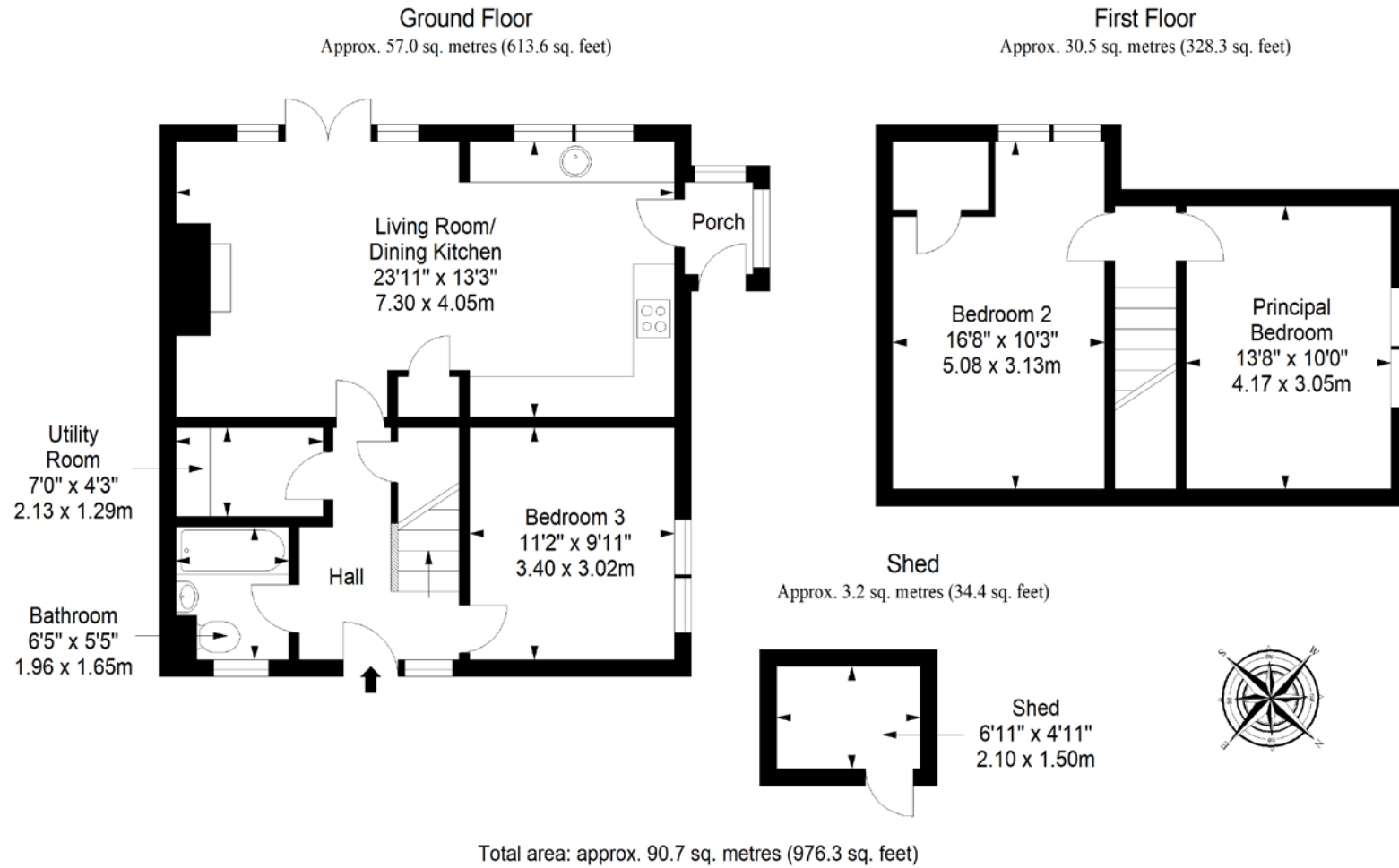

DISCLAIMER: These particulars are intended to give a fair description of the property but their accuracy cannot be guaranteed, and they do not constitute or form part of an offer of contract. Intending purchasers must rely on their own inspection of the property. None of the above appliances/services have been tested by ourselves. We recommend purchasers arrange for a qualified person to check all appliances/services before legal commitment. Whilst every attempt has been made to ensure the accuracy of the floorplan contained here, measurements of doors, windows, rooms and any other items are approximate and no responsibility is taken for any error, omission, or misstatement. This plan is for illustrative purposes only and should be used as such by any prospective purchaser.