

EMSLEY  MAVOR  
ESTATE AGENTS

...your home is where our heart is



Farefield Close

Dalton, Thirsk, YO7 3FD

Asking Price £469,950



4



3



1





## Farefield Close

Dalton, Thirsk, YO7 3FD

STYLE - Beautifully Presented Detached Family Home

HIGHLIGHTS - Situated on a Quiet Development with Wonderful Open Views. Spacious Living, 4 Double Bedrooms, 2 Ensuities. Modern.

THREE WORDS - Tranquil. Versatile. Living.

### SCANDI-STYLE FAMILY HOME WITH OPEN VIEWS

Welcome to 11 Farefield Close, Dalton, a beautifully presented 4/5 bedroom detached family home that combines Scandinavian elegance with modern functionality. Nestled in a quiet development, this property offers a serene lifestyle with wonderful open views in the desirable village of Dalton.

### STEP INSIDE

Step inside to discover a must-have open plan living kitchen and dining area, where bi-fold doors seamlessly bring the outdoors in, creating a super sociable space perfect for family gatherings. The kitchen is equipped with all modern conveniences, ensuring a delightful cooking experience. Adjacent to the kitchen, a useful utility room and a convenient WC add to the home's practicality.

The sitting room is a cosy retreat, offering ample space for comfy seating and providing lovely front views.

Upstairs, two generous double bedrooms boast smart ensuities, while two additional doubles and a versatile home office or dressing room cater to all your family's needs. The luxurious house bathroom adds a touch of indulgence to your daily routine.







## OUTSIDE

Outside, the delightful garden is a haven for keen gardeners, featuring an array of flowering plants and perennials. It is fully enclosed making it perfect for little ones to play safely. Enjoy the privacy and open views from the comfort of your summer house, perfect for relaxing or entertaining guests. A single garage and off-street parking provide convenience and security.



This home is equipped with underfloor heating on the ground floor, double glazing, and mains gas and water services, ensuring comfort and efficiency throughout.

11 Farefield Close is more than just a house; it's a lifestyle. With its aesthetic appeal and thoughtful design, this property is ready to welcome you home. Don't miss the opportunity to make this Scandi-style sanctuary your own. Contact Emsley Mavor Estate Agents today to arrange a viewing.



Dalton is an attractive village nestled in the picturesque countryside of North Yorkshire and, surrounded by the scenic landscapes of the North Yorkshire Moors National Park, the village makes an ideal destination for outdoor enthusiasts, offering opportunities for hiking and cycling etc. It is viewed as an excellent commuter village, being in close proximity to both the A19 and A1(M) arterial routes, allowing simple commutes to Harrogate, York, Leeds and Middlesbrough. The village further benefits from close proximity to a number of excellent schools, both state and private.



Floor Plan

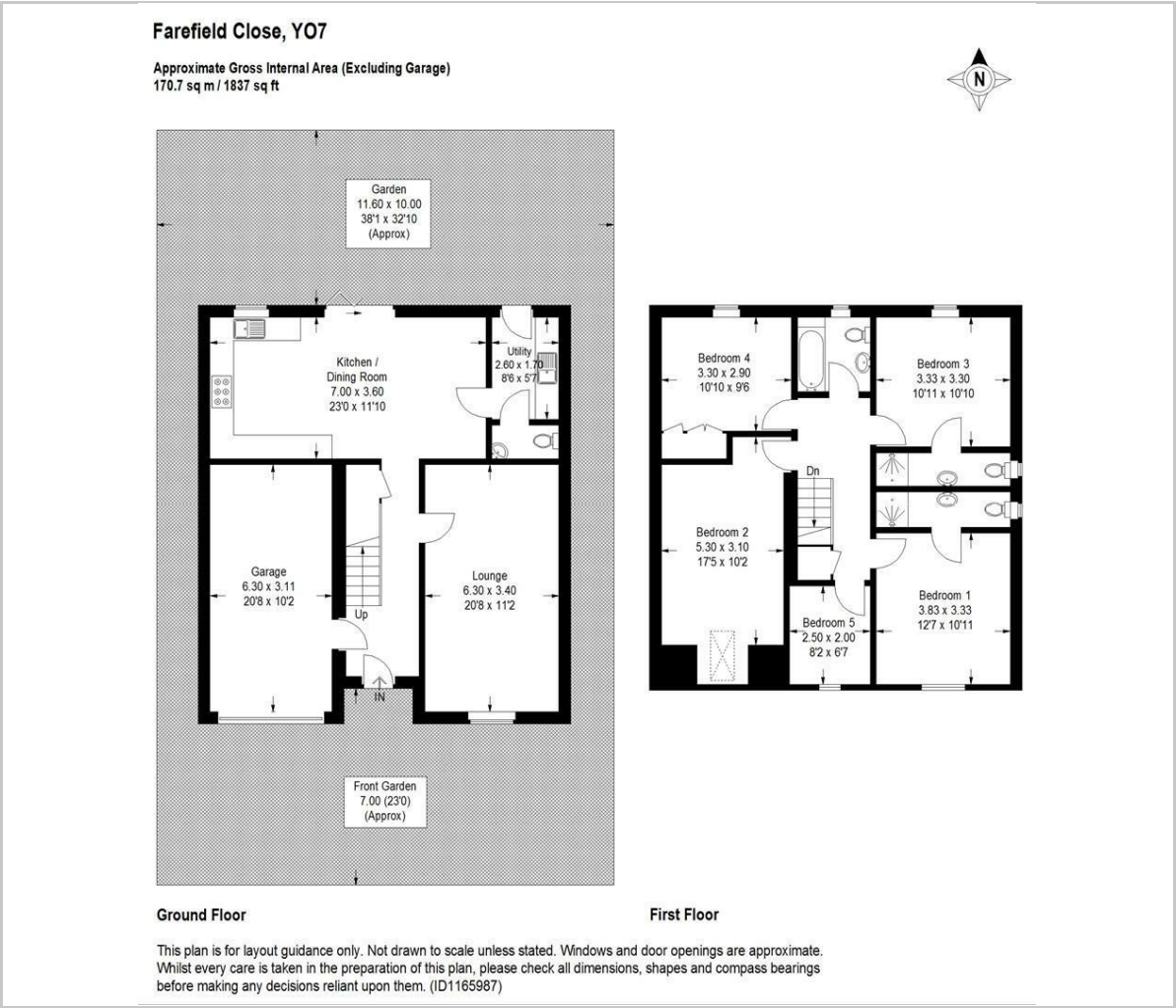

Viewing

Please contact our Emsley Mavor Estate Agents Office on 01347823579 if you wish to arrange a viewing appointment for this property or require further information.

Area Map



Energy Efficiency Graph



These particulars, whilst believed to be accurate are set out as a general outline only for guidance and do not constitute any part of an offer or contract. Intending purchasers should not rely on them as statements of representation of fact, but must satisfy themselves by inspection or otherwise as to their accuracy. No person in this firms employment has the authority to make or give any representation or warranty in respect of the property.

1 Tollbooth Building Market Place, Easingwold, North Yorkshire, YO61 3AB  
Tel: 01347823579 Email: info@emsleymavor.co.uk http://emsleymavor.co.uk