

EMSLEY MAJOR
ESTATE AGENTS

...your home is where our heart is

EMSLEY MAJOR
ESTATE AGENTS

...your home is where our heart is

FOR SALE

Call 01547 823570
emsleymajor.co.uk

Lime Tree Avenue
Easingwold, York, YO61 3RT
Asking Price £325,000



Lime Tree Avenue

Easingwold, York, YO61 3RT

STYLE - Link Detached Home

HIGHLIGHTS - Situated on Hugely Desirable Claypenny Development, Updated by Current Owners, Stylish Decor, South Facing Garden

THREE WORDS - LOVELY. LIVING. LIFESTYLE!

Charming Home in Desirable Claypenny

Welcome to 5 Lime Tree Avenue, Easingwold – a delightful semi-detached home nestled in the heart of the highly sought-after Claypenny development. This charming residence perfectly marries modern convenience with a touch of country style, offering a warm and inviting atmosphere for families and professionals alike.

The property has been thoughtfully updated by the current owners, complimenting the home's stylish interior, featuring new flooring, a new boiler as well as the new insulated ceiling in conservatory & tasteful décor throughout.

STEP INSIDE

Upon entering, you are greeted by a spacious sitting room that flows seamlessly into the modern fitted kitchen and into a bright garden room. This versatile space can serve as a dining area, playroom, or a tranquil garden room, allowing you to enjoy the outdoors from the comfort of your home.

BEDROOMS

Upstairs, the master bedroom boasts an ensuite, providing a private retreat for relaxation. Two additional bedrooms offer ample space for family, guests, or a home office, accompanied by a well-appointed family bathroom.





OUTSIDE

Step outside to discover a south-facing enclosed garden, a perfect haven for gardening enthusiasts or a safe play area for children. The garden leads to a single garage, accessible via a shared driveway, and offers off-street parking for your convenience.

The front of the property features a neatly stoned area with a retaining brick wall, adding to the home's curb appeal. Pedestrian access leads you down the side of the property to the rear garden, ensuring privacy and ease of access.

SERVICES

With no onward chain, this home is ready for you to move in and make it your own. Enjoy the benefits of gas central heating and UPVC double glazing, ensuring comfort and efficiency year-round.

5 Lime Tree Avenue is more than just a house: it's a lifestyle opportunity in a prime location. Arrange a viewing today and experience the charm and convenience this home has to offer.



Floor Plan

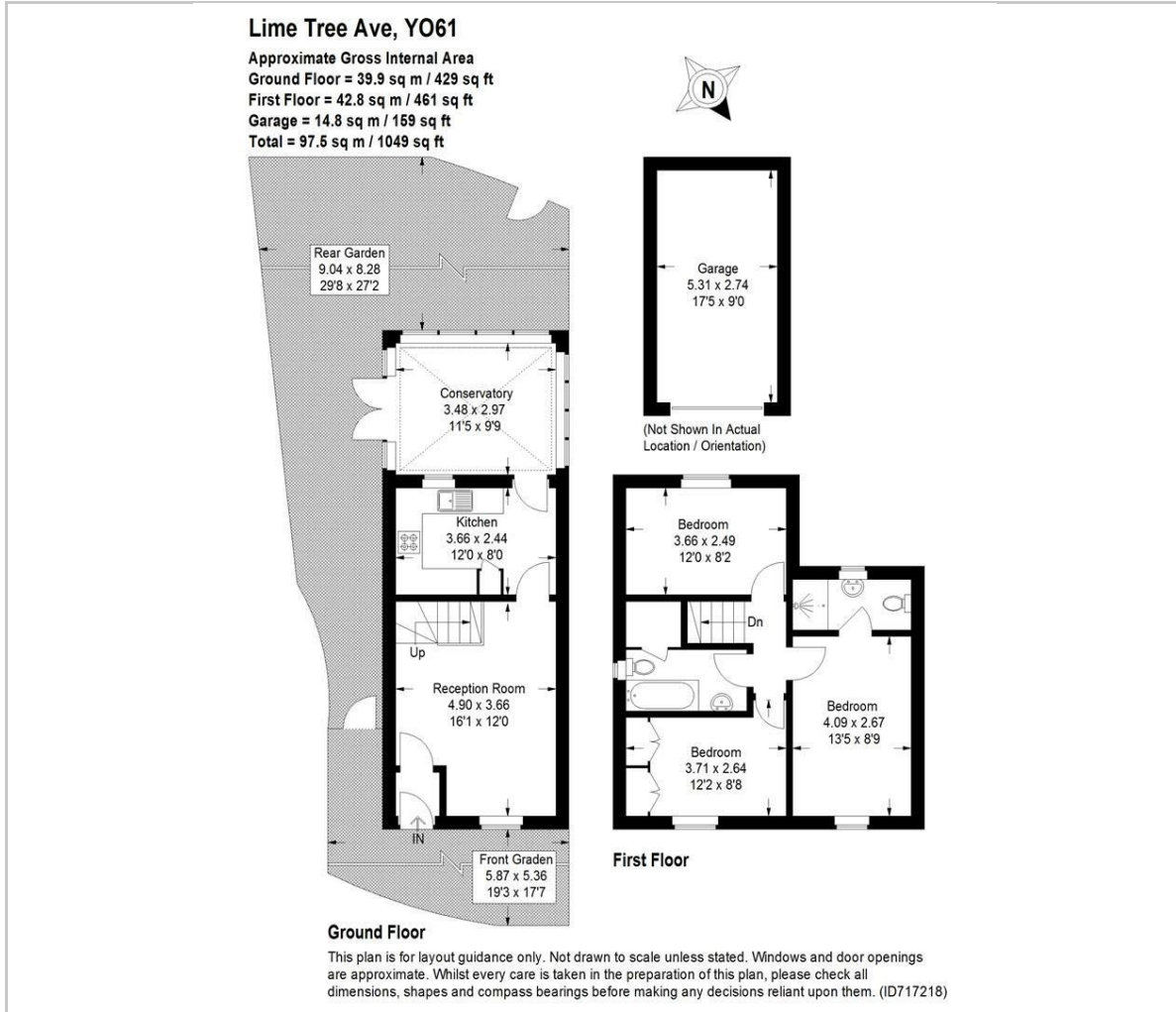

Viewing

Please contact our Emsley Mavor Estate Agents Office on 01347823579 if you wish to arrange a viewing appointment for this property or require further information.

Area Map



Energy Efficiency Graph

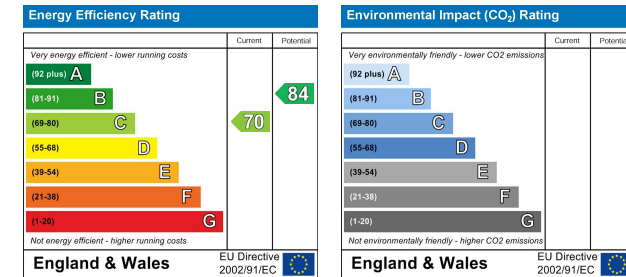

These particulars, whilst believed to be accurate are set out as a general outline only for guidance and do not constitute any part of an offer or contract. Intending purchasers should not rely on them as statements of representation of fact, but must satisfy themselves by inspection or otherwise as to their accuracy. No person in this firm's employment has the authority to make or give any representation or warranty in respect of the property.

1 Tollbooth Building Market Place, Easingwold, North Yorkshire, YO61 3AB
 Tel: 01347823579 Email: info@emsleymavor.co.uk http://emsleymavor.co.uk