

TO LET

North Drive, Hounslow, TW3 1AH
£1,900 Per Calendar Month

DBK
ESTATE AGENTS

- Available To Rent From Mid-July!
- Two Double Bedrooms
- Ample Storage
- Family Bathroom
- Hounslow High Street 0.4 Miles
- Open Plan Kitchen/Reception Room
- Private Garden
- Modern Fitted Kitchen
- Circa 757 sq ft
- Hounslow East Station 0.3 Miles

THE PROPERTY

Available to rent from mid-July is this spacious and well-presented two-bedroom ground floor apartment. This property boasts a bright and airy open-plan kitchen/reception room, perfect for modern living and entertaining. The master bedroom is generously proportioned, providing a comfortable retreat with plenty of natural light. The apartment further benefits from ample storage throughout, ensuring clutter-free living.

A standout feature of this home is the private garden, offering a peaceful outdoor space ideal for relaxing or hosting friends and family. With approximately 757 sq ft of well-designed living space, this property offers the perfect blend of comfort and convenience in a sought-after location.

Just a short walk from Hounslow East Underground Station (Piccadilly Line), this area offers speedy access into central London and Heathrow (under 10 minutes by tube). Close by, the Blenheim Centre houses a 24-hour Asda supermarket and gym facilities. The wider High Street area brings plentiful restaurants, cafes, and essential services

GROUND FLOOR
757 sq.ft. (70.4 sq.m.) approx.

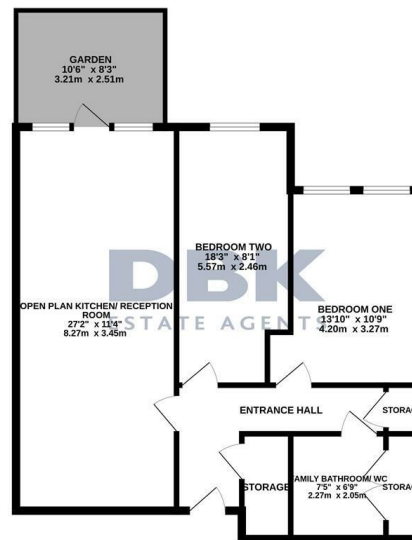

TOTAL FLOOR AREA: 757 sq.ft. (70.4 sq.m.) approx.
While every attempt has been made to ensure the accuracy of the floorplan contained herein, measurements of doors, windows, stairs and any other items are approximate and no responsibility is taken for any error, omission or misstatement. This plan is for illustrative purposes only and should be used as a guide to the prospective purchaser. The services, systems and appliances shown have not been tested and no guarantee is given for their operation or efficiency can be given.
Made with Metaphor 12/25