



TO LET

Strand On The Green, London, W4 3PN
£2,500 Per Calendar Month

DBK
ESTATE AGENTS

- Available To Rent Immediately!
- Three Well Proportioned Bedrooms + Home Office/ Study
- Stylish Fitted Kitchen with Integrated Appliances
- One Parking Space
- Circa 832 Sq.Ft
- Modern Riverside Ground Floor Apartment
- Large Reception Room Leading to a Private Garden
- Fashionable Family Bathroom Suite
- Tranquil Views
- Prime Location

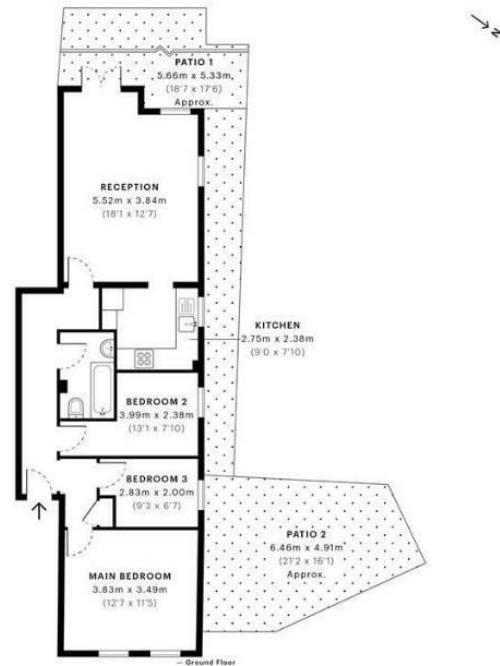

THE PROPERTY

REPOSIT SCHEME AVAILABLE WITH THIS PROPERTY

Available Immediately, this modern riverside apartment situated on the ground floor, boasts a spacious and well-designed layout with approximately 734 sq.ft. of living space, this property offers a harmonious blend of style and comfort.

Upon entering, you'll find three generously sized bedrooms, with an additional room ideal for a home office or study. The large reception room provides ample space for relaxation and entertainment leading seamlessly to a private garden where you can unwind and enjoy tranquil views.

The stylish fitted kitchen comes complete with integrated appliances, making meal preparation a delight. The fashionable family bathroom suite is both contemporary and functional, ensuring a luxurious experience.

This apartment includes one designated parking space, adding to the convenience and appeal of this beautiful home.

Conveniently located 0.2 miles from Chiswick Station providing links for those commuting to The City. For motorists the A4/ M4 and A316 can be found within a short drive connecting you to neighbouring towns. Reputable schools include Grove Park Primary School and Strand-on-the-Green Infant and Nursery School both scoring OUTSTANDING by OFSTED.