



# TO LET

**Ashford Road, Feltham, TW13 4SD**  
**£1,750 Per Calendar Month**

**DBK**  
ESTATE AGENTS

- Available To Rent Beginning of May!
- Two Double Bedrooms
- Modern Fitted Kitchen
- Fitted Wardrobes
- Council Tax Band C
- Top Floor Apartment
- Open Plan Living
- Ensuite + Shower Room/ WC
- Secure Entry System
- Feltham Station 1 Mile

SECOND FLOOR  
658 sq.ft. (61.2 sq.m.) approx.

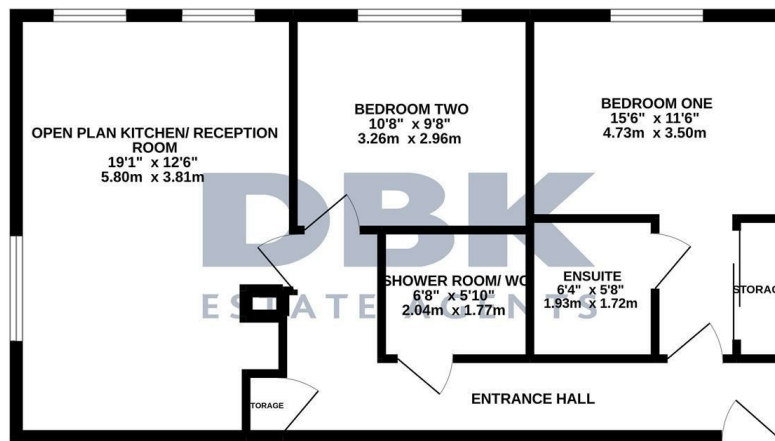

TOTAL FLOOR AREA: 658 sq.ft. (61.2 sq.m.) approx.  
Whilst every attempt has been made to ensure the accuracy of the floorplan contained here, measurements of doors, windows, rooms and any other items are approximate and no responsibility is taken for any error, omission or mis-statement. This plan is for illustrative purposes only and should be used as such by any prospective purchaser. The services, systems and appliances shown have not been tested and no guarantee as to their operability or efficiency can be given.  
Made with Metropix ©2022

## THE PROPERTY

Available To Rent Beginning of May!

An exquisite top floor apartment situated within a gated development located in Feltham. Accommodation comprises of two double bedrooms, a modern fitted kitchen which is linked with reception room, offering an open plan living and a stylish shower room/ wc. Supplementary to this is an ensuite bathroom within the master suite, a secure entry system, fitted wardrobes and communal gardens.

Council Tax Band C

Sited moments away from Local amenities and excellent nearby transport links such as Feltham Overground Station; connecting commuters to The City as well as local bus links providing transport to neighbouring towns and Heathrow Airport. Reputable schools such as Reach Academy and Feltham Hill Infant and Nursery School very accessible.