

TO LET

Clifford Road, Hounslow, TW4 7LR
£2,900 Per Calendar Month

DBK
ESTATE AGENTS

- Available To Rent Immediately!
- Circa 1,314 Sq.ft
- Through Lounge
- Family Bathroom + Downstairs Shower
- Off Street Parking
- Extended End of Terrace Home
- Four Bedrooms (Master with Ensuite)
- Extended Kitchen/ Diner
- Rear Garden
- Hounslow West Station 0.4 mi

THE PROPERTY

Available To Rent Immediately!

A model example of spacious family home located on this convenient location. Spread over three floors the property houses five bedrooms (master bedroom with ensuite), through lounge opening to an extended kitchen/ dining area, family bathroom/ WC and downstairs shower/ WC. Complementing the above mentioned is a rear garden, front garden for off street parking, gas central heating and double-glazed windows.

Perfectly situated within a moments walk to Hounslow West Underground Station and an array of amenities and restaurants offered on Bath Road. It also falls within close proximity to excellent bus links, local reputable schools such as The Heathlands School, St. Marks Catholic School and Lampton School as well as the A4/M4 connecting you to The City and routes out of town.

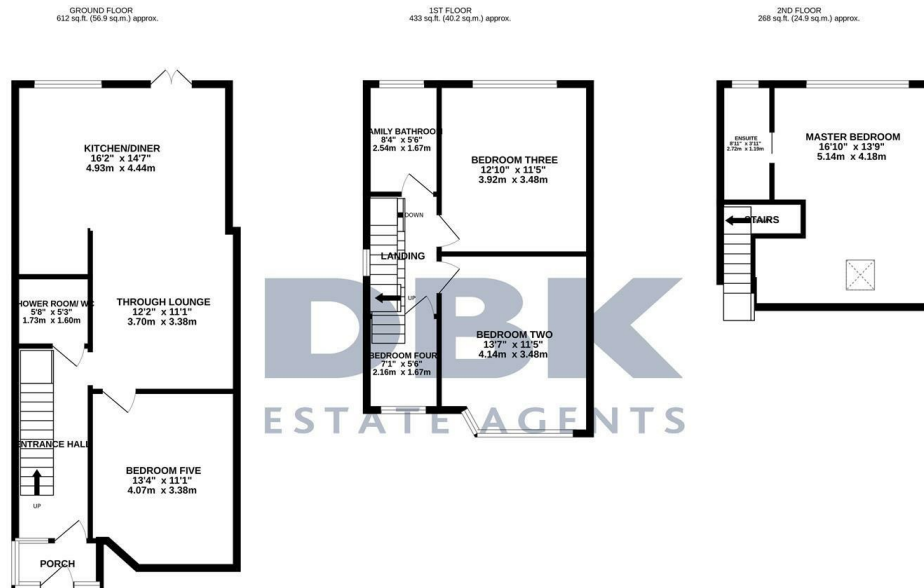

DBK
ESTATE AGENTS

TOTAL FLOOR AREA : 1313 sq.ft. (122.0 sq.m.) approx.

Whilst every attempt has been made to ensure the accuracy of the floorplan contained here, measurements of doors, windows, rooms and any other items are approximate and no responsibility is taken for any error, omission or mis-statement. This plan is for illustrative purposes only and should be used as such by any prospective purchaser. The services, systems and appliances shown have not been tested and no guarantee as to their operability or efficiency can be given.
Made with Metropix ©2023