

# TO LET

**Parkfield Parade, High Street, TW13 4HJ**  
**£950 Per Calendar Month**

**DBK**  
ESTATE AGENTS

- Available To Rent End of May!
- Open Plan Kitchen/ Reception Area
- Family Bathroom/ WC
- Council Tax Band A
- Feltham Railway Station 0.6 miles
- First Floor Studio Apartment
- Bedroom Area
- Electric Heating & Double Glazed Windows
- Ample Nearby Amenities
- Kempton Park Racecourse 1.3 miles

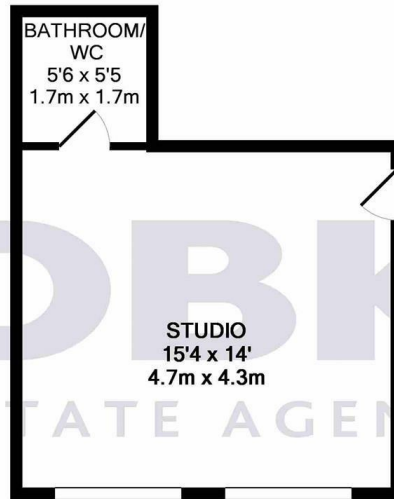

TOTAL APPROX. FLOOR AREA 244 SQ.FT. (22.7 SQ.M.)

Whilst every attempt has been made to ensure the accuracy of the floor plan contained here, measurements of doors, windows, rooms and any other items are approximate and no responsibility is taken for any error, omission, or mis-statement. This plan is for illustrative purposes only and should be used as such by any prospective purchaser. The services, systems and appliances shown have not been tested and no guarantee as to their operability or efficiency can be given  
 Made with Metropix ©2019

## THE PROPERTY

Available To Rent End of May!

A spacious first floor studio apartment ideal for any single person or couple. Accommodation comprises of an open plan kitchen/ reception area and bedroom as well as a chic family bathroom/ WC. Complementary to this is electric heating and double glazed windows.

Conveniently located within an array of nearby well regarded amenities including supermarkets, Cineworld Cinema and local restaurants/ bars. For transport, just minutes walk from Bus links and Feltham Railway Station and for those commuting by vehicle the A30 and A316 can found within a short drive.