



# TO LET

Field Road, Feltham, TW14 0BQ  
£1,650 Per Calendar Month

**DBK**  
ESTATE AGENTS

- Available To Rent End of May!
- Two Bedrooms
- Kitchen
- Secure Entry System
- Storage Cupboards
- Spacious + Well Kept Apartment
- Reception Room
- Family Bathroom/ WC
- Ample Parking
- Reputable Schools Nearby

GROUND FLOOR  
618 sq.ft. (57.4 sq.m.) approx.

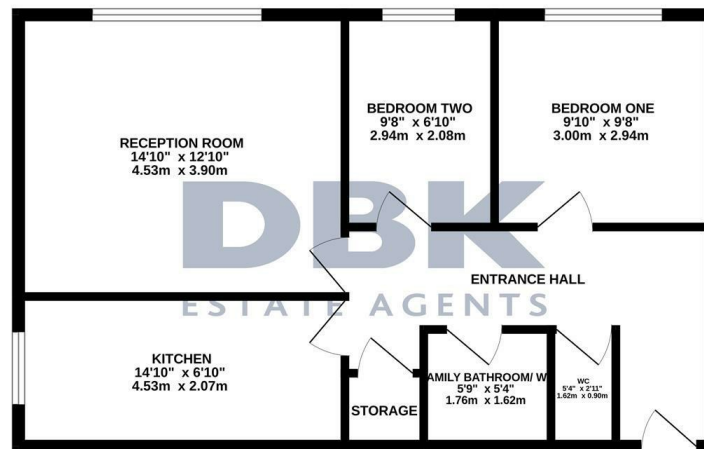

TOTAL FLOOR AREA : 618 sq.ft. (57.4 sq.m.) approx.

Whilst every attempt has been made to ensure the accuracy of the floorplan contained here, measurements of doors, windows, rooms and any other items are approximate and no responsibility is taken for any error, omission or misstatement. This plan is for illustrative purposes only and should be used as such by any prospective purchaser. The services, systems and appliances shown have not been tested and no guarantee is given for their operability or efficiency can be given.  
Made with Metropix ©2023

## THE PROPERTY

Available To Rent End of May!

An airy second floor apartment perfect for any growing family. This purpose built apartment comprises of TWO double bedrooms, a large reception room, kitchen, family bathroom with a separate WC and ample storage within. Supplementary to this is ample parking for residents and visitors, communal gardens, gas central heating, double glazed windows and secure entry system.

Sited just off Hounslow Road with an ample array of local amenities as well as local reputable schools including Sparrow Farm Infant, Nursery and Junior Schools. Conveniently located close to London Heathrow Airport and a wealth of transport links including the A312/ A30/ A4/ M4 and M25 connecting you to The City and neighbouring towns.