

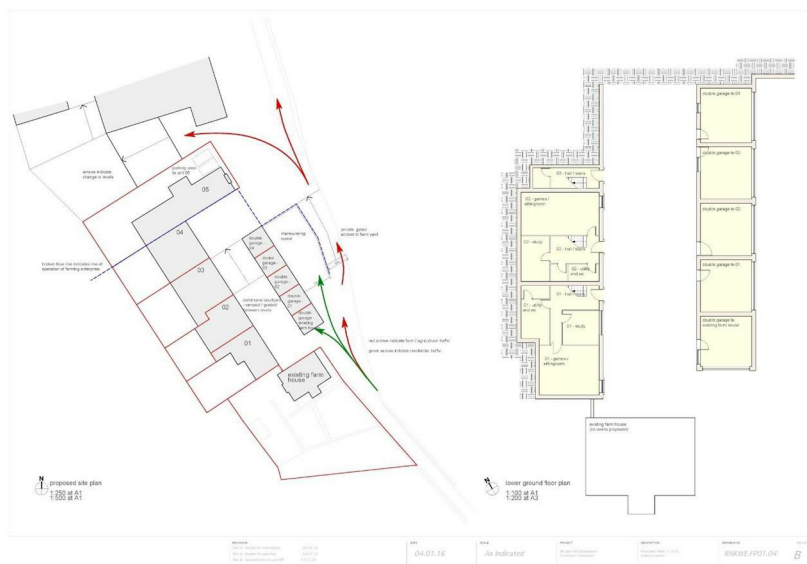

1 SHEPHERDS ROW HELMSHORE ROAD
Holcombe, BL8 4PQ

- substantial end barn conversion
- interior yet to be commenced
- parking & gardens
- 2500 square feet of accommodation
- stunning semi rural elevated setting
- sought after location



THE PROPERTY

Shepherds Row, Holcombe is a substantial end barn conversion, located in this idyllic and elevated rural setting with stunning, and panoramic countryside views. The property extends to around 2500 square feet of accommodation set over 3 floors. The property has the majority of the exterior construction works completed, but internally is and will be sold at a shell or first fix state,. The accommodation can be designed to suit the new owner and is set over 3 floors. The property will have mains water, a shared septic tank, and the intention is to connect a mains gas supply. There will be a management company in place and a monthly service charge will be payable to cover shared liabilities - price to be confirmed.

Freehold Property/Council Tax assumed to be D.

Ramsbottom Office
11 Bolton Street, Ramsbottom, BL0 9HU
Telephone: 01706 822630
Email: ramsbottom@pearsonferrier.co.uk

www.pearsonferrier.co.uk



All statements contained in these particulars are for indicative purposes only and are made without responsibility on the part of Pearson Ferrier and the vendors of this property and are not to be relied on as statements or representations of fact. Potential purchasers should satisfy themselves by inspection or otherwise as to the accuracy of such details contained in these particulars.