



pearson
ferrier®



1 HEATON GROVE
Bury, BL9 9QS
£125,000

1 HEATON GROVE

Property at a glance

A well presented ground floor apartment in this converted manor house located just off Manchester Road approximately one mile from Bury town centre and is within easy reach of local shops and amenities. This Grade II Listed manor house was converted in 1996 creating seven individual apartments with electric heating and double glazed sash windows. The accommodation briefly comprises: communal entrance hall, vestibule, inner hallway (with good sized built in storage), lounge, kitchen, double bedroom and shower room. To the outside there are formal communal gardens and private parking. The property is ideal for a first time buyer or someone looking to downsize.

Leasehold - 125 years from 1995

Ground Rent - £229 per annum

Service Charge - £230 per month

Council Tax band - B

EPC - E





GROUND FLOOR
413 sq.ft. (38.4 sq.m.) approx.

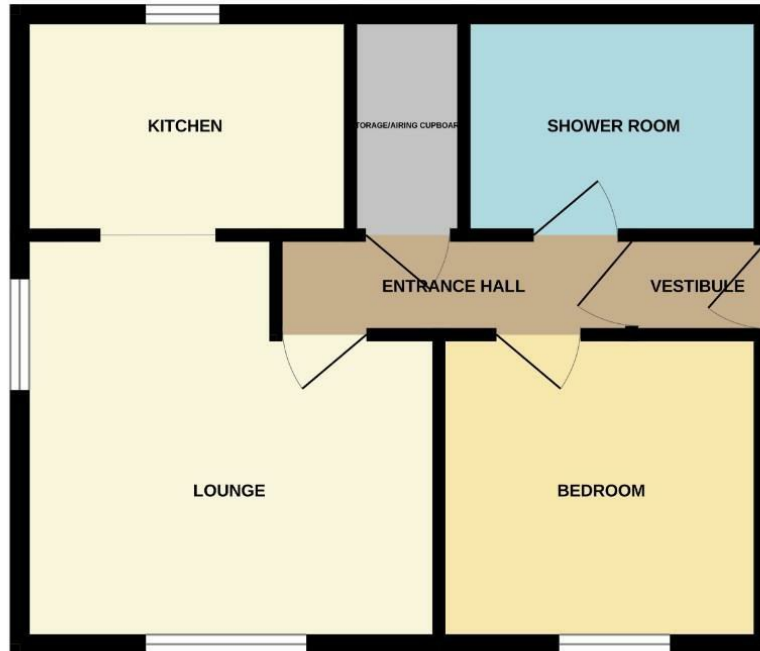

TOTAL FLOOR AREA: 413 sq.ft. (38.4 sq.m.) approx.
Whilst every attempt has been made to ensure the accuracy of the floorplan contained herein, measurements of doors, windows, rooms and any other items are approximate and no responsibility is taken for any error, omission or mis-statement. This plan is for illustrative purposes only and should be used as such by any prospective purchaser. The services, systems and appliances shown have not been tested and no guarantee as to their operability or efficiency can be given.
Made with Metropix v2024

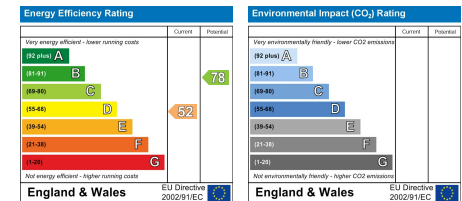

Bury Office
435/7 Walmersley Road, Bury, Lancashire, BL9 5EU
Telephone: 0161 764 4440
Fax: #
Email: bury@pearsonferrier.co.uk

www.pearsonferrier.co.uk



All statements contained in these particulars are for indicative purposes only and are made without responsibility on the part of Pearson Ferrier and the vendors of this property and are not to be relied on as statements or representations of fact. Potential purchasers should satisfy themselves by inspection or otherwise as to the accuracy of such details contained in these particulars.